

ATTACHMENT D: PROJECT PLANS AND PHOTOSIMULATIONS



 NextGen Networks of California, Inc.
 14345 SHELLEY BLVD.
 SUITE 200
 SANTA BARBARA, CA 93108
 PHONE: (805) 384-1982

PROJECT INFORMATION
 HP10305CA-EBN016
 SANTA BARBARA, CA 93108

PERMIT SUBMISSION
 CURRENT ISSUE DATE
 08/19/2010

REV.	DATE	DESCRIPTION

PLANS PREPARED BY:
 HP COMMUNICATIONS INC.
 5120 HURWOOD DR
 GLENDA, CA 91201
 PHONE: (951) 471-1979

PERMITS APPROVED BY:

 NextGen Networks of California, Inc.
 REC.

COMMENTS
 SHEET TITLE

PHOTOSIM
 SHEET NUMBER

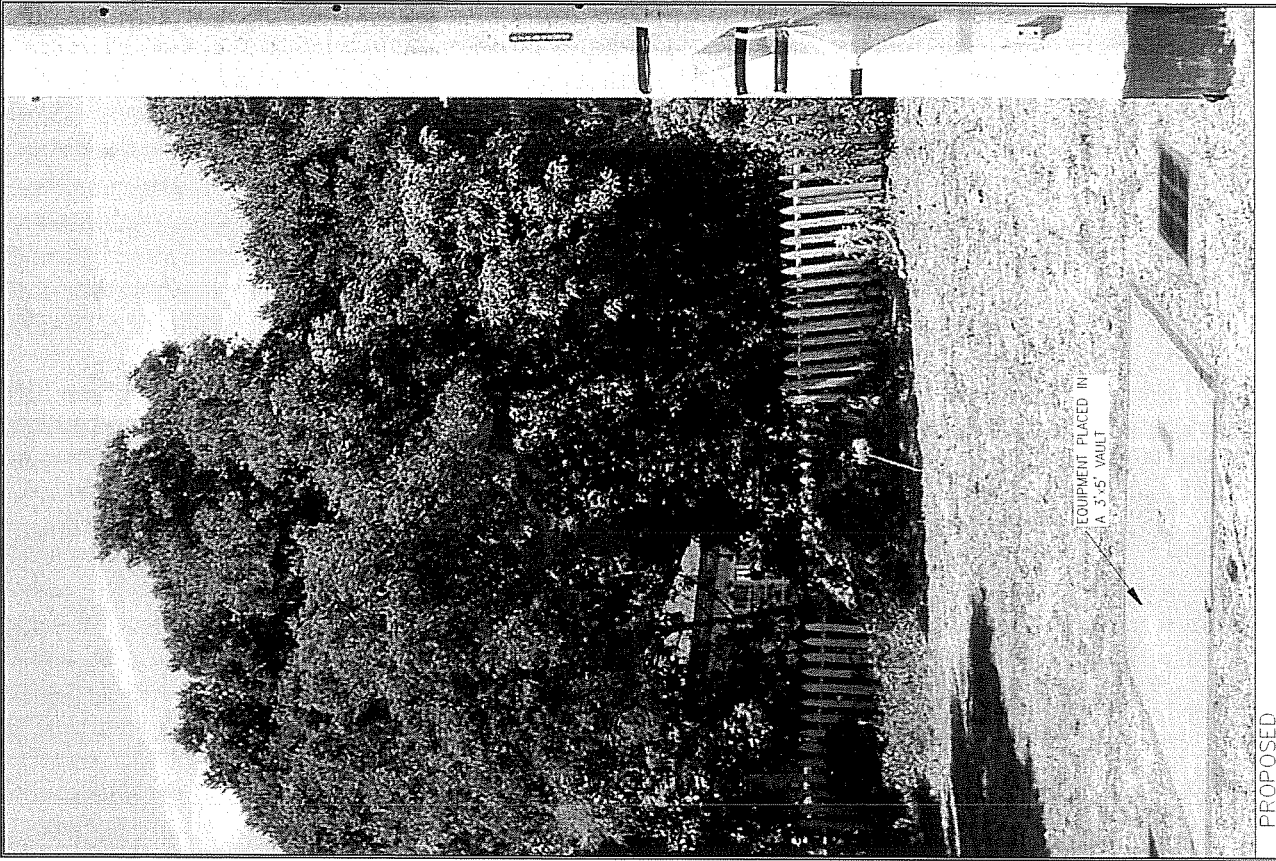
REVISION
1
 1 OF 1



PROPOSED

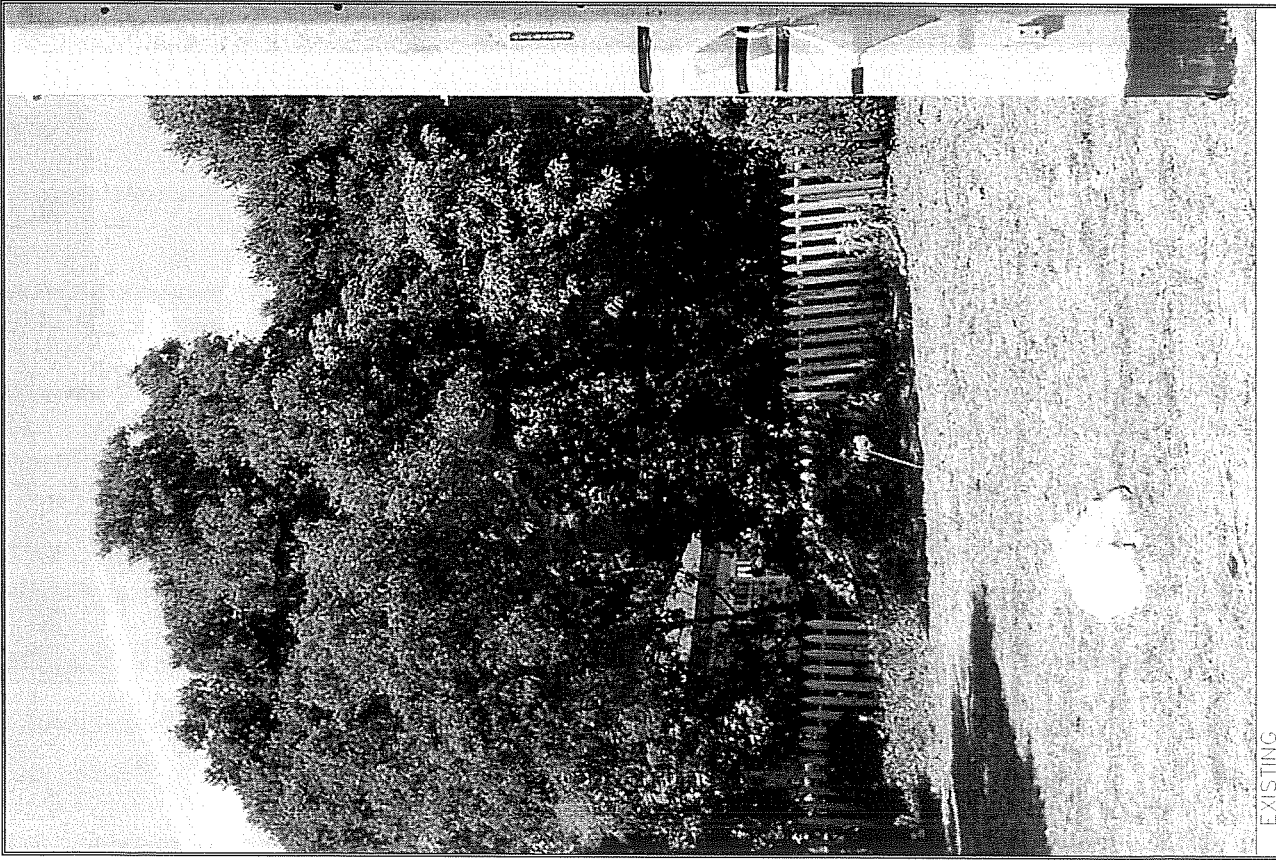

EXISTING



NextG Networks of California, Inc.
MPC1035CA-ESBN018
EAST SANTA BARBARA
SANTA BARBARA, CA 93108

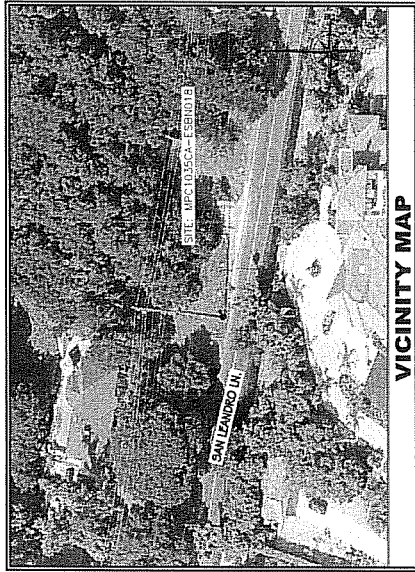

VICINITY MAP



ALL WORK AND MATERIALS SHALL BE PERFORMED AND INSTALLED IN ACCORDANCE WITH THE STANDARD SPECIFICATIONS FOR HIGHWAYS AS ADOPTED BY THE STATE OF CALIFORNIA, LATEST EDITION, WITH THE FOLLOWING AMENDMENTS:
 1. STATE STANDARD SPECIFICATIONS FOR HIGHWAYS, SECTION 101-1.1, PART 1, ITEM 1.1.1, SPECIFICATION FOR CONCRETE CURBS AND GUTTERS SHALL BE AMENDED TO READ: "CONCRETE SHALL BE 28-DAY STRENGTH CLASS 4000 PSI WITH A MINIMUM OF 10% AIR ENTRAINMENT."
 2. STATE STANDARD SPECIFICATIONS FOR HIGHWAYS, SECTION 101-1.1, PART 1, ITEM 1.1.1, SPECIFICATION FOR CONCRETE CURBS AND GUTTERS SHALL BE AMENDED TO READ: "CONCRETE SHALL BE 28-DAY STRENGTH CLASS 4000 PSI WITH A MINIMUM OF 10% AIR ENTRAINMENT."
 3. STATE STANDARD SPECIFICATIONS FOR HIGHWAYS, SECTION 101-1.1, PART 1, ITEM 1.1.1, SPECIFICATION FOR CONCRETE CURBS AND GUTTERS SHALL BE AMENDED TO READ: "CONCRETE SHALL BE 28-DAY STRENGTH CLASS 4000 PSI WITH A MINIMUM OF 10% AIR ENTRAINMENT."
 4. STATE STANDARD SPECIFICATIONS FOR HIGHWAYS, SECTION 101-1.1, PART 1, ITEM 1.1.1, SPECIFICATION FOR CONCRETE CURBS AND GUTTERS SHALL BE AMENDED TO READ: "CONCRETE SHALL BE 28-DAY STRENGTH CLASS 4000 PSI WITH A MINIMUM OF 10% AIR ENTRAINMENT."
 5. STATE STANDARD SPECIFICATIONS FOR HIGHWAYS, SECTION 101-1.1, PART 1, ITEM 1.1.1, SPECIFICATION FOR CONCRETE CURBS AND GUTTERS SHALL BE AMENDED TO READ: "CONCRETE SHALL BE 28-DAY STRENGTH CLASS 4000 PSI WITH A MINIMUM OF 10% AIR ENTRAINMENT."
 6. STATE STANDARD SPECIFICATIONS FOR HIGHWAYS, SECTION 101-1.1, PART 1, ITEM 1.1.1, SPECIFICATION FOR CONCRETE CURBS AND GUTTERS SHALL BE AMENDED TO READ: "CONCRETE SHALL BE 28-DAY STRENGTH CLASS 4000 PSI WITH A MINIMUM OF 10% AIR ENTRAINMENT."
 7. STATE STANDARD SPECIFICATIONS FOR HIGHWAYS, SECTION 101-1.1, PART 1, ITEM 1.1.1, SPECIFICATION FOR CONCRETE CURBS AND GUTTERS SHALL BE AMENDED TO READ: "CONCRETE SHALL BE 28-DAY STRENGTH CLASS 4000 PSI WITH A MINIMUM OF 10% AIR ENTRAINMENT."
 8. STATE STANDARD SPECIFICATIONS FOR HIGHWAYS, SECTION 101-1.1, PART 1, ITEM 1.1.1, SPECIFICATION FOR CONCRETE CURBS AND GUTTERS SHALL BE AMENDED TO READ: "CONCRETE SHALL BE 28-DAY STRENGTH CLASS 4000 PSI WITH A MINIMUM OF 10% AIR ENTRAINMENT."
 9. STATE STANDARD SPECIFICATIONS FOR HIGHWAYS, SECTION 101-1.1, PART 1, ITEM 1.1.1, SPECIFICATION FOR CONCRETE CURBS AND GUTTERS SHALL BE AMENDED TO READ: "CONCRETE SHALL BE 28-DAY STRENGTH CLASS 4000 PSI WITH A MINIMUM OF 10% AIR ENTRAINMENT."
 10. STATE STANDARD SPECIFICATIONS FOR HIGHWAYS, SECTION 101-1.1, PART 1, ITEM 1.1.1, SPECIFICATION FOR CONCRETE CURBS AND GUTTERS SHALL BE AMENDED TO READ: "CONCRETE SHALL BE 28-DAY STRENGTH CLASS 4000 PSI WITH A MINIMUM OF 10% AIR ENTRAINMENT."

CODE COMPLIANCE

PROPERTY INFORMATION

OWNER: NEXTG NETWORKS OF CALIFORNIA, INC.
 PROJECT: EAST SANTA BARBARA
 ADDRESS: 184 SAN LEONARDO LN
 CITY: SANTA BARBARA, CA 93109
 COUNTY: SANTA BARBARA
 SHEET NUMBER: 31-07
 SHEET TYPE: STEEL UTILITY POLE
 SHEET DATE: 08/20/2010
 SHEET NUMBER: 31-07

ANNUAL TYPE: 482366-1710-7-10-11
 ANNUUM FOR ARENA: N/A
 POWER TO POLE: SECONDARY
 POLE ACCESS: ON ROAD
 POLE OWNER: N/A
 POLE LOCATION & DESCRIPTION: N/A

PROJECT SUMMARY

PROJECT DESCRIPTION

THE PROJECT SCOPE OF THE INSTALLATION AND REPAIRS OF UTILITY AND ASSOCIATED EQUIPMENT ELEMENTS FOR THE PROJECT IS AS SHOWN ON THIS SHEET. THE PROJECT SCOPE IS SUBJECT TO THE PROJECT SCOPE SHEET WHICH WILL BE PROVIDED TO THE CONTRACTOR. THE PROJECT SCOPE IS SUBJECT TO THE PROJECT SCOPE SHEET WHICH WILL BE PROVIDED TO THE CONTRACTOR.

PROJECT SCOPE

INSTALL / REPAIR NEW PIPES OR EXISTING PIPES, METAL BRACKETS, CONDUIT OR PIPES, AND ALL ASSOCIATED BRACKETS, FITTINGS, AND ACCESSORIES. THE PROJECT SCOPE IS SUBJECT TO THE PROJECT SCOPE SHEET WHICH WILL BE PROVIDED TO THE CONTRACTOR.

GENERAL CONTRACTOR NOTES

DO NOT SCALE DRAWINGS
 CONTRACTOR SHALL VERIFY ALL DIMENSIONS AND SURVEY INFORMATION HAS BEEN OBTAINED FROM THE ARCHITECT'S RECORD DRAWINGS AND SHALL VERIFY THE ARCHITECT'S RECORD DRAWINGS ARE CORRECT AND COMPLETE. THE CONTRACTOR SHALL BE RESPONSIBLE FOR OBTAINING ALL NECESSARY PERMITS AND APPROVALS BEFORE PROCEEDING WITH THE WORK. THE CONTRACTOR SHALL BE RESPONSIBLE FOR OBTAINING ALL NECESSARY PERMITS AND APPROVALS BEFORE PROCEEDING WITH THE WORK.

SHEET INDEX

SHEET	DESCRIPTION	REV
1	THIS SHEET	0
2	UTILITY INDEX / REPAIRER POLE EQUIPMENT PROFILES	0
3	UTILITY INFORMATION AND SITE ORIENTATION	0
4	TERMINALS	0
5	TERMINALS	0

GENERAL CONTRACTOR NOTES

DO NOT SCALE DRAWINGS
 CONTRACTOR SHALL VERIFY ALL DIMENSIONS AND SURVEY INFORMATION HAS BEEN OBTAINED FROM THE ARCHITECT'S RECORD DRAWINGS AND SHALL VERIFY THE ARCHITECT'S RECORD DRAWINGS ARE CORRECT AND COMPLETE. THE CONTRACTOR SHALL BE RESPONSIBLE FOR OBTAINING ALL NECESSARY PERMITS AND APPROVALS BEFORE PROCEEDING WITH THE WORK. THE CONTRACTOR SHALL BE RESPONSIBLE FOR OBTAINING ALL NECESSARY PERMITS AND APPROVALS BEFORE PROCEEDING WITH THE WORK.

 NextG Networks of California, Inc. 5100 HIGHWAY 101 SUITE 100 SANTA BARBARA, CA 93109 PHONE: (805) 534-1190	PROJECT INFORMATION MPC1035CA-ESBN018 EAST SANTA BARBARA, CA 93109	CURRENT ISSUE DATE 08/20/2010	PERMIT SUBMISSION 08/20/2010	REV. DATE / DESCRIPTION 08/20/2010 / 08/20/2010	PLANS PREPARED BY HP COMMUNICATIONS INC. 5100 HIGHWAY 101 SUITE 100 SANTA BARBARA, CA 93109 PHONE: (805) 534-1190	PLANS APPROVED BY NextG Networks of California, Inc.	COMMENTS	SHEET TITLE TITLE SHEET	SHEET NUMBER 1	SHEET TOTAL 1 OF 5
---	--	----------------------------------	---------------------------------	--	--	---	----------	-----------------------------------	--------------------------	------------------------------





NextG Networks of California, Inc.
1000 W. BROADWAY
SUITE 1400
SANTA ANA, CA 92704
PHONE: (949) 344-1100

PROJECT INFORMATION

MPC1053CA ESR1018
SAN LEANDRO LN
SANTA BARBARA, CA 93108

08/20/2010

PERMIT SUBMISSION

REV. DATE DESCRIPTION

REV.	DATE	DESCRIPTION

PLANS PREPARED BY:

HP COMMUNICATIONS INC.

5200 WASHINGTON DR.
SUITE 100
RANCHO COSTA MESA, CA 92626

PLANS APPROVED BY:

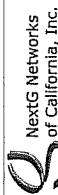

REF: _____

COMMENTS:

SHEET TITLE

UTILITY INFORMATION
AND
SITE ORIENTATION

SHEET NUMBER

3

3 OF 5

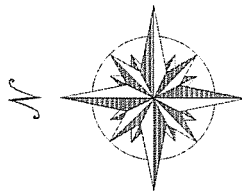
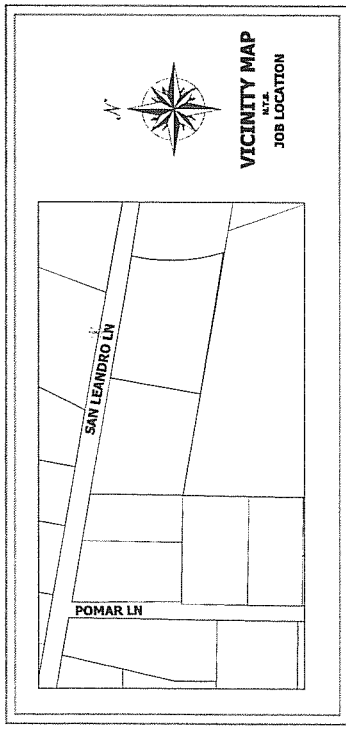

NOT TO SCALE

EXISTING POLE
POLE # 1996352E
NODE ESR1B
APN # 007-300-016
ADDRESS: 1684 SAN LEANDRO LN

LARGE ROCKS

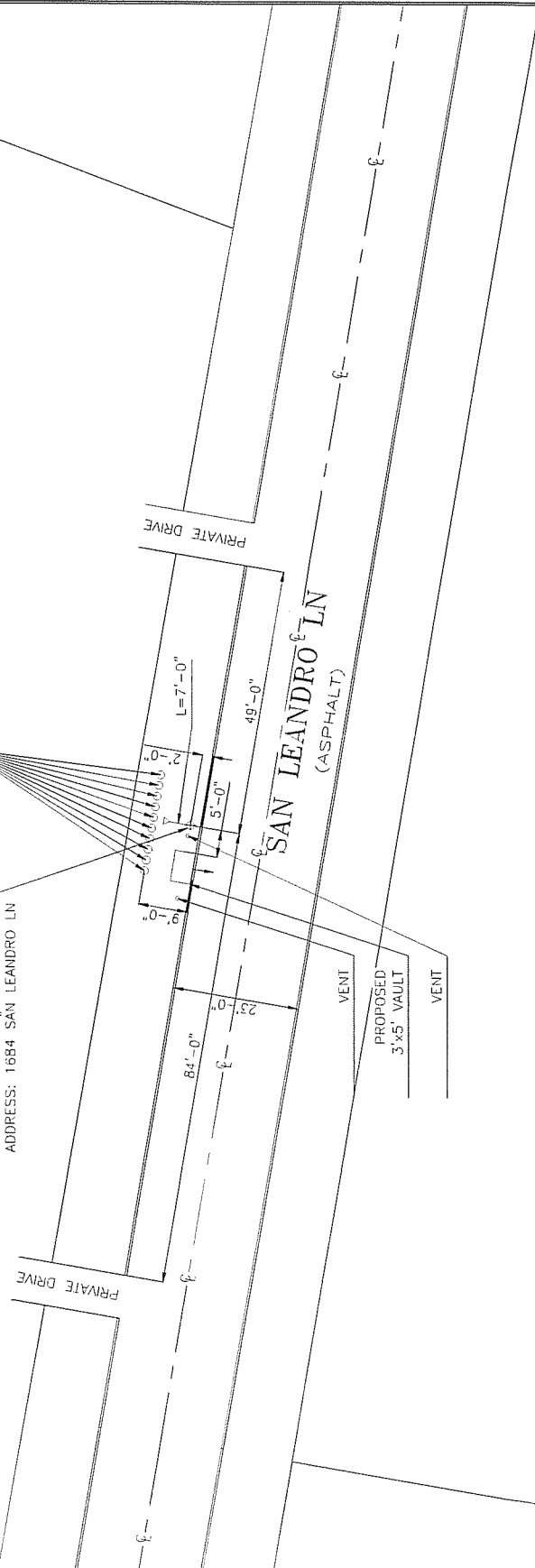

SYM.	DESCRIPTION	SYMBOL	DESCRIPTION	UNIT	DESCRIPTION	SYMBOL	DESCRIPTION	SYMBOL	DESCRIPTION	SYMBOL	DESCRIPTION
□	PROPOSED VAULT	□	PROPERTY LINE		SLC	STANDARD CONDUIT	○	POLE		SS	STANDARD SEWER
○	UTILITY POLE	○	CONCRETE NETWORK		SS	STANDARD SEWER	○	POLE		SS	STANDARD SEWER
○	VENT/EGH	○	PROPERTY LINE		SS	STANDARD SEWER	○	POLE		SS	STANDARD SEWER

DATE	08/20/2010	COUNTY OF SANTA BARBARA	SCALE	N.T.S.
LOCATION	SAN LEANDRO LN			
TASK #	1			
PROJECT #				
ADDRESS #	1684 SAN LEANDRO LN			

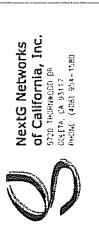

NextG Networks
of California, Inc.
1300 BROADWAY, SUITE 100
SANTA ANA, CA 92701
PHONE: (408) 974-1300

PROJECT INFORMATION

HFC1303CA-EBRD010
NEXT GENERATION
SANTA ANA, CA 92701

08/20/2010

PERMIT SUBMISSION

REV. DATE DESCRIPTION

HP COMMUNICATIONS
INC.

5175 WASHINGTON ST
SUITE 100
SANTA ANA, CA 92705
PHONE: (714) 971-9799

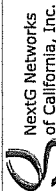

NextG Networks
of California, Inc.

COMMENTS:

SHEET TITLE

TYPICALS PAGE 2

SHEET NUMBER

5

5 OF 5

