

16AGP-00000-00031

LEGAL DESCRIPTION:

PARCEL A of Parcel Map 13330 in the County of Santa Barbara, State of California, as shown on map filed in Book 32, Pages 1, 2 and 3 of Parcel Maps in the Office of the County Recorder of Santa Barbara County.

APN 155-180-73, 155-180-74, 155-180-75

APPROVED AS TO FORM
AND SURVEY CONTENT

A Jevremovic
ALEKSANDAR JEVREMOVIC
COUNTY SURVEYOR
LICENSE EXP. *12/31/2017*

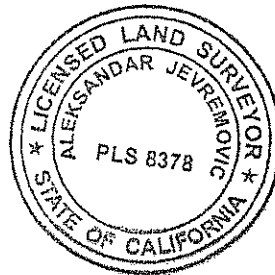

11/15/2016

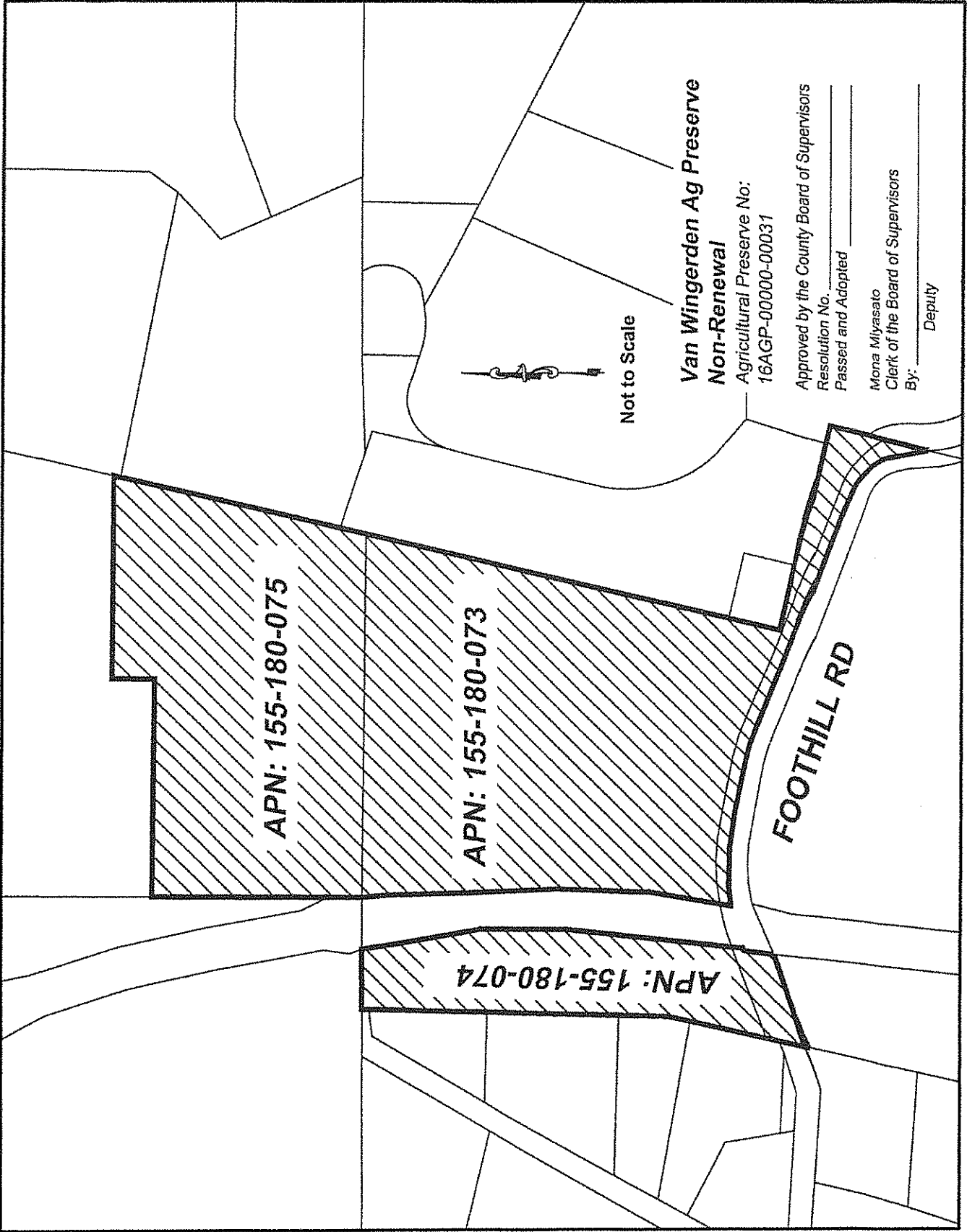

APN: 155-180-075

APN: 155-180-073

APN: 155-180-074

FOOTHILL RD

Not to Scale

**Van Wingerden Ag Preserve
Non-Renewal**
Agricultural Preserve No:
16AGP-00000-00031

Approved by the County Board of Supervisors
Resolution No. _____
Passed and Adopted _____

Mona Miyasato
Clerk of the Board of Supervisors
By: _____
Deputy