

County of Santa Barbara
Public Works Department

Office of the County Surveyor

123 E. Anapamu Street
Santa Barbara, California 93101
805/568-3020 FAX 805/568-3318

Aleksandar Jevremovic, County Surveyor



TRANSMITTAL

TO: Shannon Reese, Planner, P&D

DATE: 8/22/2022

ADDRESS/DEPARTMENT: Planning and Development

FROM: Aleksandar Jevremovic, County Surveyor

PHONE: 83012

SUBJECT: 21AGP-00000-00005
Krankl Agricultural Preserve Replacement
Portions of APN:133-100-062 & APN:133-100-078

QTY	DESCRIPTION
1	Approved Legal Description
1	Exhibit map

ACTION:

- As Requested
- For Your Use
- Approved as Noted
- For Review and Comment

REMARKS:

AGRICULTURAL PRESERVE

21AGP-00000-00005

LEGAL DESCRIPTION

Portions of APN:133-100-062 & APN:133-100-078

Lot One of Lot Line Adjustment No. 21LLA-00000-00005 recorded April 26, 2022 as Instrument No. 2022-0020442 Official Records in the County of Santa Barbara, State of California.



8/22/2022

APPROVED AS TO FORM
AND SURVEY CONTENT

AJevremovic

ALEKSANDAR JEVREMOVIC, PLS 8378
COUNTY SURVEYOR
LICENSE EXP. 12/31/2023

*Krankl Replacement Contract
Agricultural Preserve
21AGP-00000-00005*

*Approved by the County Board of
Supervisors
Resolution No. _____
Passed and Adopted _____*

*Mona Miyasato
Clerk of the Board of Supervisors
By: _____
Deputy*

**Lot 1 of Lot Line Adjustment
20LLA-00000-00004
Instrument 2022-0020442**

**Portion of APNs: 133-100-062 &
133-100-078**

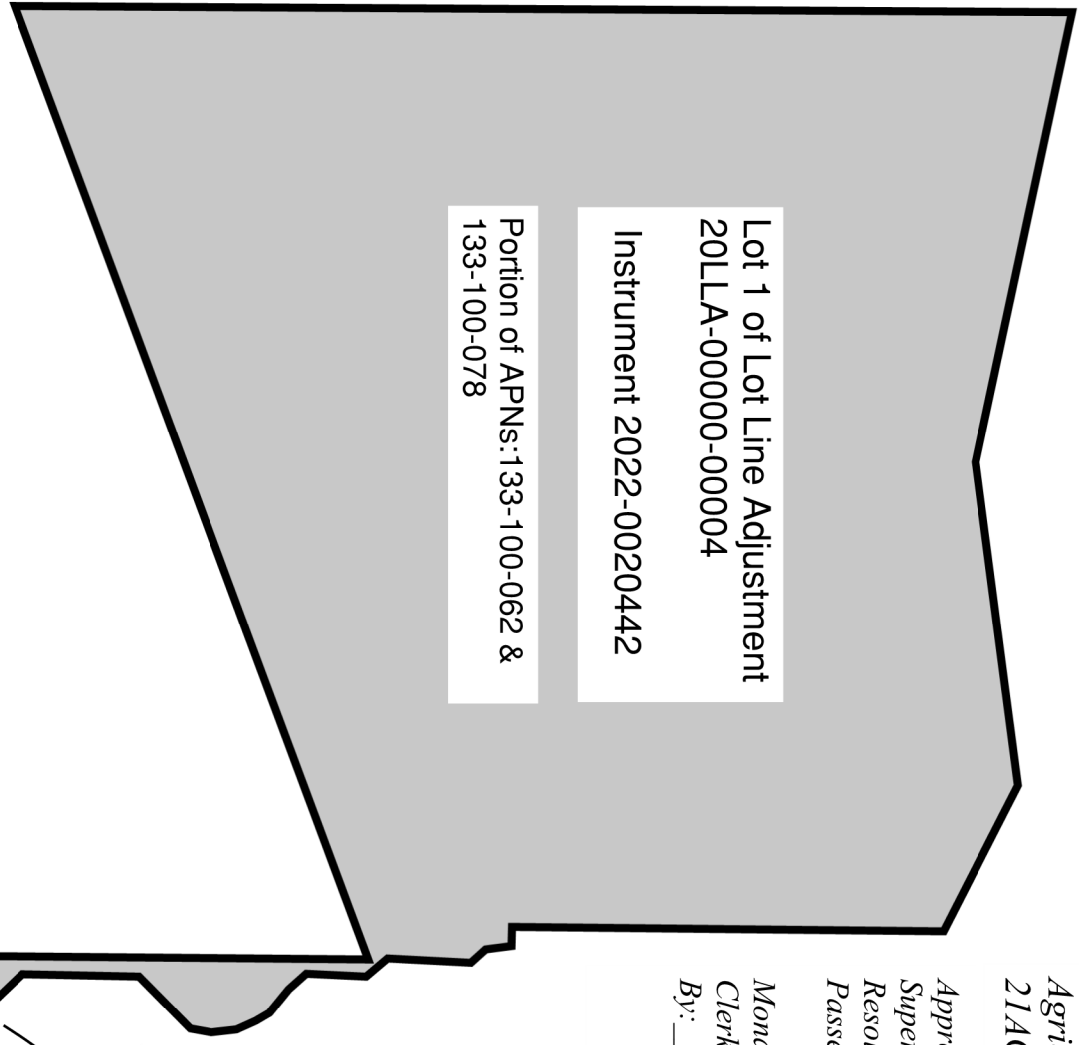

Alisos Canyon Road



Not to Scale