

LEGEND

EVENT CENTER

- A 1 Entry Monument with Landscaping
- A 2 Stormwater Detention Basin
- A 3 Storage & Maintenance Building
- A 4 Ballfield No. 1 with Sports Lighting
- A 5 Scorekeeper & Announcer's Booth
- A 6 Built-In Stadium Seating (500 seats)
- A 7 Batting Cages
- A 8 Bullpen
- A 9 Digital Scoreboard
- A 10 Parking Lot A (114 spaces plus drop-off)
- A 11 Parking Lot B (90 spaces plus drop-off)
- A 12 Parking Lot C (10 pull-through RV spaces)
- A 13 Central Plaza
- A 14 Concessions Promenade
- A 15 Restrooms (12 stalls)
- A 16 Wall of Fame
- A 17 Shade Structure

BALLFIELD No. 2

- B 1 Ballfield No. 2
- B 2 Scorekeeper & Announcer's Booth
- B 3 Concessions Building
- B 4 Bleachers
- B 5 Storage & Maintenance Building
- B 6 Digital Scoreboard
- B 7 Parking Lot D (30 spaces)

SOCCER COMPLEX

- C 1 Flexible Lighted Grass Field Area (7 acres)
- C 2 Storage Building
- C 3 Ball Containment Fence
- C 4 Pedestrian Drop-Off
- C 5 Fence at YMCA Perimeter
- C 6 Loop Road with Parking (69 spaces)
- C 7 Parking Lot E (88 spaces)
- C 8 Restroom
- C 9 Group Picnic Area
- C 10 Playground
- C 11 Shade Structure
- C 12 Soccer Plaza
- C 13 Multi-Use Path
- C 14 Central Pedestrian Promenade

CHAMPIONSHIP FIELD

- D 1 Synthetic or Natural Grass Field
- D 2 Perimeter Fence
- D 3 Terraced Spectator Seating
- D 4 Parks Maintenance Yard Expansion

POTTER GROVE

- E 1 Grass Meadow
- E 2 Pedestrian Path
- E 3 Restroom & Pet Spa (existing)
- E 4 Playground (existing)
- E 5 Gazebo & Pond (existing)
- E 6 Pump Station (existing)
- E 7 Tank for Reclaimed Water
- E 8 Potter Grove Gateway Arch

NORTHEAST PARKING

- F 1 Parking Lot F (84 spaces)
- F 2 Stormwater Detention Basin
- F 3 Multi-Use Path (on existing park road)
- F 4 Pedestrian Connection to Residential
- F 5 Traffic Circle

NORTHERN CIRCULATION

- G 1 Widen Existing Park Road for 2-Way Traffic
- G 2 Convert Existing Angled Parking to 90° (67 spaces)
- G 3 Parking Lot G (39 spaces)
- G 4 Traffic Circle

AIRPORT ROAD ENTRY

- H 1 Roundabout with Directional Sign & Landscaping
- H 2 Entry Monument with Landscaping
- H 3 Connection to Santa Maria Valley Bikeway
- H 4 Drainage Culvert (existing)
- H 5 Reconfigured YMCA Parking Lot & Entry

PERIMETER ROAD

- I 1 New Road Connector with Sidewalk
- I 2 Future Connection to YMCA Expansion Area
- I 3 Drainage Ditch (existing)

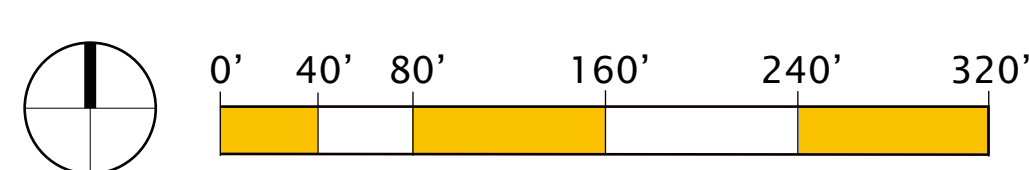

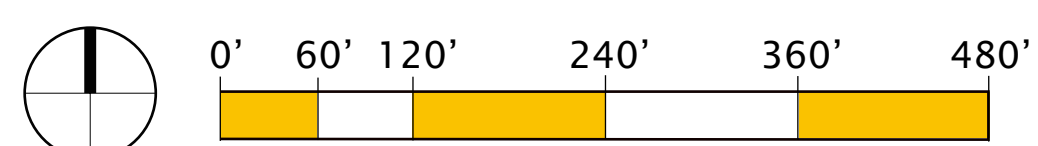

WALLER PARK MASTER PLAN | OVERALL PARK CONTEXT



Event Center



Central Plaza



Soccer Plaza



Potter Grove Entry Gateway

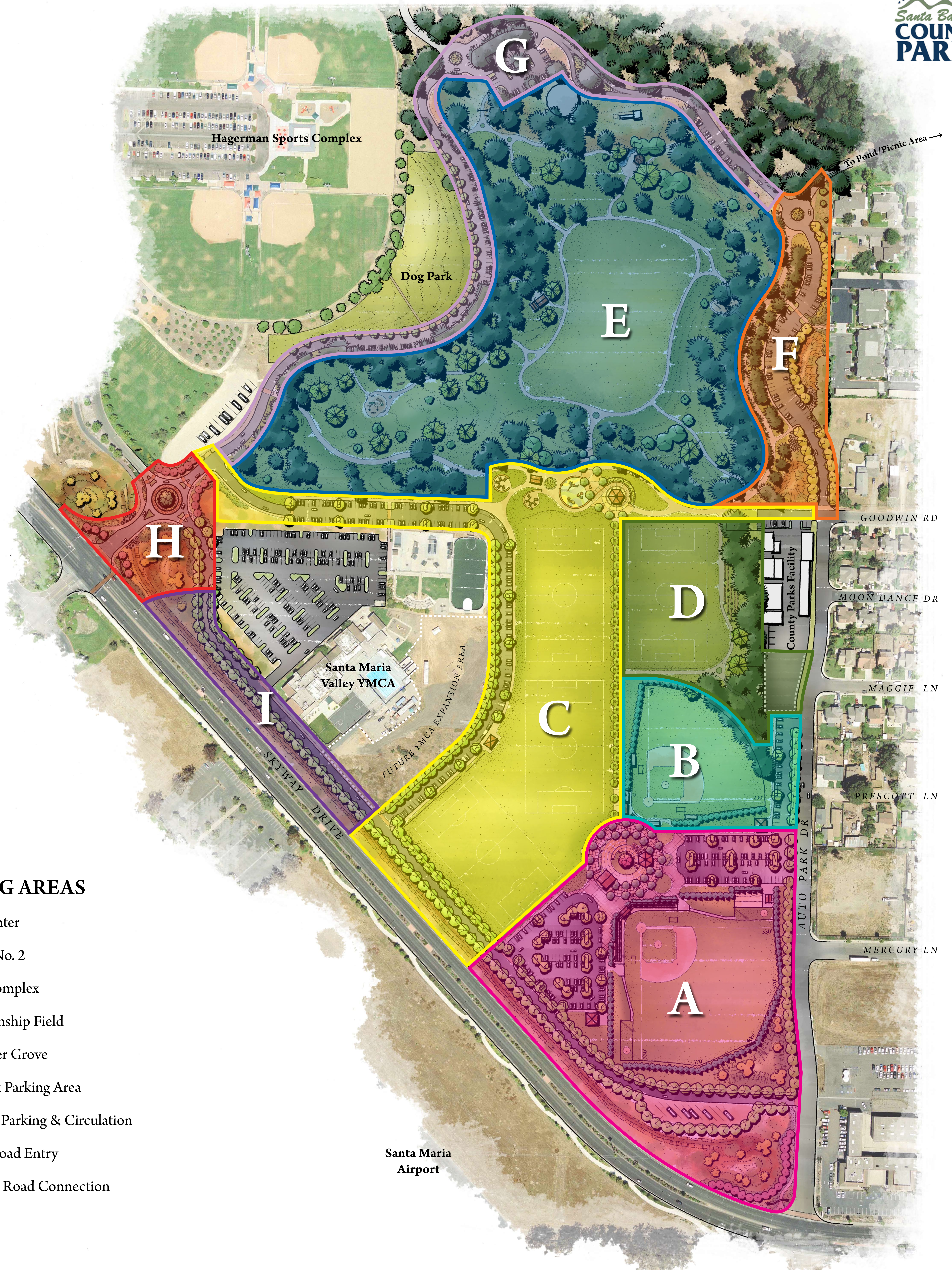

PLANNING AREAS

- A Event Center
- B Ballfield No. 2
- C Soccer Complex
- D Championship Field
- E Don Potter Grove
- F Northeast Parking Area
- G Northern Parking & Circulation
- H Airport Road Entry
- I Perimeter Road Connection

