

AGRICULTURAL PRESERVE  
20AGP-00000-00001

**LEGAL DESCRIPTION**

Real property in the unincorporated area of the County of Santa Barbara, State of California, described as follows:

LOT THREE OF THE ALISAL RANCHO, ACCORDING TO THE MAP THEREOF RECORDED IN BOOK 9, PAGES 63 TO 72, INCLUSIVE, OF MAPS, IN THE OFFICE OF THE COUNTY RECORDER, SANTA BARBARA COUNTY, CALIFORNIA.

EXCEPTING THEREFROM THE PORTION THEREOF DESCRIBED IN THE DEED TO E. S. PILLSBURY, RECORDED JULY 11, 1940 IN BOOK 496, PAGE 293 OF OFFICIAL RECORDS.

A SURVEY OF SAID EXCEPTED PORTION WAS FILED MAY 21, 1940 IN BOOK 25, PAGE 160 OF MAPS IN THE OFFICE OF THE COUNTY RECORDER.

ALSO EXCEPTING THEREFROM THE PORTION THEREOF DESCRIBED IN THE DEED TO ALISAL GOLF COURSE, A CORPORATION, RECORDED JANUARY 29, 1960 AS INSTRUMENT NO. 3143 IN BOOK 1710, PAGE 244 OF OFFICIAL RECORDS.

ALSO EXCEPTING THEREFROM THE PORTION THEREOF DESCRIBED IN THE DEED TO ALISAL GUEST RANCH, A CORPORATION, RECORDED MARCH 1, 1960 AS INSTRUMENT NO. 6699 IN BOOK 1719, PAGE 411 OF OFFICIAL RECORDS.

ALSO EXCEPTING THEREFROM THE PORTIONS THEREOF DESCRIBED IN THE DEEDS TO SOLVANG MUNICIPAL IMPROVEMENT DISTRICT RECORDED MARCH 7, 1962 AS INSTRUMENT NO. 8804 IN BOOK 1908, PAGE 165 OF OFFICIAL RECORDS, AND JANUARY 27, 1965 AS INSTRUMENT NO. 2900 AND 2901 IN BOOK 2089, PAGES 186 AND 189 OF OFFICIAL RECORDS, AND OCTOBER 28, 1974 AS INSTRUMENT NO. 38539 IN BOOK 2538, PAGE 1393 OF OFFICIAL RECORDS, AND JUNE 15, 1981 AS INSTRUMENT NO. 81-24112.

ALSO EXCEPTING THEREFROM THAT PORTION THEREOF LYING WITHIN THE LINES OF TRACT 10,398 AS SHOWN IN MAP FILE IN BOOK 74, PAGES 57 – 62, INCLUSIVE, OF MAPS IN THE OFFICE OF COUNTY RECORDER OF SAID COUNTY.

ALSO EXCEPTING THEREFROM THAT PORTION GRANTED TO THE CITY OF SOLVANG, A MUNICIPAL CORPORATION AND CHARTER CITY IN THE COUNTY OF SANTA BARBARA, STATE OF CALIFORNIA, ITS SUCCESSORS AND ASSIGNS, DESCRIBED IN GRANT DEED RECORDED AUGUST 30, 2019 AS INSTRUMENT NO. 19-37890 OF OFFICIAL RECORDS.

APN: 137-270-036, 137-280-019, 137-280-020, 137-280-021, 137-300-005, 137-300-009, 137-300-010

APPROVED AS TO FORM  
AND SURVEY CONTENT

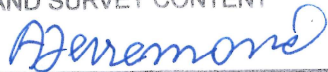
  
**ALEKSANDAR JEVREMOVIC**  
COUNTY SURVEYOR  
LICENSE EXP. \_\_\_\_\_

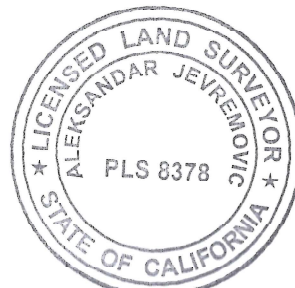

2/24/2020

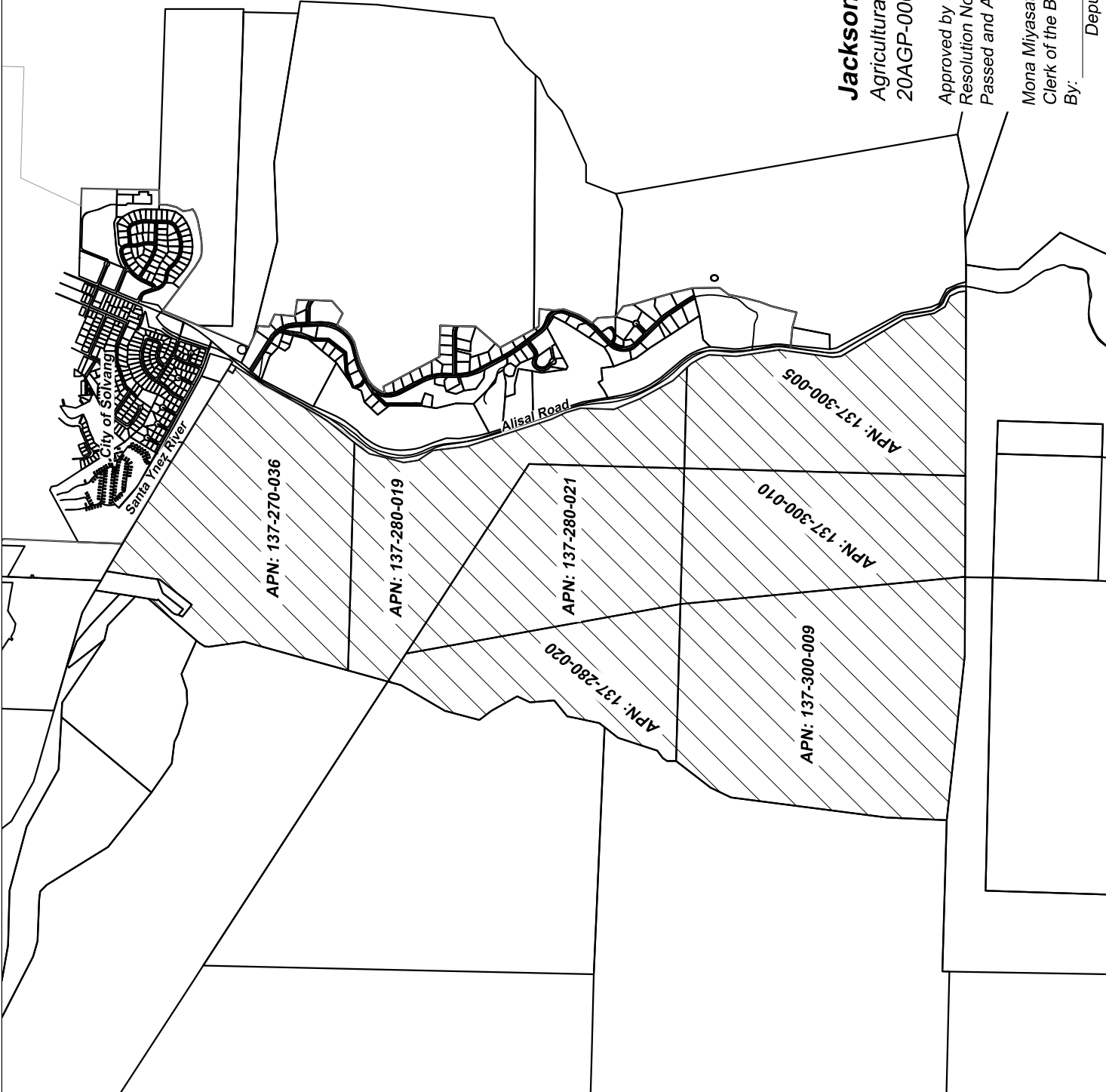

Not to Scale

### Jackson Replacement Contract

Agricultural Preserve No:  
20AGP-00000-00001

Approved by the County Board of Supervisors  
Resolution No. \_\_\_\_\_  
Passed and Adopted \_\_\_\_\_

Mona Miyasato  
Clerk of the Board of Supervisors  
By: \_\_\_\_\_ Deputy