

LEGEND

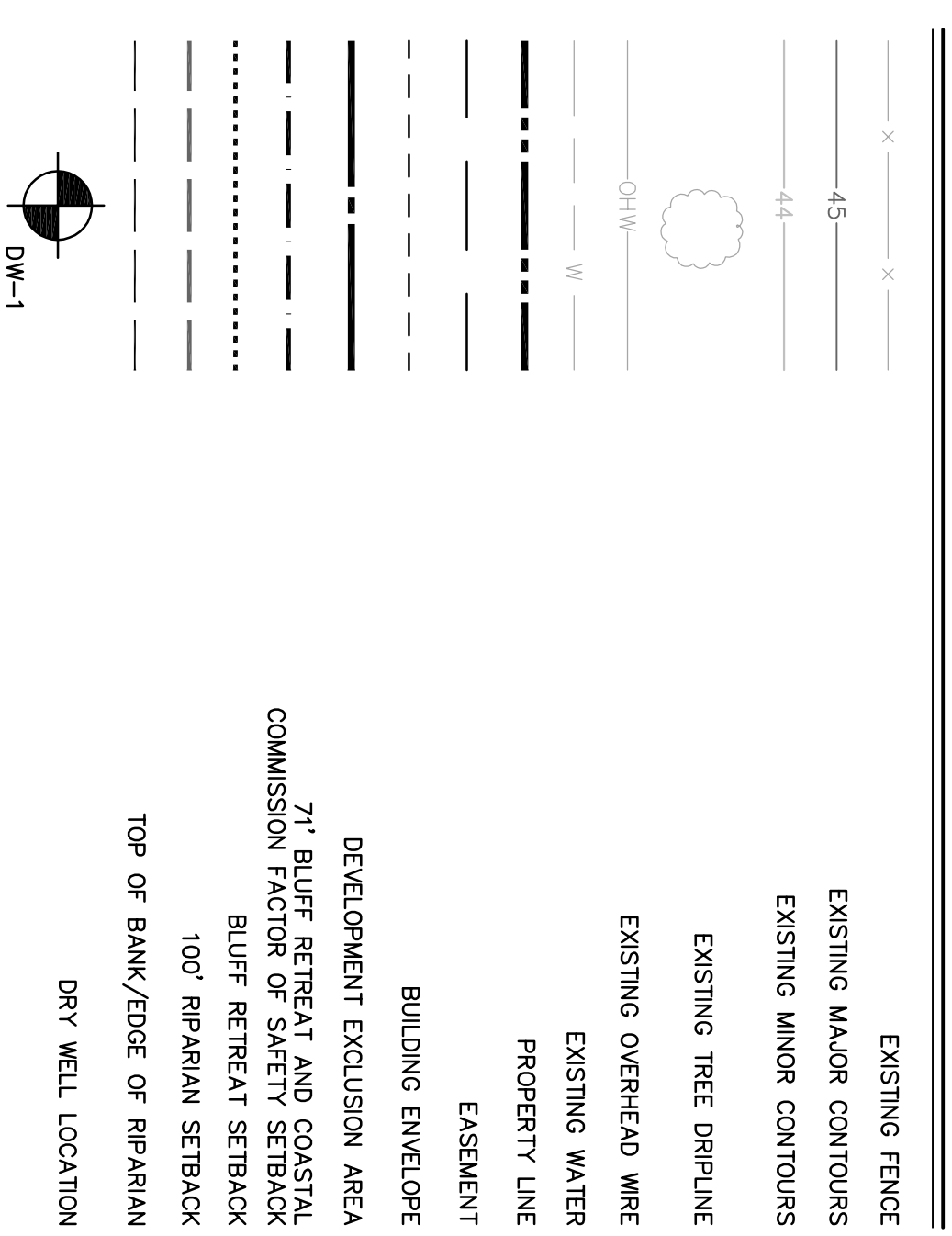

SURVEYOR'S STATEMENT

THIS MAP WAS PREPARED BY ME, OR UNDER MY DIRECT SUPERVISION.

KENNETH A. WILSON
REGISTERED PROFESSIONAL SURVEYOR
NO. 20371

SURVEYOR'S NOTES

1. **BOUNDARY**
THE BOUNDARY INFORMATION SHOWN HEREON WAS OBTAINED FROM RECORD DATA, AND IS IN ACCORDANCE WITH THE BOUNDARY SURVEYING ACT AND THE PROFESSIONAL SURVEYING ACT IN ORDER TO OBTAIN THE TOPOGRAPHIC AND PLANNING INFORMATION TO THE COMPILED BOUNDARY. THIS MAP DOES NOT REPRESENT A BOUNDARY ESTABLISHMENT SURVEY.
2. **MAJOR PHOTOGRAPHIC**
TOPOGRAPHIC MAPPING WAS COMPLETED AT A SCALE OF 1"=400' WITH A FOOT CONTOUR INTERVAL. PHOTOGRAPHIC MAPPING WAS CONDUCTED BY ARROWHEAD MAPPING CORPORATION, THE PHOTOGRAPHY HAS BEEN CORRECTED FOR DISTORTION. PHOTOGRAPHIC MAPPING IS SUPPLEMENTED BY DATA COLLECTED IN A FIELD SURVEY USING CONVENTIONAL SURVEYING EQUIPMENT AND PROCEDURES IN DECEMBER, 2010.
3. **BASE OF BEAKINGS**
THE BASIS OF BEAKINGS FOR THIS SURVEY IS SOUTH 88°51'18" EAST FOR A PORTION OF THE NORTHERLY BOUNDARY LINE OF PARCEL "A" AS SHOWN ON PARCEL MAP RECORDED IN BOOK 26008, PAGE 25, COUNTY OF SANTA BARBARA, CALIFORNIA. THE COUNTY SECTOR IN THE COUNTY OF SANTA BARBARA, CALIFORNIA.
4. **VERTICAL DATUM**
THE ELEVATIONS SHOWN HEREON ARE NUMBERS, BASED UPON TIES TO STATION 05-01, BEING A BRASS DISK SET IN MONUMENT WELLS, MARKED "HORN 05-01 1990", REFERENCE NATIONAL GEODETIC SURVEY DATA SHEET "PD 7805-4" FOR STATION LOCATION.
5. **SITE INFORMATION**
APN: 005-260-018, COUNTY OF SANTA BARBARA.
6. **TITLE REPORT**
THIS MAP HAS BEEN PREPARED IN CONSULTATION WITH THE PREPARER. THE REPORT NUMBER 680820 ISSUED BY PENNELL AND WILSON, TITLE COMPANY DATED AUGUST 28, 2008. SAID REPORT IS INCORPORATED BY REFERENCE INTO THIS MAP. THE REPORT NUMBER 680820 DOES NOT WARRANT THE ACCURACY OF THE INFORMATION SHOWN HEREON.

EXCEPTION NOTES

- (NUMBERS CORRESPOND TO ITEM NUMBERS IN PRELIMINARY TITLE REPORT, NOT ALL EXCEPTION ITEMS ARE NOTED)
- 1 ANY ADVERSE CLAIM BASED UPON THE ASSERTION THAT SOME PORTION OF SAID PARCEL OR HAS ACQUIRED TO SUCH PORTION SO CREATED (ITEM 5)
 - 2 ANY ADVERSE CLAIM UPON THE ASSERTION THAT:
A) SOME PORTION OF SAID LAND IS THE OR SUPERSEDED LAND, OR HAS BEEN CREATED BY ARTIFICIAL MEANS OR HAS BEEN CREATED BY ARTIFICIAL MEANS OR HAS ACQUIRED TO SUCH PORTION SO CREATED (ITEM 5)
 - 3 ANY ADVERSE CLAIM BASED UPON THE ASSERTION THAT SOME PORTION OF SAID PARCEL OR HAS ACQUIRED TO SUCH PORTION SO CREATED (ITEM 5)
 - 4 ANY ADVERSE CLAIM BASED UPON THE ASSERTION THAT SOME PORTION OF SAID PARCEL OR HAS ACQUIRED TO SUCH PORTION SO CREATED (ITEM 5)
 - 5 ANY ADVERSE CLAIM BASED UPON THE ASSERTION THAT SOME PORTION OF SAID PARCEL OR HAS ACQUIRED TO SUCH PORTION SO CREATED (ITEM 5)
 - 6 ANY ADVERSE CLAIM BASED UPON THE ASSERTION THAT SOME PORTION OF SAID PARCEL OR HAS ACQUIRED TO SUCH PORTION SO CREATED (ITEM 5)
 - 7 ANY ADVERSE CLAIM BASED UPON THE ASSERTION THAT SOME PORTION OF SAID PARCEL OR HAS ACQUIRED TO SUCH PORTION SO CREATED (ITEM 5)
 - 8 ANY ADVERSE CLAIM BASED UPON THE ASSERTION THAT SOME PORTION OF SAID PARCEL OR HAS ACQUIRED TO SUCH PORTION SO CREATED (ITEM 5)
 - 9 ANY ADVERSE CLAIM BASED UPON THE ASSERTION THAT SOME PORTION OF SAID PARCEL OR HAS ACQUIRED TO SUCH PORTION SO CREATED (ITEM 5)
 - 10 ANY ADVERSE CLAIM BASED UPON THE ASSERTION THAT SOME PORTION OF SAID PARCEL OR HAS ACQUIRED TO SUCH PORTION SO CREATED (ITEM 5)
 - 11 ANY ADVERSE CLAIM BASED UPON THE ASSERTION THAT SOME PORTION OF SAID PARCEL OR HAS ACQUIRED TO SUCH PORTION SO CREATED (ITEM 5)
 - 12 ANY ADVERSE CLAIM BASED UPON THE ASSERTION THAT SOME PORTION OF SAID PARCEL OR HAS ACQUIRED TO SUCH PORTION SO CREATED (ITEM 5)
 - 13 ANY ADVERSE CLAIM BASED UPON THE ASSERTION THAT SOME PORTION OF SAID PARCEL OR HAS ACQUIRED TO SUCH PORTION SO CREATED (ITEM 5)
 - 14 ANY ADVERSE CLAIM BASED UPON THE ASSERTION THAT SOME PORTION OF SAID PARCEL OR HAS ACQUIRED TO SUCH PORTION SO CREATED (ITEM 5)
 - 15 ANY ADVERSE CLAIM BASED UPON THE ASSERTION THAT SOME PORTION OF SAID PARCEL OR HAS ACQUIRED TO SUCH PORTION SO CREATED (ITEM 5)
 - 16 ANY ADVERSE CLAIM BASED UPON THE ASSERTION THAT SOME PORTION OF SAID PARCEL OR HAS ACQUIRED TO SUCH PORTION SO CREATED (ITEM 5)
 - 17 ANY ADVERSE CLAIM BASED UPON THE ASSERTION THAT SOME PORTION OF SAID PARCEL OR HAS ACQUIRED TO SUCH PORTION SO CREATED (ITEM 5)
 - 18 ANY ADVERSE CLAIM BASED UPON THE ASSERTION THAT SOME PORTION OF SAID PARCEL OR HAS ACQUIRED TO SUCH PORTION SO CREATED (ITEM 5)
 - 19 ANY ADVERSE CLAIM BASED UPON THE ASSERTION THAT SOME PORTION OF SAID PARCEL OR HAS ACQUIRED TO SUCH PORTION SO CREATED (ITEM 5)
 - 20 ANY ADVERSE CLAIM BASED UPON THE ASSERTION THAT SOME PORTION OF SAID PARCEL OR HAS ACQUIRED TO SUCH PORTION SO CREATED (ITEM 5)

LEGAL DESCRIPTION

THAT PORTION OF PARCEL "A" OF PARCEL MAP NO. 13,069, IN THE COUNTY OF SANTA BARBARA, CALIFORNIA, DESCRIBED AS FOLLOWS: BEGINNING AT A POINT IN THE SOUTHERLY LINE OF SAID PARCEL "A", DISTANT THEREON NORTH 77° 10' 52" WEST 505.71 FEET FROM THE SOUTHEAST CORNER OF SAID PARCEL "A"; THENCE, S1° NORTH 09° 43' 48" EAST, 747.70 FEET TO A POINT IN THE NORTHERLY LINE OF SAID PARCEL "A"; THENCE, S88°51'18" EAST, 214.89 FEET FROM THE MOST NORTHERLY CORNER OF SAID PARCEL "A" TO THE POINT OF BEGINNING; THENCE, S88°51'18" EAST, 433.49 FEET TO AN ANGLE POINT THEREIN; THENCE, S80° CONTINUING ALONG SAID NORTHERLY LINE, SOUTH 72° 23' 23" EAST, 82.18 FEET TO THE NORTHEAST CORNER OF SAID PARCEL "A"; THENCE, ALONG THE EASTERLY LINE OF SAID PARCEL "A", THE FOLLOWING LINE (S) COURSES:
4TH, SOUTH 07° 11' 45" EAST, 223.01 FEET;
5TH, SOUTH 48° 12' 21" WEST, 202.25 FEET;
6TH, SOUTH 60° 11' 54" EAST, 222.18 FEET;
7TH, SOUTH 27° 02' WEST, 186.50 FEET;
8TH, SOUTH 59° 32' 54" WEST, 212.13 FEET TO SAID SOUTHWEST CORNER OF SAID PARCEL "A"; THENCE, 8TH, ALONG SAID SOUTHERLY LINE OF SAID PARCEL "A", NORTH 77° 10' 52" WEST, 505.71 FEET TO THE POINT OF BEGINNING.
THIS LEGAL DESCRIPTION IS MADE PURSUANT TO THAT CERTAIN CERTIFICATE APPROVING A LOT SUBDIVISION, RECORDED IN BOOK 26008, PAGE 25, COUNTY OF SANTA BARBARA, CALIFORNIA, DATED AUGUST 28, 2008 AS INSTRUMENT NO. 2008-0077808 OF OFFICIAL RECORDS, VOL. 21, RECORDED DECEMBER APRIL 005-260-18



TENTATIVE PARCEL MAP

TPM14791 12TPM-00000-00006
A PROPOSED SUBDIVISION OF
APN 005-260-018
COUNTY OF SANTA BARBARA
STATE OF CALIFORNIA

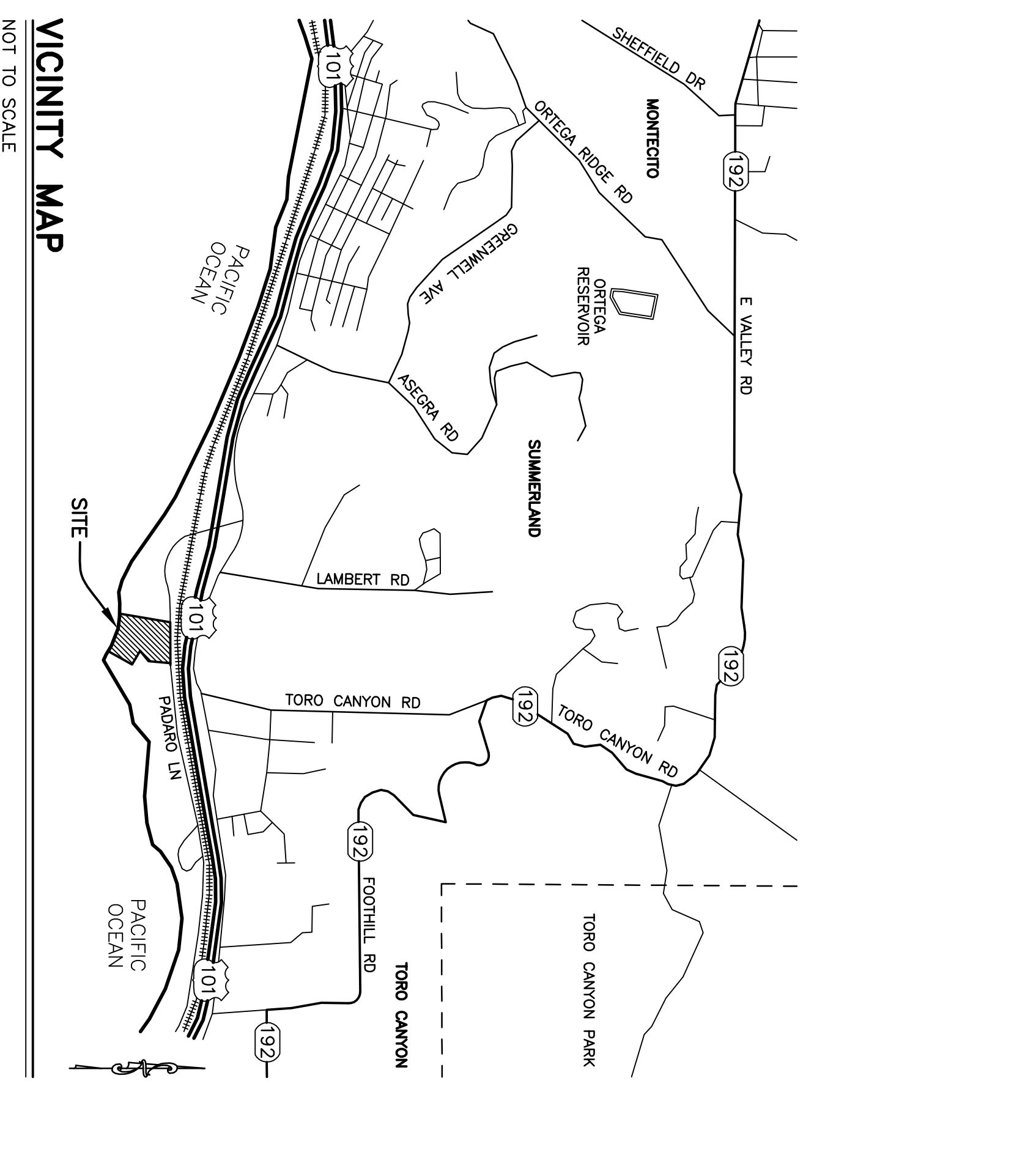

PROJECT TEAM
OWNER AND SUBDIVIDER:
3282 BEACH CLUB DRIVE FAMILY TRUST
C/O ALVAREZ & SHELLEY PC
14156 MAGNOLIA BLVD., SUITE 102
SHERMAN OAKS, CA 91423
(818) 501-3080
ENGINEER:
KENNETH A. WILSON
PENNELL & WILSON
111 E. VICTORIA STREET
SANTA BARBARA, CA 93101
(805) 963-9532
SURVEYOR:
KENNETH A. WILSON
PENNELL & WILSON
111 E. VICTORIA STREET
SANTA BARBARA, CA 93101
(805) 963-9532

PARCEL AREA CALCULATIONS

EXISTING PARCEL	ACREAGE	NET AREA	GROSS AREA
11CDH-00000-00054 (PARCEL A)	446,567 SF	10.25 AC	446,567 SF
11CDH-00000-00054 (PARCEL A)	132,601 SF	3.04 AC	132,601 SF
11CDH-00000-00006 (PARCEL B)	313,966 SF	7.21 AC	313,966 SF
TOTAL	446,567 SF	10.25 AC	446,567 SF

BUILDING ENVELOPE STATISTICS

DEVELOPMENT EXCLUSION AREA	AREA (SF)
11CDH-00000-00054 (PARCEL A)	42,139 SF
11CDH-00000-00006 (PARCEL B)	69,094 SF
TOTAL	111,233 SF

DEVELOPMENT EXCLUSION AREA STATISTICS

DEVELOPMENT EXCLUSION AREA	AREA (SF)
11CDH-00000-00054 (PARCEL A)	7,616 SF
11CDH-00000-00006 (PARCEL B)	4,910 SF
TOTAL	12,526 SF

OWNER'S CERTIFICATE
WE HEREBY CERTIFY FOR APPROVAL OF THE DIVISION OF REAL PROPERTY SHOWN ON THIS PLAN IS TRUE AND CORRECT TO THE BEST OF OUR KNOWLEDGE AND BELIEF.
3282 BEACH CLUB FAMILY TRUST
TITLE:
SIGNATURE: _____ TITLE: _____
C/O ALVAREZ & SHELLEY PC
14156 MAGNOLIA BLVD., SUITE 102
SHERMAN OAKS, CA 91423
(818) 501-3080

UTILITY PROVIDERS
SANITARY SEWER - PRIVATE ON-SITE SERVICE
WATER - MONTEZUMA WATER SPRING AND PRIVATE WATER WELL
GAS - PROPANE
ELECTRIC - SOUTHERN CALIFORNIA Edison COMPANY
TELEPHONE COMMUNICATIONS - VERIZON CALIFORNIA INC.

