

**RESOLUTION OF THE SANTA BARBARA COUNTY
HISTORIC LANDMARKS ADVISORY COMMISSION**

DETERMINATION OF THE SANTA BARBARA COUNTY HISTORIC LANDMARKS ADVISORY COMMISSION THAT THE IRENE AND FRANCES RICH BEACH CABANA LOCATED AT 4353 MARINA DRIVE, SANTA BARBARA, CALIFORNIA, ASSESSOR'S PARCEL NO. 063-220-023, MEETS THE ELIGIBILITY CRITERIA FOR A COUNTY HISTORIC LANDMARK AND IS WORTHY OF PROTECTION UNDER CHAPTER 18A OF THE SANTA BARBARA COUNTY CODE; AND DESIGNATION OF THE IRENE AND FRANCES RICH BEACH CABANA AS A COUNTY LANDMARK AND PRESCRIBING CONDITIONS TO PROTECT AND PRESERVE IT

RESOLUTION No. 2011-3

WHEREAS, the Santa Barbara County Historic Landmarks Advisory Commission has considered the historical significance of a certain portion of the property located at 4353 Marina Drive, Santa Barbara, California, (hereinafter "IRENE AND FRANCES RICH BEACH CABANA") on Assessor's Parcel No. 063-220-023 and as shown on the map and legal description attached hereto as Exhibit A, in accordance with the requirements, standards and criteria contained in County Code, Chapter 18A, and has determined that it is worthy of protection as a County Historic Landmark; and

WHEREAS, IRENE AND FRANCES RICH BEACH CABANA is historically significant because:

1. It exemplifies or reflects special elements of the County's cultural, social or aesthetic history, as it is a small, surviving remnant of the California Dream that flourished on the coast of Southern California in the mid-Twentieth Century and was part of a notable arts colony that flourished on the property in the 1950s; and

2. It is identified with persons or events significant in local, state or national history, including famed actress Irene Rich, her daughter and renowned artist Frances Rich, Santa Barbara Mayor and State Assemblyman W. Don MacGillivray, and numerous notables from the worlds of art and entertainment such as artist Diego Rivera, actress Katharine Hepburn, opera singer Lottie Lehmann and many others; and
3. It has a location on an ocean-front bluff with unique physical characteristics and a view or vista representing an established and familiar visual feature of the Hope Ranch community; and
4. It is one of the few remaining examples in the county, region, state or nation possessing distinguishing characteristics of a historical type or specimen, as it is one of only a handful of beach cabanas surviving in the County of Santa Barbara.

NOW, THEREFORE IT IS FOUND, DETERMINED AND RESOLVED as follows:

1. The IRENE AND FRANCES RICH BEACH CABANA meets the eligibility requirements for a County Historic Landmark as described in County Code, Chapter 18A, Section 18A-3, and is worthy of protection.
2. The Historic Landmarks Advisory Commission hereby designates the IRENE AND FRANCES RICH BEACH CABANA, including landscaping and pathways, as an Historic Landmark, subject to the following conditions:
 - a. Demolition, removal or destruction, partially or entirely, is prohibited unless an application has been submitted to the Historic Landmarks Advisory Commission and express consent in writing is first obtained from the commission. Such consent may impose all reasonable conditions deemed appropriate by the commission to accomplish the purposes of County Code, Chapter 18A.
 - b. No alterations, repairs, additions or changes (other than normal maintenance and repair work) shall be made unless and until an

application has been submitted to the Historic Landmarks Advisory Commission and all plans therefor have first been reviewed by the commission and approved or modified, and reasonable conditions imposed as deemed necessary, and that all such work shall be done under the direction and control of the commission or other qualified person designated by it.

- c. The foregoing conditions shall not be imposed in such a way as to infringe upon the right of the owners of the IRENE AND FRANCES RICH BEACH CABANA to make any and all reasonable use of the property that is not in conflict with County Code Chapter 18A.
3. This designation shall expire after a period of ninety days, unless prior to the expiration of ninety days the Board of Supervisors shall have confirmed the action of the Historic Landmarks Advisory Commission pursuant to County Code, Chapter 18A, Section 18A-2.

PASSED, APPROVED AND ADOPTED by the Santa Barbara County Historic Landmarks Commission at Santa Barbara, California, this 12th day of December, 2011 by the following vote:

AYES: Brown, Cunningham, Kyriaco, Aceves, Duncan, Wyckoff, Hom, Wittausch, Woodward

NOES: None

ABSTAIN: None

ABSENT: Melcombe

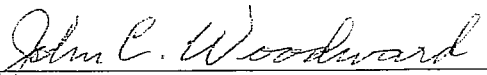

John C. Woodward
Chairman

Approved as to form:

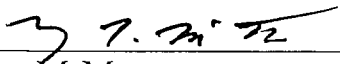

Mary McMaster
Senior Deputy County Counsel

We hereby APPROVE AND CONSENT to designation of the IRENE AND
FRANCES RICH BEACH CABANA as a County of Santa Barbara Historic
Landmark pursuant to County Code, Chapter 18A.

LEE CARR & JULIA CARR, Owners

Date: 12/12/11

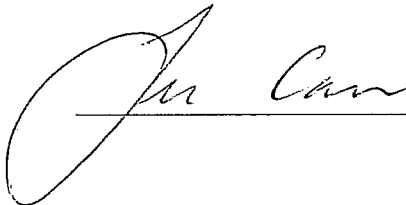

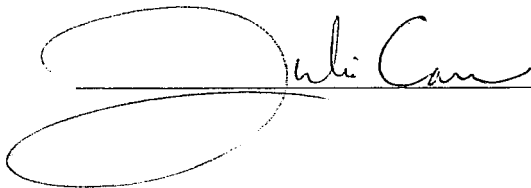

Exhibit A
Rich Cabana Historic Area

A portion of land in the County of Santa Barbara, State of California, being a portion of Parcel B of Parcel Map 10,994 according to the map recorded May 20, 1969 in Book 5, Page 51 of Parcel Maps, in the Office of the County Recorder of said County.

Said portion of land is described as follows:

Beginning at the northwesterly terminus of that certain course along the southerly boundary of said Parcel B labeled N 63° 00' W, 146.63; thence,

- 1st along said southerly boundary S 63° 00' 00" E, 117.57 feet; thence,
- 2nd N 39° 04' 36" E, 70.29 feet; thence,
- 3rd N 55° 18' 34" W, 127.53 feet; thence,
- 4th S 30° 56' 03" W, 86.00 feet to the point of beginning.

This real property description was prepared by me, or under my direction, in conformance with the Professional Land Surveyor's Act.

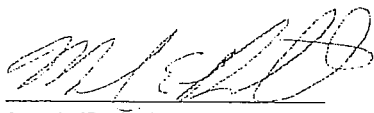
Signature: 
Mark E. Reinhardt, PLS

Date: 9/28/10



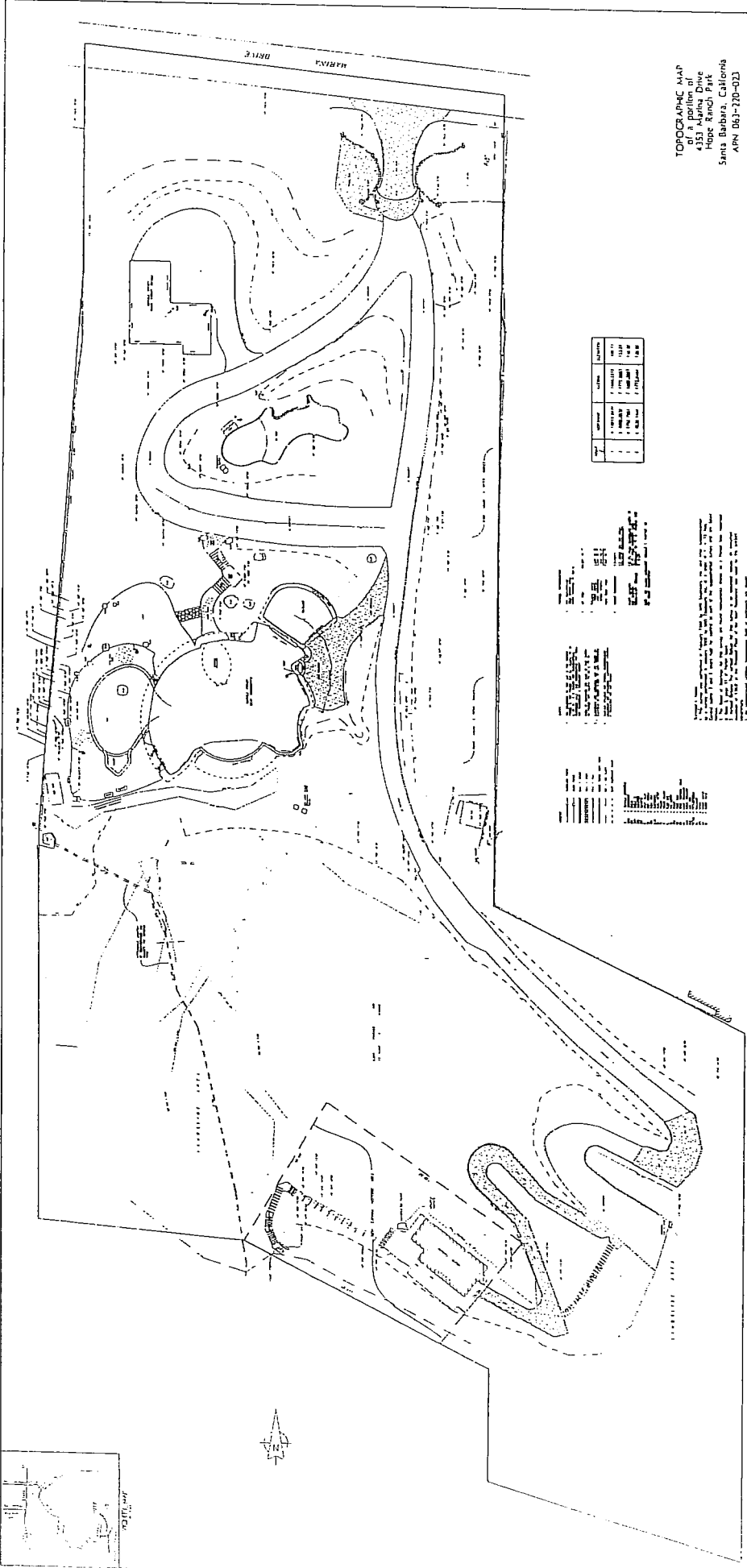

TOPOGRAPHIC MAP
 4331 Alhambra Drive
 Hope Ranch Park
 Santa Barbara, California
 APN 063-720-023

Prepared
 at the request of
 Paul Ashby
 • January 18, 2004
 • Revised April 23, 2004
 • Revised September 27, 2011

REVISIONS
 1. 1/18/04
 2. 4/23/04
 3. 9/27/11

NO.	DATE	DESCRIPTION
1	1/18/04	INITIAL DRAFT
2	4/23/04	REVISED TO SHOW
3	9/27/11	REVISED TO SHOW

This map was prepared by the Santa Barbara County Surveyor's Office. It is based on the original topographic map of the area, which was prepared by the U.S. Army Corps of Engineers in 1954. The map shows the terrain, roads, and buildings. It is intended for use as a reference for the proposed project.

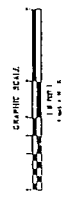

Santa Barbara County Surveyor's Office
 1000 State Street, Santa Barbara, CA 93101
 Phone: (805) 964-2100
 Fax: (805) 964-2101
 Website: www.sbcso.org

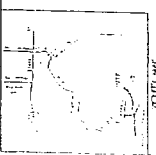

PARCEL B
OF PARCEL MAP 10,994
FILED IN BOOK 5, PAGE 51
OF PARCEL MAPS



P.O.B.

PACIFIC

OCEAN

RICH CABANA
HISTORIC AREA

9,513 Sq. Ft.
0.22 Acre

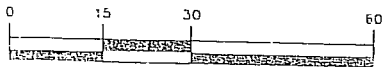

1 inch = 30 ft.

EXHIBIT "B"

DIAGRAM SHOWING PORTION OF LAND AS
DESCRIBED IN ATTACHED LEGAL DESCRIPTION
(EXHIBIT "A")

MNS
ENGINEERS INC.
LAND SURVEYING & MAPPING
CONSTRUCTION MANAGEMENT

ENGINEERING
PLANNING
SURVEYING
CONSTRUCTION MANAGEMENT

050112-105 - 050113 Esbdwg - 09/27/2010 - DR - E-FILE