

County of Santa Barbara  
Public Works Department

**Office of the County Surveyor**

123 E. Anapamu Street  
Santa Barbara, California 93101  
805/568-3020 FAX 805/568-3318

*Aleksandar Jevremovic, County Surveyor*



**TRANSMITTAL**

**TO:** Shannon Reese, Planner

**DATE:** 10/25/2017

**ADDRESS/DEPARTMENT:** Planning and Development

**FROM:** Aleksandar Jevremovic, County Surveyor *AJ.*

**PHONE:** 3012

**SUBJECT: 17AGP-00000-00021**  
**Solid Rock Group, New Agricultural Preserve Contract**  
**APN: 128-100-014**

QTY	DESCRIPTION
1	Approved Legal Description with exhibit map

**ACTION:**

- As Requested
- For Your Use
- Approved as Noted
- For Review and Comment

REMARKS:



# AGRICULTURAL PRESERVE

17AGP-00000-00021

## LEGAL DESCRIPTION

**PARCEL 1:**

THE SOUTHEAST QUARTER OF SECTION 29, TOWNSHIP 10 NORTH, RANGE 33 WEST, S.B.B.M., IN THE UNINCORPORATED AREA OF THE COUNTY OF SANTA BARBARA, STATE OF CALIFORNIA, ACCORDING TO THE OFFICIAL PLAT THEREOF.

**PARCEL 2:**

THAT PORTION OF THE SOUTHWEST QUARTER OF SECTION 29, TOWNSHIP 10 NORTH, RANGE 33 WEST, S.B.B.M., IN THE UNINCORPORATED AREA OF THE COUNTY OF SANTA BARBARA, STATE OF CALIFORNIA, ACCORDING TO THE OFFICIAL PLAT THEREOF, DESCRIBED AS FOLLOWS:

COMMENCING AT THE NORTHWEST CORNER OF THE SOUTHWEST QUARTER OF SAID SECTION 29;

THENCE SOUTHERLY AND ALONG WEST LINE OF SAID SECTION 29, 24 FEET TO A POINT;

THENCE EASTERLY AND PARALLEL WITH THE NORTH LINE OF SAID SOUTHWEST QUARTER OF SAID SECTION 29, 160 RODS MORE OR LESS TO THE EAST LINE OF THE SOUTHWEST QUARTER OF SAID SECTION 29;

THENCE NORTHERLY AND ALONG SAID EAST LINE 24 FEET, MORE OR LESS TO THE NORTHEAST CORNER OF SAID SOUTHWEST QUARTER OF SAID SECTION 29;

THENCE WESTERLY AND ALONG NORTH LINE OF SAID SOUTHWEST QUARTER 160 RODS, MORE OR LESS TO THE POINT OF BEGINNING.

APN# 128-100-014



10/25/2017

APPROVED AS TO FORM  
AND SURVEY CONTENT

*Aleksandar Jevremovic*  
ALEKSANDAR JEVREMOVIC  
COUNTY SURVEYOR  
LICENSE EXP. 12/31/2017

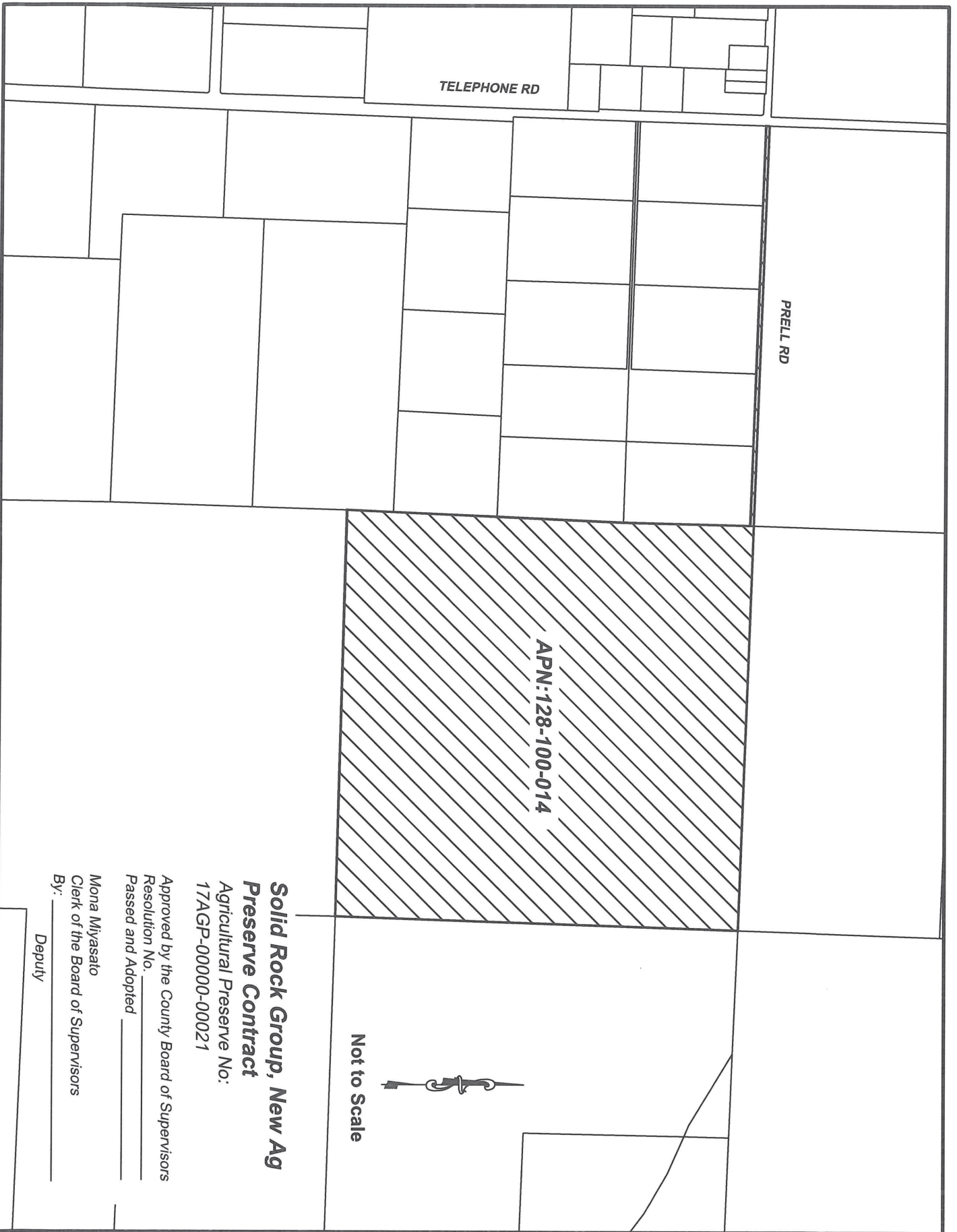

**Solid Rock Group, New Ag  
Preserve Contract**

Agricultural Preserve No:  
17AAGP-00000-00021

Approved by the County Board of Supervisors  
Resolution No. \_\_\_\_\_  
Passed and Adopted \_\_\_\_\_

Mona Miyasato  
Clerk of the Board of Supervisors  
By: \_\_\_\_\_  
Deputy