

COUNTY OF SANTA BARBARA
STATE OF CALIFORNIA
DEPARTMENT OF PUBLIC WORKS

PLANS FOR THE CONSTRUCTION OF
**HUMMEL DRIVE & UNION VALLEY
PARKWAY TRAFFIC SIGNAL**

APPROXIMATELY 1.2 MILES WEST OF HWY101 AND UNION VALLEY
PARKWAY INTERCHANGE
IN THE 4TH SUPERVISORIAL DISTRICT
COUNTY PROJECT NO. 862453

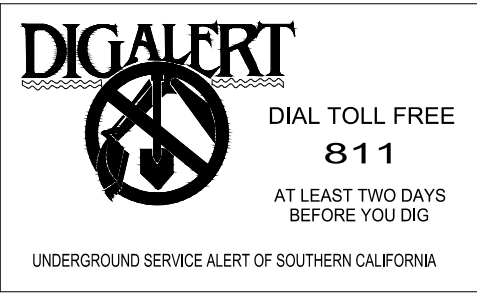
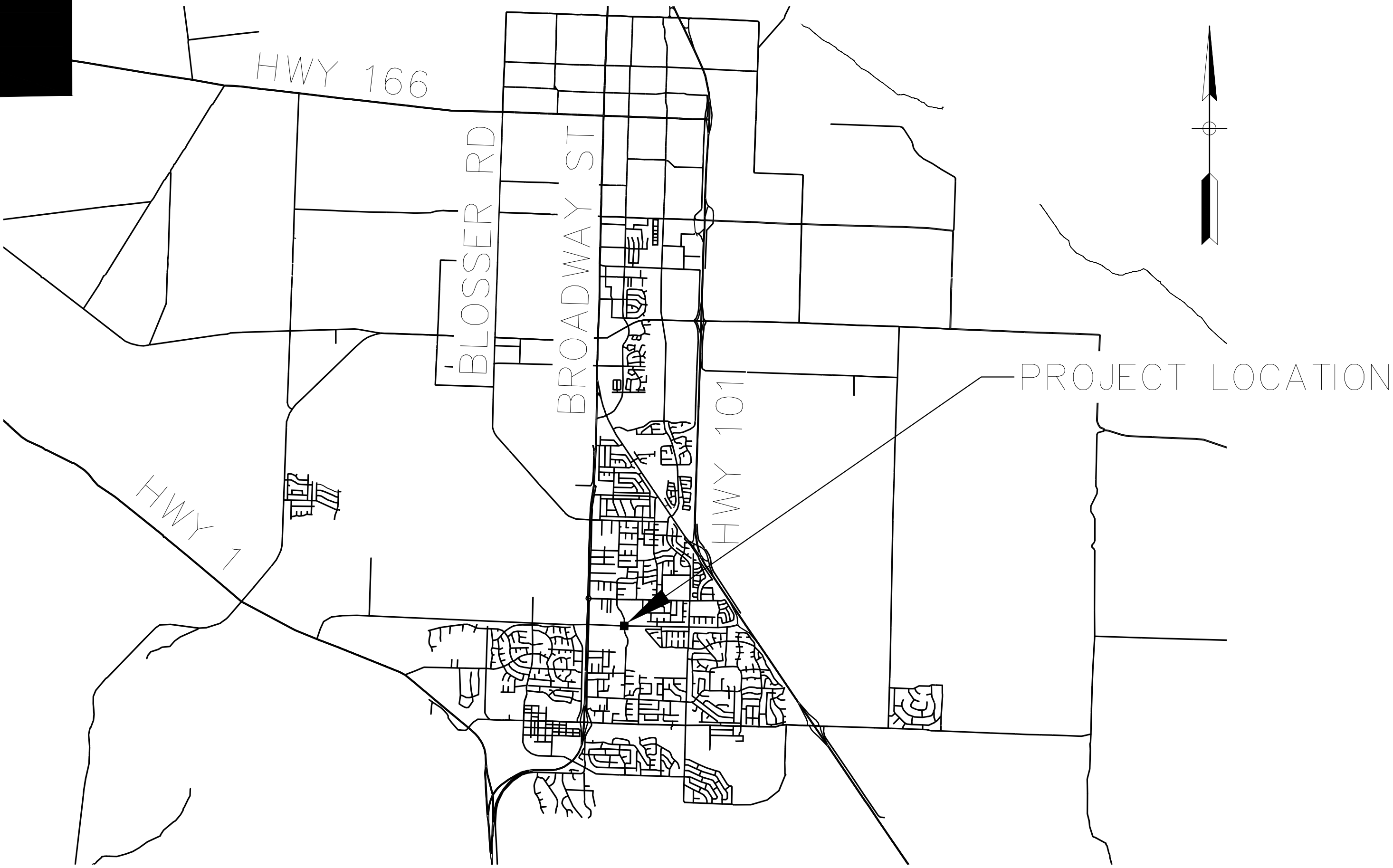
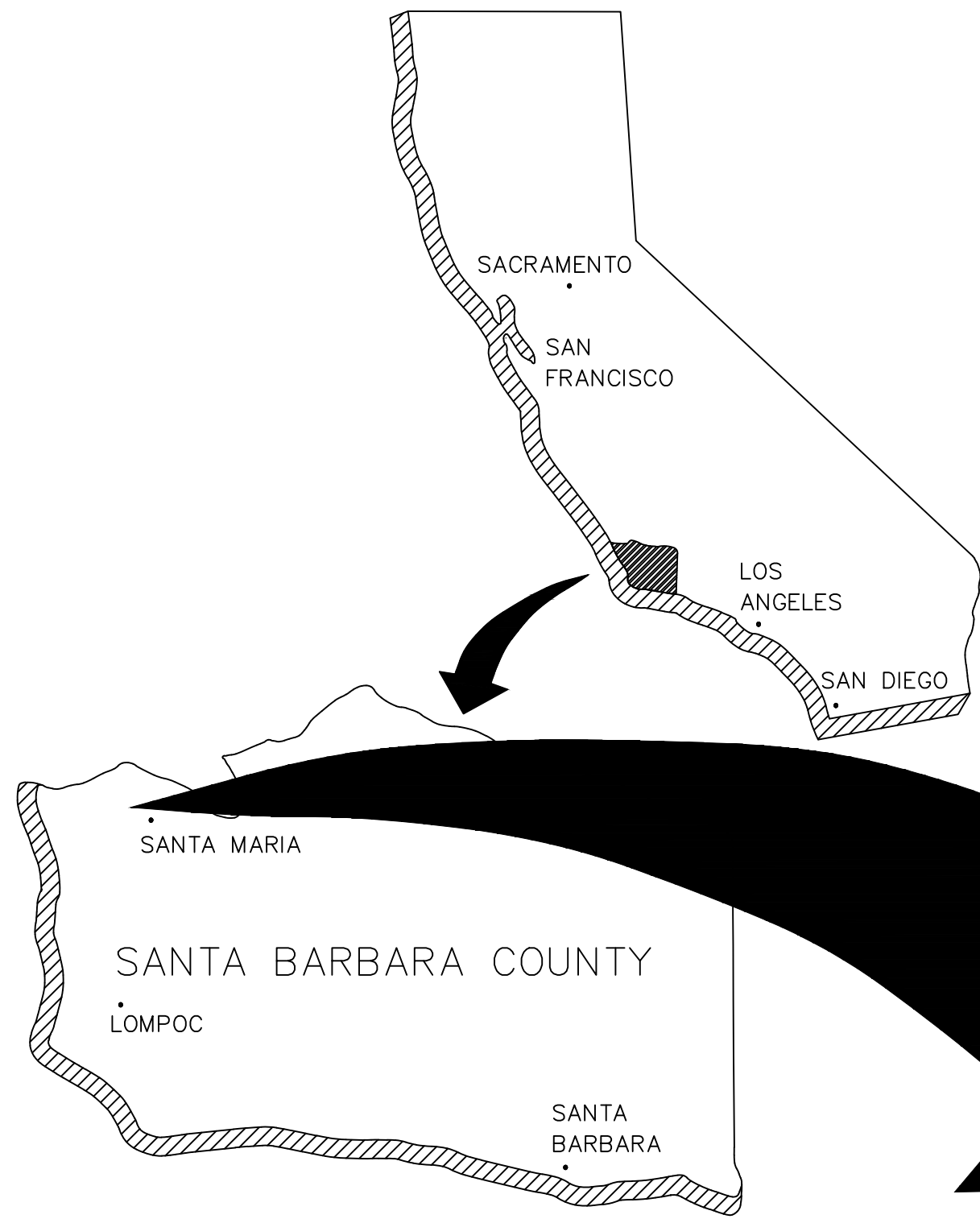

NOTE:
IT SHALL BE THE RESPONSIBILITY OF THE CONTRACTOR TO WORK WITH THE LOCAL UTILITY COMPANIES TO LOCATE ALL UNDERGROUND SERVICE LINES WITHIN THE PROJECT LIMITS. CALL UNDERGROUND SERVICE ALERT AT (800) 422-4133 OR 811 A MINIMUM OF TWO WORKING DAYS PRIOR TO ANY EXCAVATION WORK.

THE CONTRACTOR SHALL POSSESS THE CLASS (OR CLASSES) OF LICENSE AS SPECIFIED IN THE "NOTICE TO BIDDERS."

APPROVED – BOARD OF SUPERVISORS DATE

DocuSigned by:
[Signature]
APPROVED – DIRECTOR OF PUBLIC WORKS DATE
10/14/2025 | 8:52 AM PDT

DocuSigned by:
[Signature]
APPROVAL RECOMMENDED – ENGINEERING SECTION MANAGER DATE
10/13/2025 | 1:11 PM PDT

INDEX TO SHEETS		
No.	SHEET	TITLE
1	TS-1	TITLE SHEET
2	G-1	GENERAL NOTES
3	PC-1	PROJECT CONTROL
4	DM-1	DEMOLITION PLAN
5-7	L	LAYOUT PLANS
8	CD	CONSTRUCTION DETAILS
9	EC-1	EROSION CONTROL PLAN
10-11	TR	TRAFFIC SIGNAL PLANS
12	PD-1	PAVEMENT DELINEATION

UTILITY PROVIDERS	
GOLDEN STATE WATER	WATER
LAGUNA COUNTY SANITATION DISTRICT	SEWER
PG&E	POWER
SOCAL GAS	GAS
FRONTIER	FIBER

INDEX TO STD DETAILS AND PLANS	
SANTA BARBARA COUNTY 2011 ENGINEERING DESIGN STANDARDS	
2-010	GENERAL TRENCH NOTES
2-020	PIPE BEDDING DETAILS
2-030	TRENCHES FOR EXISTING PAVED ROADS
3-010	GENERAL DRAINAGE FACILITIES NOTES
3-020	OPEN CURB DROP INLETS
4-010	CURB AND DRIVEWAY GENERAL NOTES
4-030	CURBS AND GUTTERS
4-035	MEDIAN STRIPS
5-010	GENERAL SIDEWALK NOTES
5-030	CURB RAMP DETAILS
5-040	SIDEWALK DETAILS
5-045	SIDEWALK TRANSITIONS
5-050	SIDEWALK UTILITIES
6-010	GENERAL STREET SECTION NOTES
6-040	LOCAL PUBLIC ROAD SECTIONS ADT 250 TO 5000
6-070	MAJOR & ARTERIAL ROAD SECTIONS ADT 5000 TO 16000
7-010	GENERAL SIGNAGE NOTES
7-050	ROADSIDE SIGN POSTS
7-060	STREET NAME SIGNS
2024 CALTRANS STANDARD PLANS	
A87A	- CURBS AND DRIVEWAYS
A87B	- HOT MIX ASPHALT DIKS
A88A	- CURB RAMP DETAILS
T51	- TEMPORARY WATER POLLUTION CONTROL DETAILS
T64	- TEMPORARY DRAINAGE INLET PROTECTION
ES-7Q	- ELECTRICAL SYSTEMS (PEDESTRIAN BARRICADES)
PAVEMENT MARKERS, TRAFFIC LINES, AND PAVEMENT MARKINGS	

TITLE SHEET
TS-1

CONSTRUCTION STARTED:		PROJECT ENGINEER: Signed by: <i>[Signature]</i> 10/10/2025 8:25 AM PDT DATE		COUNTY OF SANTA BARBARA DEPARTMENT OF PUBLIC WORKS TRANSPORTATION DIVISION	DESIGN BY: M. PALMER DRAWN BY: M. SAUCIUR	CHECKED BY: G. SMART CONSTRUCTABILITY REVIEW BY: *	SCALE: NTS	PROJECT NO. 862453	HUMMEL DRIVE & UNION VALLEY PARKWAY TRAFFIC SIGNAL	SHEET NO. 1 OF 11 FILE NO. *	
CONSTRUCTION COMPLETED:				FOR REDUCED PLANS ORIGINAL SCALE IN INCHES	0 1 2 3	DISREGARD PRINTS BEARING EARLIER REVISION DATES	REVISION DATES (PRELIMINARY STAGE ONLY)				
RECORD DRAWING APPROVED BY:											

HUMMEL DRIVE AND UNION VALLEY PARKWAY TRAFFIC SIGNAL

COUNTY OF SANTA BARBARA
DEPARTMENT OF PUBLIC WORKS
TRANSPORTATION DIVISION