

Line 4.7 - Avoid locating the Second Story Only over the Garage or any One portion of the Dwelling.

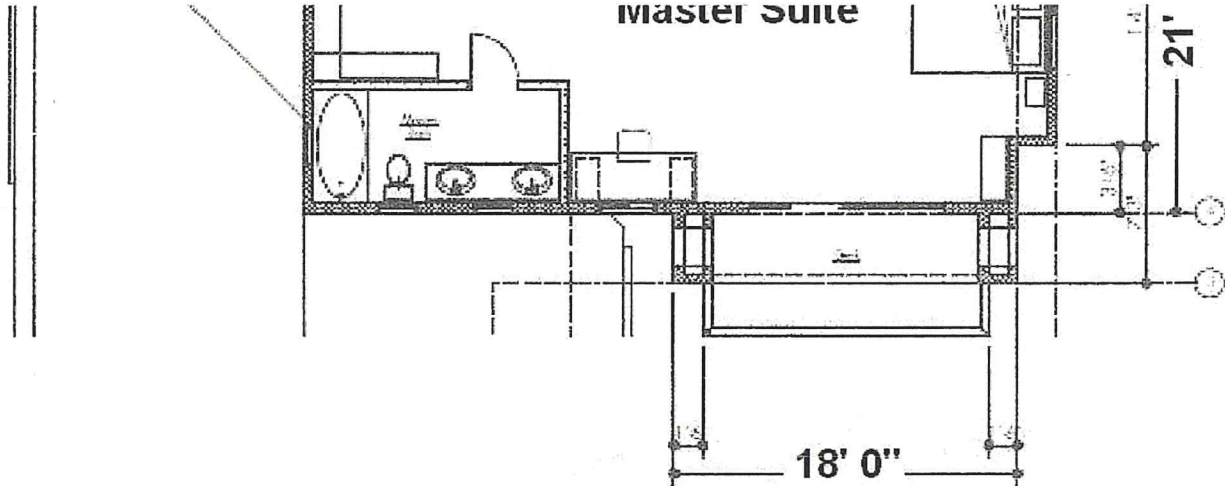

2 Upper Level Plan
Scale: 1/8" = 1'-0"
N

SBAR - South Coast Board of Architectural Review in Santa Barbara - Ruled that the 2nd Story is "Solely" over the Garage

Violating Guideline 4.7 SBAR voted 7-0
This is our Corrupt Government in Santa Barbara, Ca
Ed Kalasky D2Bike@Juno.com 805-964-3070

