

AGRICULTURAL PRESERVE

12AGP-00000-00028

EXHIBIT A

Legal Description

Parcel One

Parcel B of Parcel Map No. 12,264, in the County of Santa Barbara, State of California as shown on the map thereof filed in Book 16, Pages 53 through 56, inclusive, of Parcel Maps in the Office of the County Recorder of said County, said Parcel Map was amended by two Certificates of Correction recorded December 13, 1976 in Book 2637, Page 33 of Official Records and on June 28, 1984 as Instrument No. 84-34789, both in the Office of the County Recorder of said County.

Parcel Two

Being a portion of Parcel A of Parcel Map 12,264, in the County of Santa Barbara, State of California, as shown on the map thereof recorded in Book 16, at Pages 53 through 56, inclusive, of Parcel Maps, in the Office of the County Recorder of said County, together with the West Half of the Southwest Quarter of Section 29, Township 5 North, Range 29 West, San Bernardino Meridian, in the County of Santa Barbara, State of California, according to the Official Map thereof, on file in the District Land Office, described as follows:

Commencing at the northeasterly corner of Block 200 of the Official Map of the Town of Naples, in the County of Santa Barbara, State of California, as shown on the map thereof filed in Book 99, Pages 4 through 9, inclusive, of Official Maps, in the Office of the County Recorder of said County;

Thence West along the northerly line of said Block 200 a distance of 5,984.07 feet to the True Point of Beginning;

Thence North $11^{\circ}00'33''$ East, a distance of 1,896.85 feet;

Thence North $18^{\circ}12'50''$ East, a distance of 1,370.94 feet;

Thence North $89^{\circ}27'14''$ East, a distance of 3,766.10 feet to an angle point in the easterly line of said Parcel A, said angle point being the northwesterly terminus of the line shown on said Parcel Map as having a bearing of South $24^{\circ}02'22''$ East and a length of 3504.00 feet;

Thence along the boundary line of said Parcel A the following bearings and distances, North $55^{\circ}24'28''$ East, a distance of 1,040.79 feet;

Thence North $30^{\circ}51'47''$ West, a distance of 824.71 feet;

Thence North $49^{\circ}18'38''$ East, a distance of 625.10 feet;

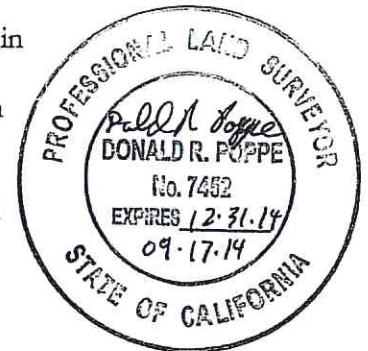

Thence North $89^{\circ}20'25''$ West, a distance of 444.00 feet;

Thence North $00^{\circ}21'53''$ East, a distance of 5,279.43 feet to the Southerly Quarter corner of said Section 29;

Thence South $89^{\circ}44'07''$ West, along the southerly line of said Section 29 a distance of 1,321.99 feet to the southeast corner of the West Half of the Southwest Quarter of said Section 29;

Thence North, leaving the boundary line of said Parcel A, a distance of 2,502.56 feet along the easterly line of said West Half, to the northeast corner of said West Half;

Thence West, a distance of 1,338.56 feet along the northerly line of said West Half to the northwest corner of said West Half, and being an angle point in the boundary line of said Parcel A;

Thence along the southerly line of the Northeast Quarter of Section 30 of Township 5 North, Range 29 West and the northerly line of said Parcel A per the Certificate of Correction recorded as Instrument No. 84-34789 of Official Records, North $89^{\circ}32'36''$ West, a distance of 2,619.75 feet;

Thence continuing along the boundary of said Parcel A, South $00^{\circ}01'07''$ West, a distance of 2,523.98 feet;

Thence South $00^{\circ}12'26''$ East, a distance of 1,540.29 feet;

Thence South $89^{\circ}52'40''$ West, a distance of 1,743.54 feet;

Thence South $43^{\circ}54'00''$ East, a distance of 52.11 feet;

Thence South $02^{\circ}46'50''$ West, a distance of 96.72 feet;

Thence South $33^{\circ}51'40''$ West, a distance of 43.71 feet;

Thence South $06^{\circ}39'20''$ East, a distance of 126.41 feet;

Thence South $09^{\circ}48'20''$ West, a distance of 81.02 feet;

Thence South $31^{\circ}02'20''$ West, a distance of 124.76 feet;

Thence South $36^{\circ}19'30''$ West, a distance of 100.47 feet;

Thence South $13^{\circ}06'30''$ East, a distance of 79.33 feet;

Thence South $42^{\circ}43'20''$ West, a distance of 83.29 feet;

Thence South $71^{\circ}08'50''$ West, a distance of 120.72 feet;

Thence South $44^{\circ}57'40''$ West, a distance of 160.82 feet;

Thence South 06°15'00" East, a distance of 183.62 feet;
Thence South 39°56'00" West, a distance of 90.81 feet;
Thence South 09°24'40" West, a distance of 167.84 feet;
Thence South 30°09'30" West, a distance of 138.67 feet;
Thence South 03°44'40" East, a distance of 102.41 feet;
Thence South 28°47'20" West, a distance of 103.56 feet;
Thence South 81°24'40" West, a distance of 60.34 feet;
Thence South 34°33'50" West, a distance of 233.42 feet;
Thence South 31°21'40" West, a distance of 92.70 feet;
Thence South 79°33'30" West, a distance of 59.09 feet;
Thence South 19°10'23" West, a distance of 139.17 feet;
Thence South 46°25'23" West, a distance of 218.00 feet;
Thence South 13°10'23" West, a distance of 130.00 feet;
Thence South 56°10'23" West, a distance of 224.00 feet;
Thence South 31°10'23" West, a distance of 313.00 feet;
Thence South 39°55'23" West, a distance of 148.00 feet;
Thence North 88°38'00" East, a distance of 709.06 feet;
Thence South 00°21'25" West, a distance of 936.61 feet;
Thence South 12°09'45" West, a distance of 3,785.54 feet to a point in the highway right of way line;
Thence South 63°03'50" East, along said highway right of way line a distance of 62.72 feet;
Thence South 07°26'38" West, a distance of 112.47 feet;
Thence South 52°22'28" East, a distance of 305.85 feet;
Thence South 45°01'55" East, a distance of 397.57 feet;
Thence South 47°07'02" East, a distance of 2,209.71 feet;
Thence South 60°51'13" East, a distance of 231.62 feet;

Thence South 44°49'36" East, a distance of 336.47 feet;

Thence North 72°00'00" East, leaving said highway right of way line a distance of 192.29 feet;

Thence North 17°10'00" East, a distance of 420.00 feet;

Thence North 16°40'00" West, a distance of 265.00 feet;

Thence North 10°30'00" East, a distance of 440.00 feet;

Thence North 18°10'00" West, a distance of 91.07 feet;

Thence East, a distance of 689.04 feet to the point of beginning.



APPROVED AS TO FORM
AND SURVEY CONTENT

E. Tenell Matlovsky
Deputy:
COUNTY SURVEYOR
LICENSE EXP. 12/31/2014

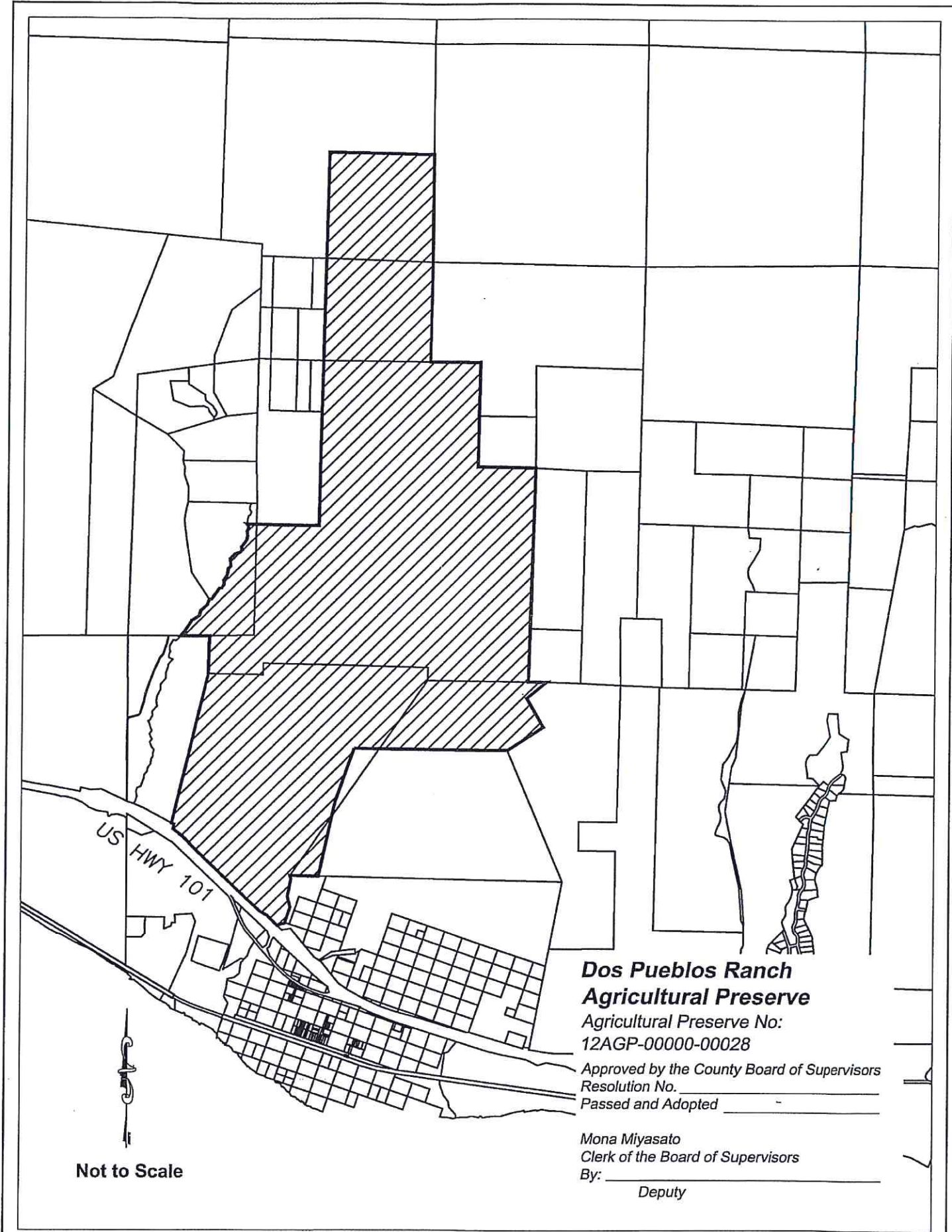

Not to Scale

**Dos Pueblos Ranch
Agricultural Preserve**

Agricultural Preserve No:
12AGP-00000-00028

Approved by the County Board of Supervisors
Resolution No. _____
Passed and Adopted _____

Mona Miyasato
Clerk of the Board of Supervisors
By: _____

Deputy