

**ATTACHMENT 3: APPROVED LEGAL DESCRIPTION AND SURVEYOR'S MAP**

# EXHIBIT A

## AGRICULTURAL PRESERVE

23AGP-00000-00001

### LEGAL DESCRIPTION

**APN: 141-250-036**

ALL THAT PORTION OF THE RANCHO CANADA DE LOS PINOS, OR COLLEGE RANCH, IN THE COUNTY OF SANTA BARBARA, STATE OF CALIFORNIA, BEING PORTIONS OF THE LAND DESCRIBED IN THE CERTIFICATES OF COMPLIANCE RECORDED AUGUST 3, 2004 AS INSTRUMENT NO. 'S 2004-0080930 AND 2004-0080931, OFFICIAL RECORDS OF SAID COUNTY AND STATE; DESCRIBED AS FOLLOWS:

BEGINNING AT A POINT THAT BEARS S 00° 23' 30" W, 907.23 FEET FROM THE NORTHEAST CORNER OF THE PARCEL OF LAND DESCRIBED IN SAID INSTRUMENT NO. 2004-0080930 OR, SAID POINT BEING THE INTERSECTION OF THE EASTERLY LINE OF SAID LAND WITH THE CENTER OF THE EXISTING CREEK RUNNING IN A GENERAL NORTHEAST TO SOUTHWEST DIRECTION; THENCE, ALONG THE CENTERLINE OF SAID CREEK, FOLLOWING ITS NOW AND FUTURE NATURAL MEANDERS, THE FOLLOWING COURSES:

- 1) N 23° 54' 37" W, 165.64 FEET; THENCE,
- 2) N 64° 40' 12" W, 29.45 FEET; THENCE,
- 3) S 67° 38' 29" W, 103.04 FEET; THENCE,
- 4) S 65° 43' 56" W, 126.02 FEET; THENCE,
- 5) S 78° 42' 12" W, 64.29 FEET; THENCE,
- 6) N 66° 40' 27" W, 166.89 FEET; THENCE,
- 7) N 69° 16' 24" W, 98.88 FEET; THENCE,
- 8) S 85° 25' 12" W, 83.14 FEET; THENCE,
- 9) S 42° 06' 38" W, 143.88 FEET; THENCE,
- 10) S 66° 22' 51" W, 24.46 FEET; THENCE,
- 11) N 79° 00' 28" W, 51.39 FEET; THENCE,
- 12) S 45° 01' 27" W, 35.65 FEET; THENCE,
- 13) S 11 ° 59' 07" W, 47 .22 FEET; THENCE,
- 14) S 29° 46' 38" W, 113.85 FEET; THENCE,
- 15) S 31 ° 37' 31" W, 64.11 FEET; THENCE,
- 16) S 28° 53' 32" W, 124.71 FEET; THENCE,
- 17) S 45° 01' 43" W, 59.41 FEET; THENCE,
- 18) S 79° 46' 30" W, 102.52 FEET; THENCE,
- 19) S 83° 17' 44" W, 119.91 FEET; THENCE,
- 20) S 75° 00' 11" W, 55.55 FEET; THENCE,
- 21) S 60° 37' 50" W, 114.16 FEET; THENCE,
- 22) S 27° 55' 18" W, 80.79 FEET; THENCE,
- 23) S 46° 28' 22" W, 117.88 FEET; THENCE,
- 24) S 59° 26' 39" W, 71.59 FEET; THENCE,

- 25) S 80° 32' 48" W, 59.66 FEET; THENCE,
- 26) N 74° 25' 29" W, 62.55 FEET; THENCE,
- 27) N 64° 14' 57" W, 45.11 FEET; THENCE,
- 28) N 90° 00' 00" W, 39.24 FEET; THENCE,
- 29) S 52° 37' 47" W, 97.57 FEET; THENCE,
- 30) S 77° 51' 58" W, 113.22 FEET; THENCE,
- 31) S 86° 33' 14" W, 116.50 FEET; THENCE,
- 32) S 82° 20' 35" W, 147.03 FEET; THENCE,
- 33) S 71° 19' 03" W, 90.66 FEET; THENCE,
- 34) S 30° 49' 26" W, 75.12 FEET; THENCE,
- 35) S 12° 06' 09" E, 88.81 FEET; THENCE,
- 36) S 33° 43' 11" E, 107.38 FEET; THENCE,
- 37) S 10° 46' 10" E, 80.13 FEET; THENCE,
- 38) S 07° 22' 14" W, 38.77 FEET; THENCE,
- 39) S 37° 22' 17" W, 59.31 FEET; THENCE,
- 40) S 60° 42' 52" W, 81.15 FEET; THENCE,
- 41) S 69° 47' 51" W, 100.56 FEET; THENCE,
- 42) S 52° 29' 01" W, 65.96 FEET; THENCE,
- 43) S 35° 26' 55" W, 68.52 FEET; THENCE,
- 44) S 15° 24' 37" W, 88.79 FEET; THENCE,
- 45) S 29° 25' 39" W, 88.78 FEET; THENCE,
- 46) S 33° 02' 52" W, 88.80 FEET; THENCE,
- 47) S 51° 44' 25" W, 60.09 FEET; THENCE,
- 48) S 63° 07' 39" W, 96.05 FEET; THENCE,
- 49) S 59° 11' 52" W, 92.71 FEET; THENCE,
- 50) S 37° 05' 56" W, 69.98 FEET; THENCE,
- 51) S 33° 24' 54" W, 157.81 FEET TO A POINT IN THE WESTERLY LINE OF THE LAND DESCRIBED IN SAID INSTRUMENT NO. 2004-0080931 OR; THENCE,
- 52) N 00° 23' 30" E, ALONG THE WESTERLY LINE OF THE LANDS DESCRIBED IN SAID INSTRUMENTS, 2,793.74 FEET TO THE NORTHWEST CORNER OF THE LAND DESCRIBED IN SAID INSTRUMENT NO. 2004-0080930 OR; THENCE,
- 53) S 89° 30' 20" E; ALONG THE NORTHERLY LINE OF THE LAND DESCRIBED IN SAID INSTRUMENT NO. 2004-0080930 OR 3,073.51 FEET TO THE NORTHEAST CORNER THEREOF; THENCE,
- 54) S 00° 23' 30" W, 907.38 FEET ALONG SAID EAST LINE TO THE POINT OF BEGINNING.

THIS LEGAL DESCRIPTION IS MADE PURSUANT TO LOT 1 OF THAT CERTAIN CERTIFICATE APPROVING A LOT LINE ADJUSTMENT NO. 12LLA-00000-00005, RECORDED NOVEMBER 19, 2015 AS INSTRUMENT NO. 2015-0060811 OF OFFICIAL RECORDS.

APPROVED AS TO FORM  
AND SURVEY CONTENT

*Aleksandar Jevremovic*  
ALEKSANDAR JEVREMOVIC  
COUNTY SURVEYOR  
LICENSE EXP. 12/31/2023



*9/22/2023*

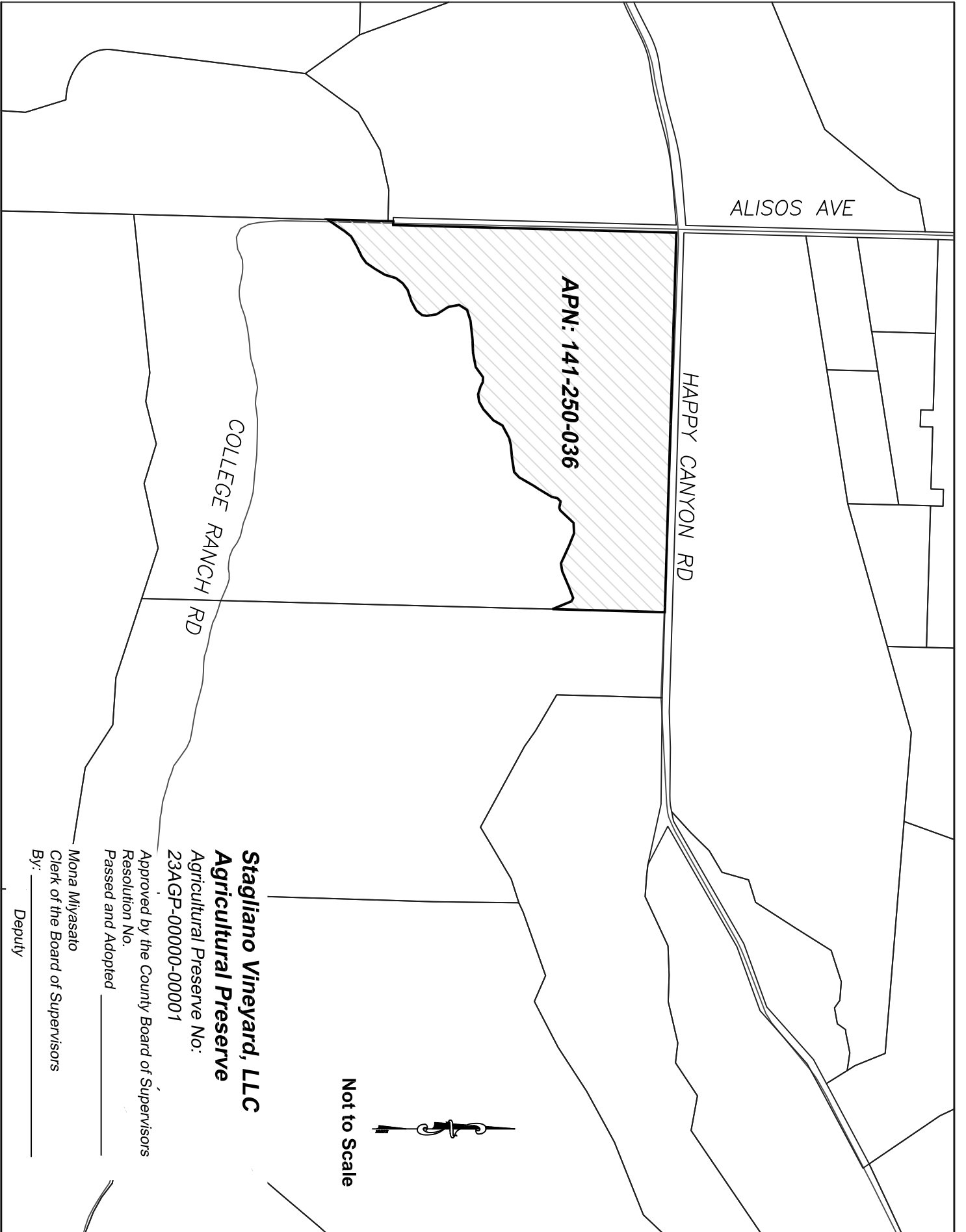

ALISOS AVE

HAPPY CANYON RD

COLLEGE RANCH RD

APN: 141-250-036



Not to Scale

**Stagliano Vineyard, LLC**  
**Agricultural Preserve**

Agricultural Preserve No:  
23AGP-00000-00001

Approved by the County Board of Supervisors  
Resolution No. \_\_\_\_\_  
Passed and Adopted \_\_\_\_\_

Mona Miyasato  
Clerk of the Board of Supervisors  
By: \_\_\_\_\_  
Deputy