

Site Plan dated October 7, 2009

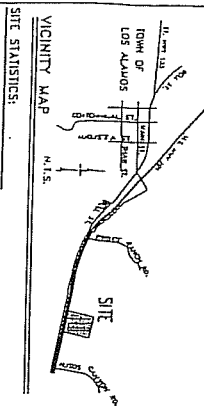
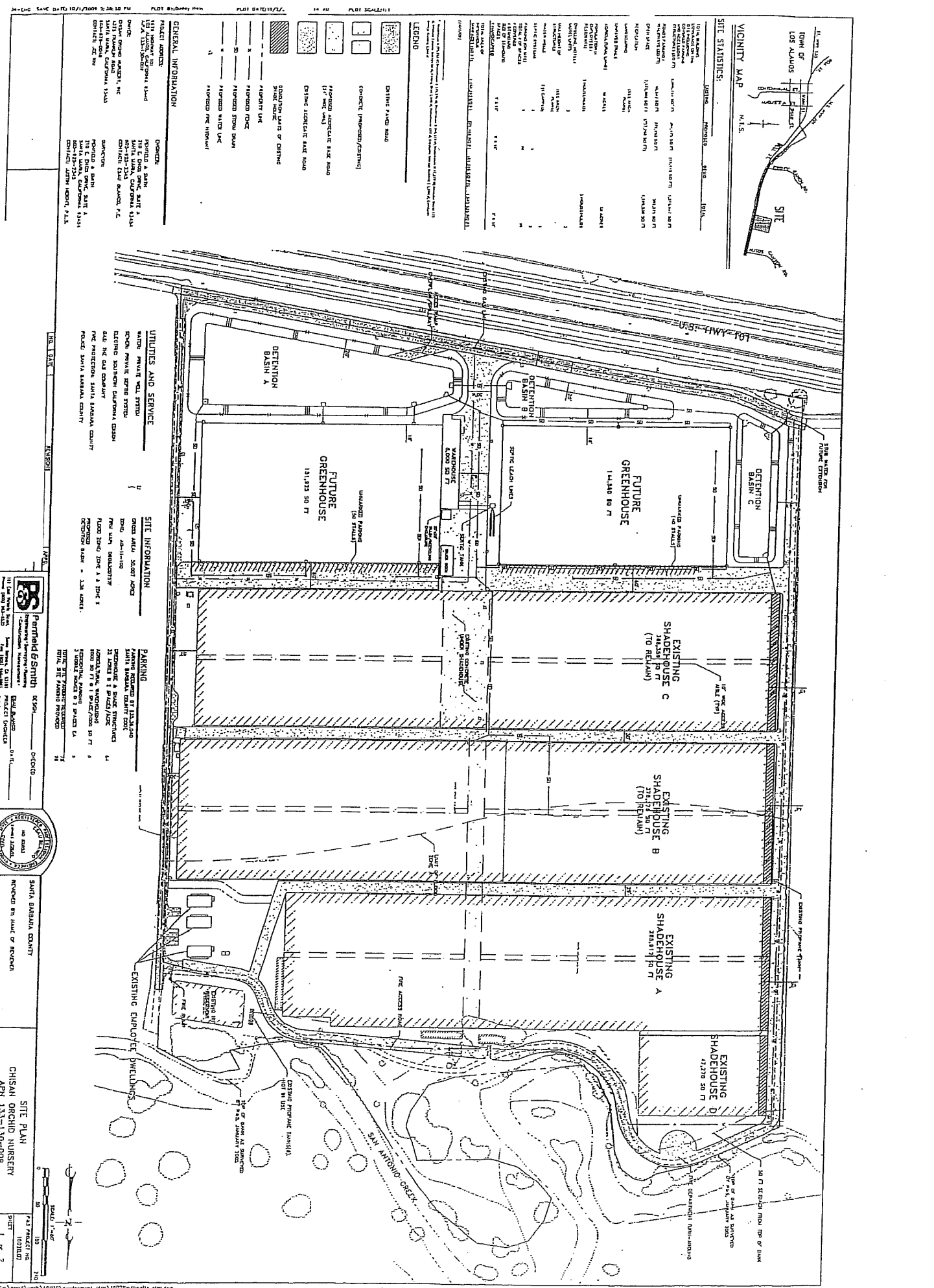

SITE STATISTICS:
TOTAL AREA: 100.00 AC
TOTAL AREA OF BUILDING FOOTPRINTS: 100.00 AC
TOTAL AREA OF PAVED SURFACES: 100.00 AC
TOTAL AREA OF UNPAVED SURFACES: 100.00 AC
TOTAL AREA OF OPEN SPACE: 100.00 AC

LEGEND:

- DRIVE PAVED ROAD
- CONCRETE (PROPOSED/EXISTING)
- ASPHALT (PROPOSED/EXISTING)
- GRAVEL (PROPOSED/EXISTING)
- ASPHALT PAVEMENT (EXISTING)
- GRAVEL PAVEMENT (EXISTING)
- GRASS (PROPOSED/EXISTING)
- WOOD DECK (PROPOSED/EXISTING)
- WOOD FLOOR (PROPOSED/EXISTING)
- WOOD ROOF (PROPOSED/EXISTING)

GENERAL INFORMATION:

PROJECT NAME: CHISMAN ORCHARD NURSERY

OWNER: CHISMAN ORCHARD NURSERY

DESIGNED BY: [Firm Name]

UTILITIES AND SERVICE:
WATER: PRIVATE WELL SYSTEM
SEWER: PRIVATE SEWER SYSTEM
ELECTRICAL: SEPARATE ELECTRICAL PANEL
GAS: GAS SERVICE FROM COUNTY

SITE INFORMATION:
SANTA BARBARA COUNTY

PARKING

TYPE	NO. SPACES
STANDARD	75
VEHICLE	18
TOTAL	93

PERMITS:

NO.	DATE	ISSUING AGENCY
1	10/19/2009	SANTA BARBARA COUNTY

SANTA BARBARA COUNTY

REVIEWED BY: [Name]

CHISMAN ORCHARD NURSERY

APR 133-130-009

NO.	DATE	ISSUING AGENCY
1	10/19/2009	SANTA BARBARA COUNTY