

AMENDED BOUNDARY OF COMMUNITY FACILITIES DISTRICT NO. 2002-1 COUNTY OF SANTA BARBARA - STATE OF CALIFORNIA

CLERK OF THE BOARD'S STATEMENT

I HEREBY CERTIFY THAT THE WITHIN MAP SHOWING THE AMENDED BOUNDARY OF COMMUNITY FACILITIES DISTRICT 2002-1 (ORCUTT COMMUNITY PLAN) COUNTY OF SANTA BARBARA, STATE OF CALIFORNIA, WAS APPROVED BY THE BOARD OF SUPERVISORS OF THE COUNTY OF SANTA BARBARA AT A REGULAR MEETING THEREOF, HELD ON THE 3 DAY OF April, 2007, BY COUNTY ORDINANCE NO. 07-080.

Resolution

FILED IN THE OFFICE OF THE COUNTY CLERK, COUNTY OF SANTA BARBARA THIS 9 DAY OF April, 2007.

MICHAEL E. BROWN
CLERK OF THE BOARD OF SUPERVISORS
OF SANTA BARBARA COUNTY
BY: Renee Bader
DEPUTY

COUNTY RECORDER'S STATEMENT

FILED THIS 13 DAY OF April, 2007, AT THE HOUR OF 1:18 PM O'CLOCK, M. IN BOOK 4 OF MAPS OF ASSESSMENT AND COMMUNITY FACILITIES DISTRICTS AT PAGE(S) 44-47, IN THE OFFICE OF THE COUNTY RECORDER IN THE COUNTY OF SANTA BARBARA, STATE OF CALIFORNIA.

JOSEPH E. HOLLAND
COUNTY CLERK - RECORDER - ASSESSOR
BY: Brendy Cune
DEPUTY

COUNTY SURVEYOR'S STATEMENT

THIS MAP WAS PREPARED UNDER MY DIRECTION IN ACCORDANCE WITH CALIFORNIA GOVERNMENT CODE SECTION 27557, AT THE REQUEST OF THE TREASURER - TAX COLLECTOR OF SANTA BARBARA COUNTY. I CERTIFY THE DISTRICT LINES SHOWN HEREON ARE CONSISTENT WITH THE AMENDED BOUNDARY OF THE COMMUNITY FACILITIES DISTRICT NO. 2002-1 APPROVED BY THE BOARD OF SUPERVISORS OF THE COUNTY OF SANTA BARBARA ON THE 3 DAY OF April, 2007, BY COUNTY ORDINANCE NO. 07-080.

Michael B. Emmons
MICHAEL B. EMMONS
COUNTY SURVEYOR
P.L.S. 5899
LICENSE EXPIRATION DATE 12/31/2008
DATE 4/9/07



AMENDED BOUNDARY OF

COMMUNITY FACILITIES DISTRICT 2002-1
(ORCUTT COMMUNITY PLAN)

COUNTY OF SANTA BARBARA, STATE OF CALIFORNIA

SHEET
1 OF 2

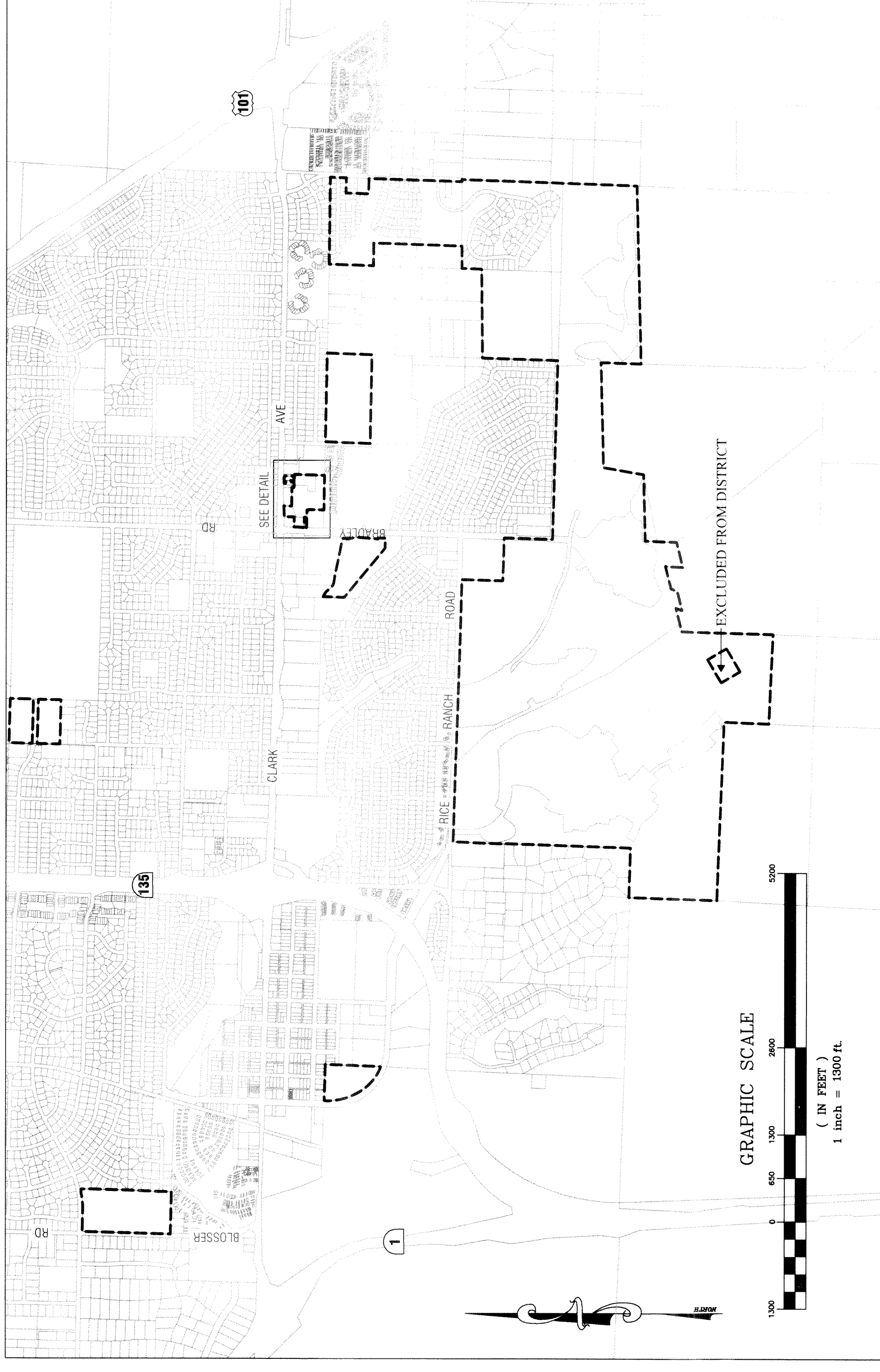
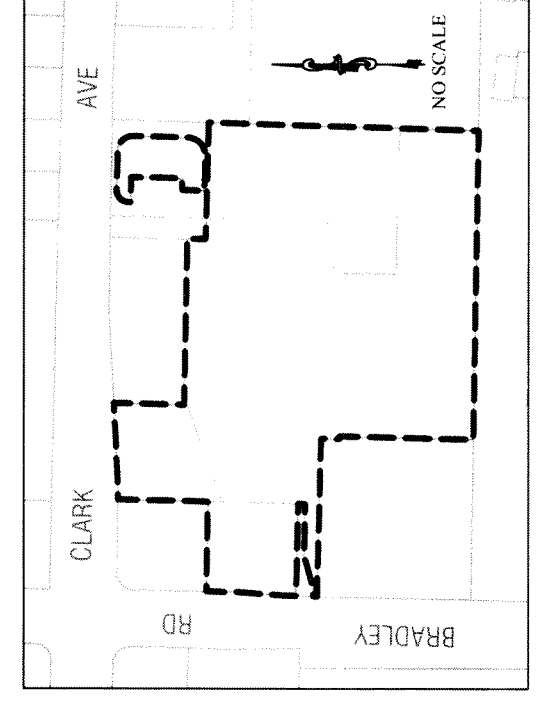
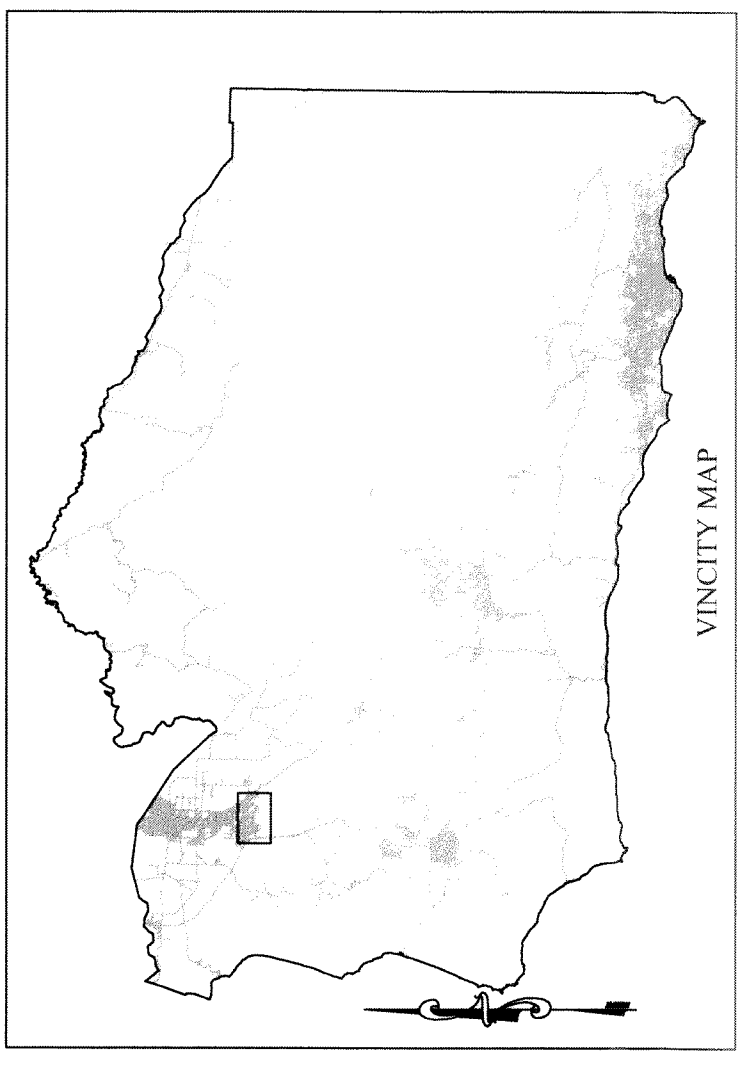

NOTE:
THIS MAP AMENDS THE BOUNDARY MAP FOR COMMUNITY FACILITIES DISTRICT 2002-1, IN THE COUNTY OF SANTA BARBARA, STATE OF CALIFORNIA AS PRIOR AMENDED AND RECORDED AT BOOK 4 AT PAGES 44 AND 45 OF MAPS OF ASSESSMENT AND COMMUNITY FACILITIES DISTRICTS IN THE OFFICE OF THE COUNTY RECORDER FOR THE COUNTY OF SANTA BARBARA, STATE OF CALIFORNIA.

LEGEND

COMMUNITY FACILITIES DISTRICT BOUNDARY

LEGAL DESCRIPTION (APN)
SEE SHEET 2 FOR LIST OF ASSESSOR PARCEL NUMBERS

APN 163-740-025, 028, 031, 032, 034