

SECTION 1			
Section IDs	Street Name	From	To
A 10885, A 10880	BUTTERFLY LN	CHANNEL DR	RRT
A 10915	HERMOSILLO DR	HOT SPRINGS RD	CITY LIMIT
A 11045, A 11050	BARKER PASS RD	HWY 192	CITY LIMIT
A 11057	CALLE ELEGANTE	BARKER PASS RD	S END
SECTION 2			
Section IDs	Street Name	From	To
A 10115, A 10120, A 10125	VIA REAL	3585' W/O CRAVENS LN	OCEAN VIEW AVE
SECTION 3			
Section IDs	Street Name	From	To
E 1690, E 1695	PATO AVE	CEBRIAN AVE	HWY 166
E 1725	HUBBARD AVE	CALIENTE ST	HWY 166

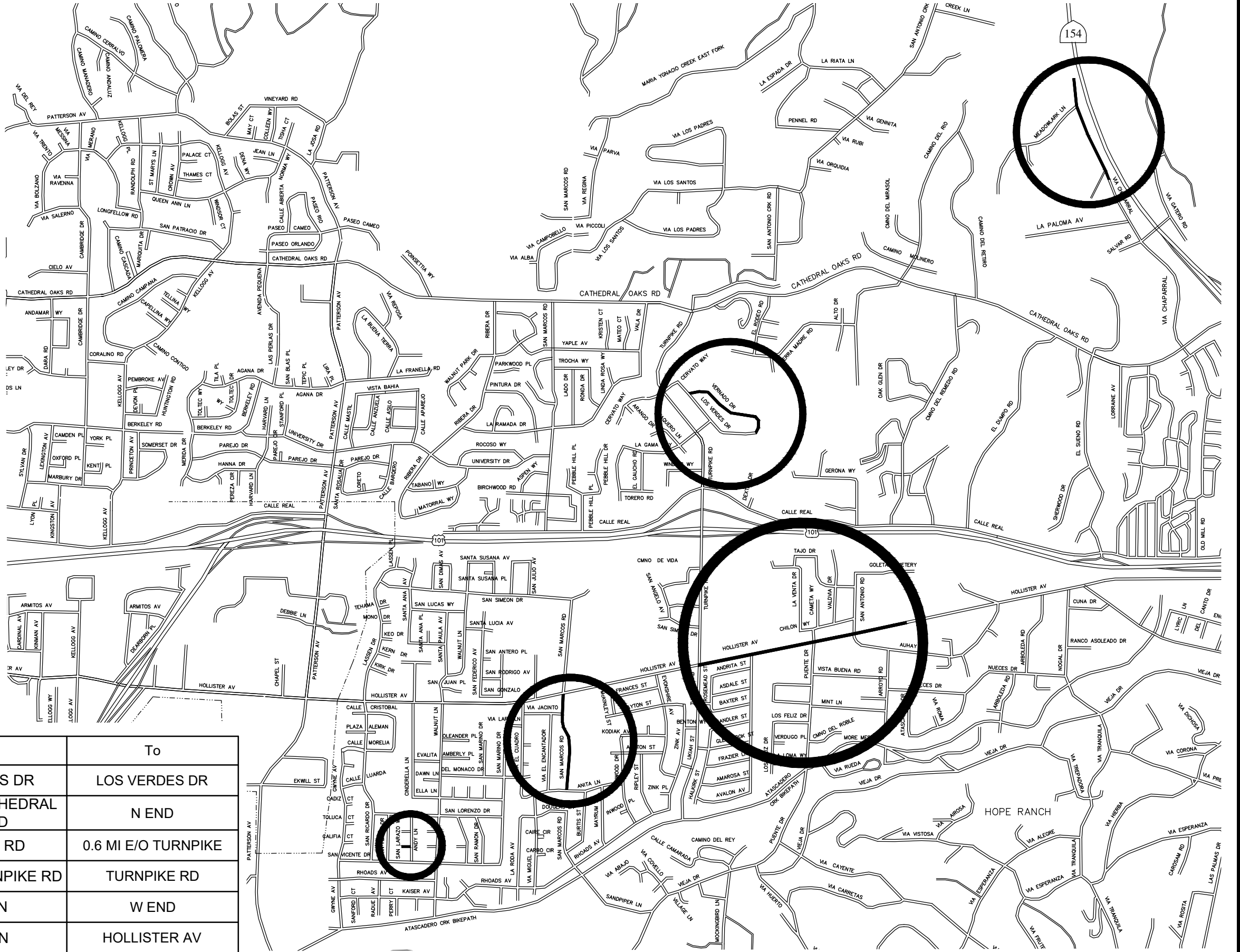

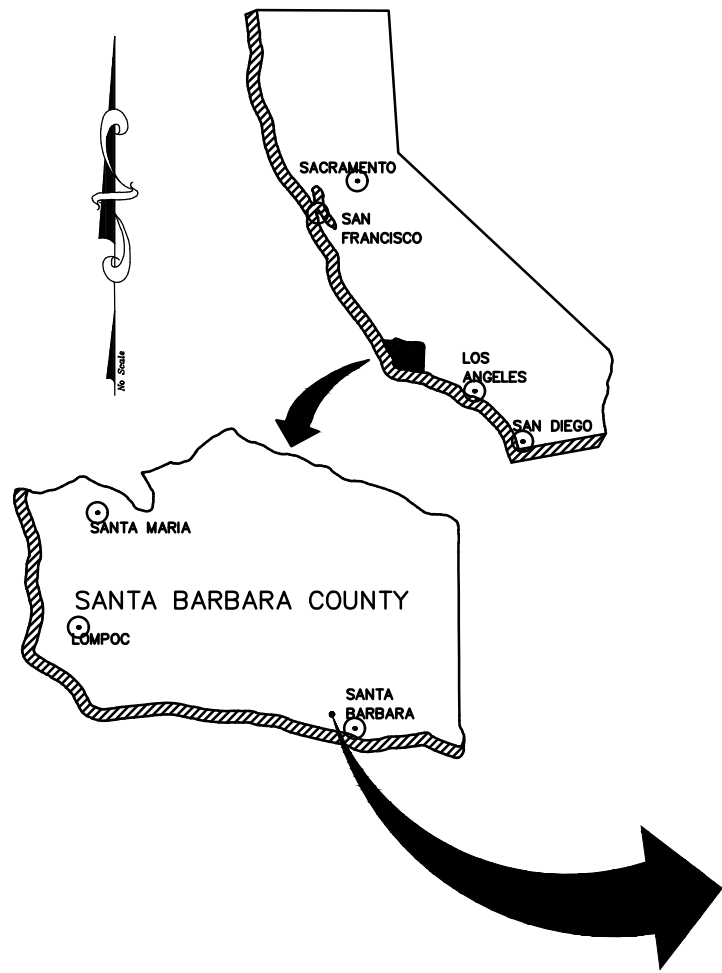

Section ID	Street Name	From	To
B 12115	VENADO DR	LOS VERDES DR	LOS VERDES DR
B 11925	VIA CHAPARRAL	0.6 MI N/O CATHEDRAL OAKS RD	N END
B 12190	HOLLISTER AV EB	TURNPIKE RD	0.6 MI E/O TURNPIKE
B 12205	HOLLISTER AV WB	0.6 MI E/O TURNPIKE RD	TURNPIKE RD
B 13585	SAN LAZARO WY	ANDY LN	W END
B 13710	SAN MARCOS RD	ANITA LN	HOLLISTER AV



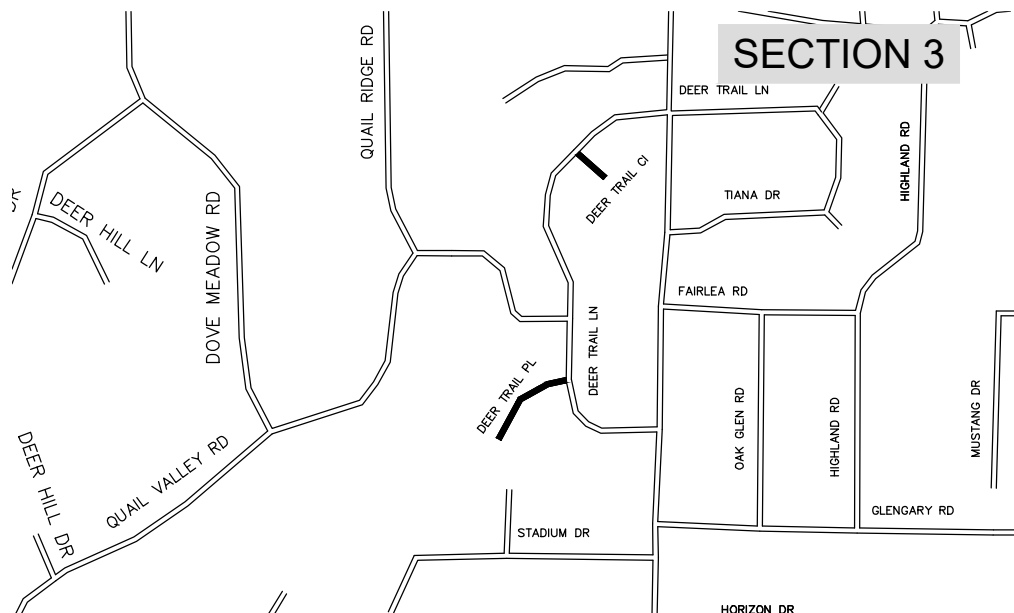
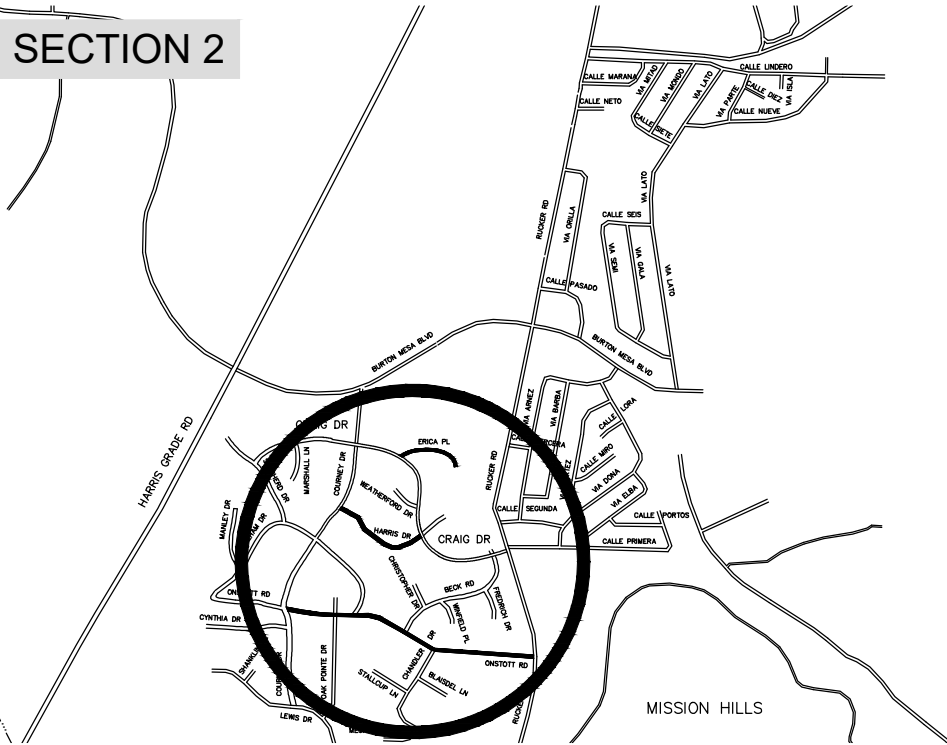
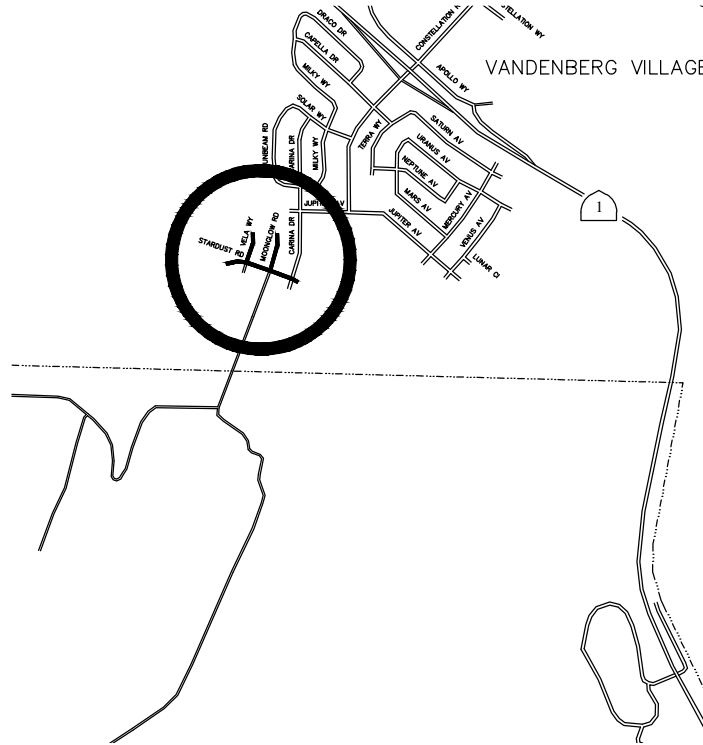
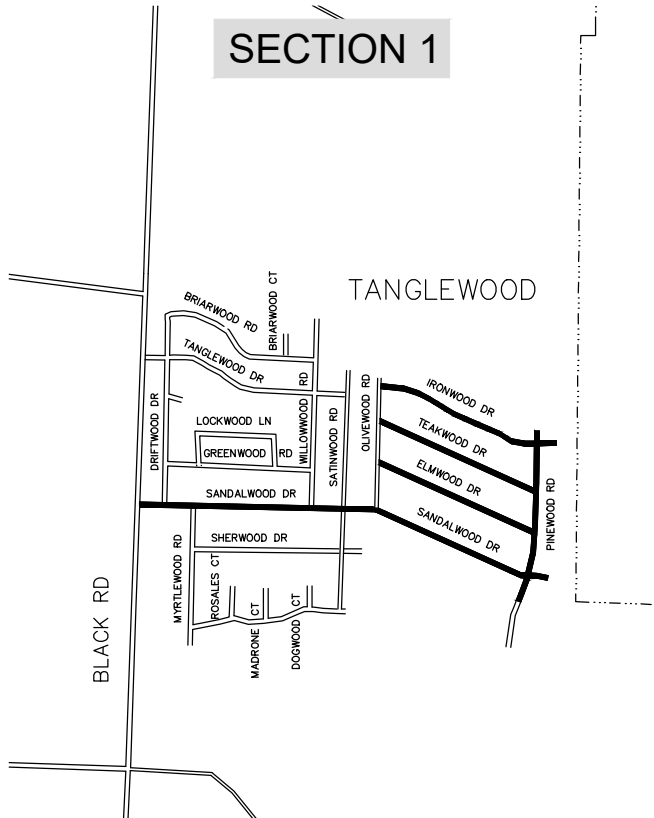
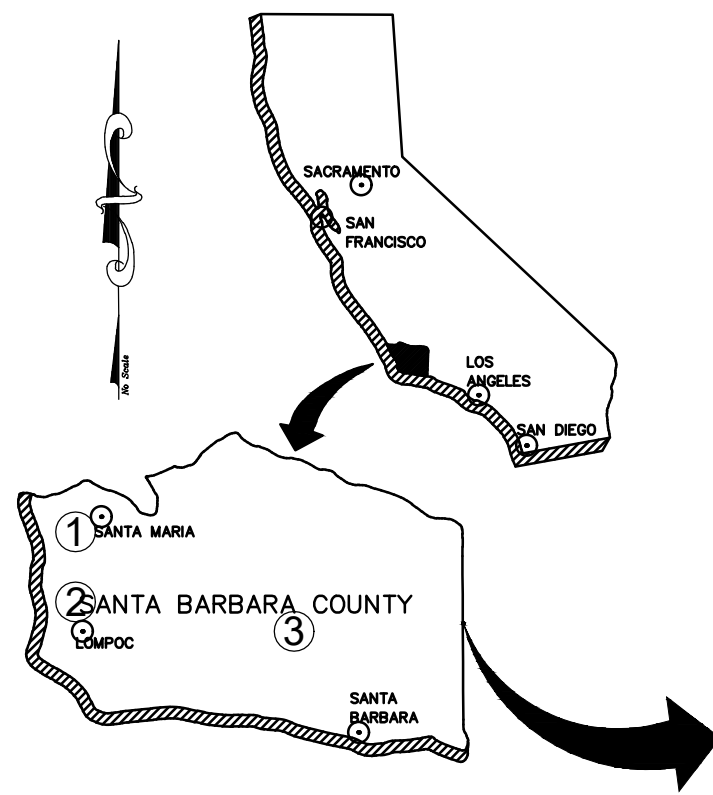

SECTION 1			
Section IDs	Street Name	From	To
E 1040	SANDALWOOD DR	BLACK RD	E END
E 1050	PINEWOOD DR	S END	N END
E 1060	IRONWOOD DR	E END	OLIVEWOOD RD
E 1070	TEAKWOOD DR	OLIVEWOOD DR	PINEWOOD DR
E 1080	ELMWOOD DR	PINEWOOD DR	OLIVEWOOD RD
SECTION 2			
D 28040, D 28050	STARDUST	W END	E END
D 28060	VELA WAY	STARDUST	N END
D28070	MOONGLOW	STARDUST	N END
D 27710	ONSTOTT RD	RUCKER RD	COURTNEY DR
D 27851	HARRIS DR	COURTNEY	CRAIG DR
D 27868, D 27869	ERICA PL	CRAIG DR	E END

SECTION 3			
Section IDs	Street Name	From	To
C 30775	MADERA ST	COTA ST	W END
C 30685	SAGUNTO ST	COTA ST	W END
C 30870, C 30875	COTA ST	N END	S END
C 30785	TYNDALL ST	SAGUNTO ST	MADERA ST PVT
C 31130	DEER TRAIL PL	DEER TRAIL LN	W END
C 31120	DEER TRAIL CIR	DEER TRAIL LN	S END



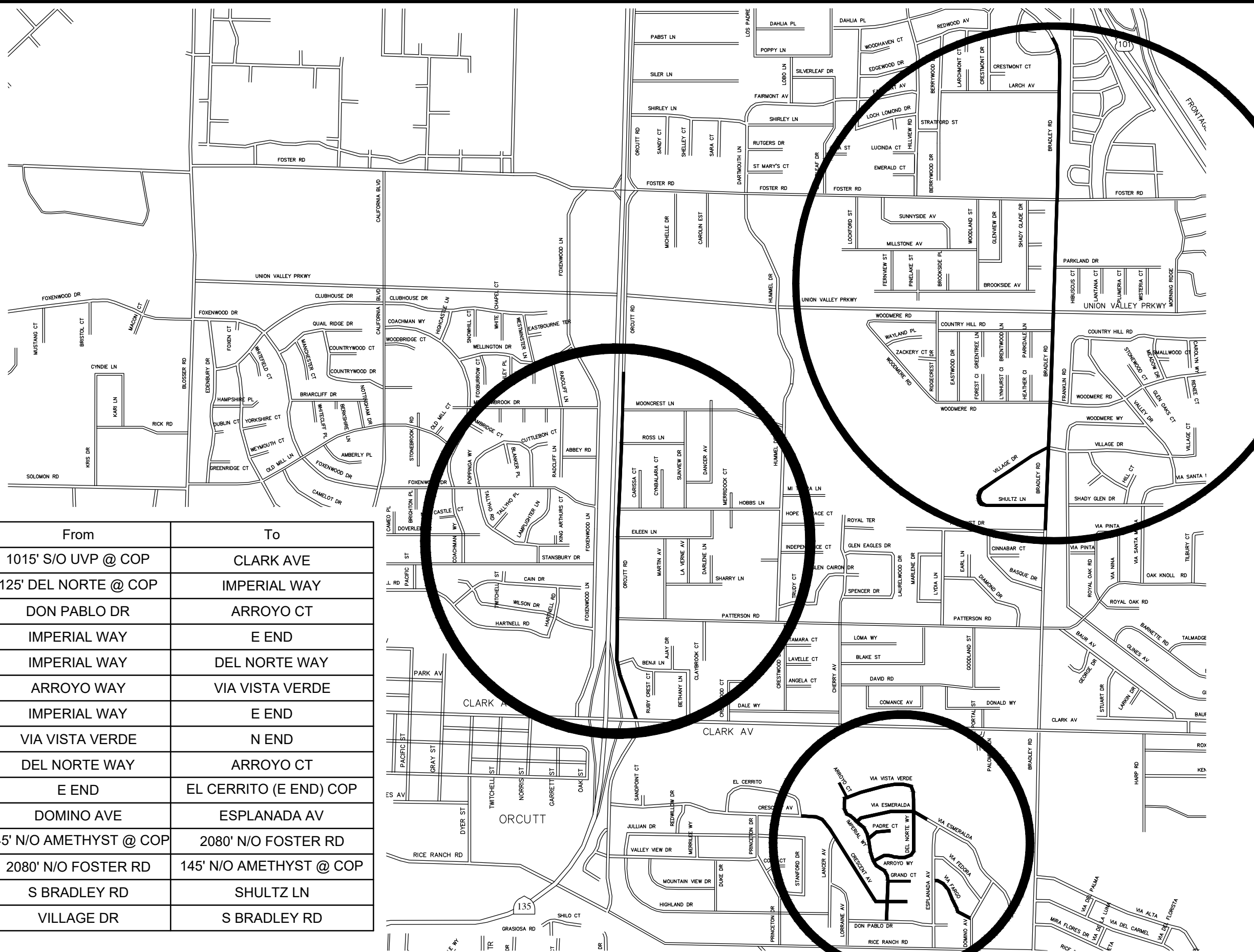
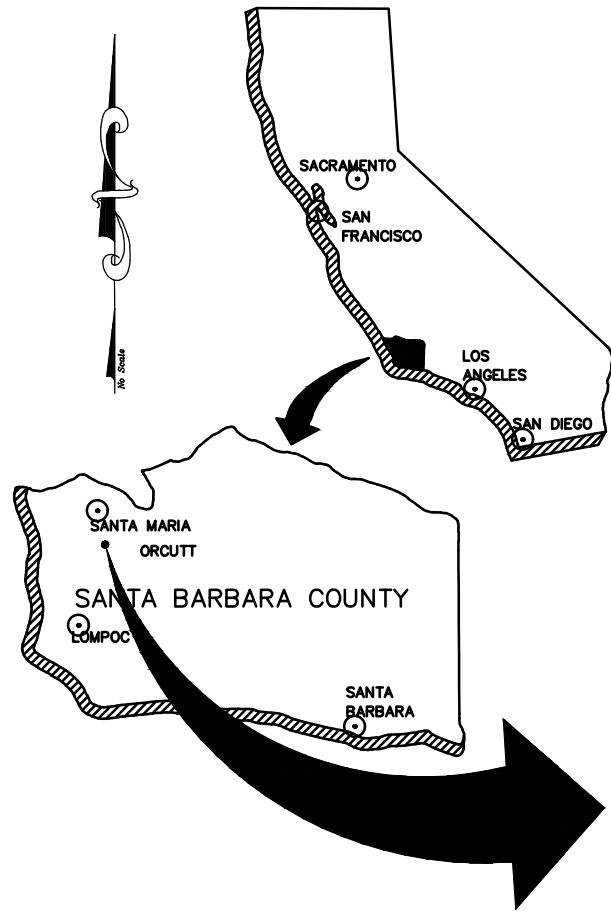

Section IDs	Street Name	From	To
E 4030, E 4040	ORCUTT RD	1015' S/O UVP @ COP	CLARK AVE
E 4365	VIA ESMERELDA	125' DEL NORTE @ COP	IMPERIAL WAY
E 4440, E 4445	IMPERIAL WAY	DON PABLO DR	ARROYO CT
E 4570	GRAND CT	IMPERIAL WAY	E END
E 4580	ARROYO WAY	IMPERIAL WAY	DEL NORTE WAY
E 4590	DEL NORTE WAY	ARROYO WAY	VIA VISTA VERDE
E 4600	PADRE CT	IMPERIAL WAY	E END
E 4610	ARROYO CT	VIA VISTA VERDE	N END
E 4620	VIA VISTA VERDE	DEL NORTE WAY	ARROYO CT
E 4450	CRESCENT AVE	E END	EL CERRITO (E END) COP
E 4380	VIA FARGO	DOMINO AVE	ESPLANADA AV
E 4700, E 4740	BRADLEY RD NB	145' N/O AMETHYST @ COP	2080' N/O FOSTER RD
E 4710, E 4750	BRADLEY RD SB	2080' N/O FOSTER RD	145' N/O AMETHYST @ COP
E 9405	VILLAGE DR	S BRADLEY RD	SHULTZ LN
E 9899	SHULTZ LN	VILLAGE DR	S BRADLEY RD



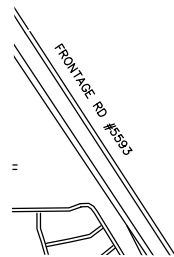
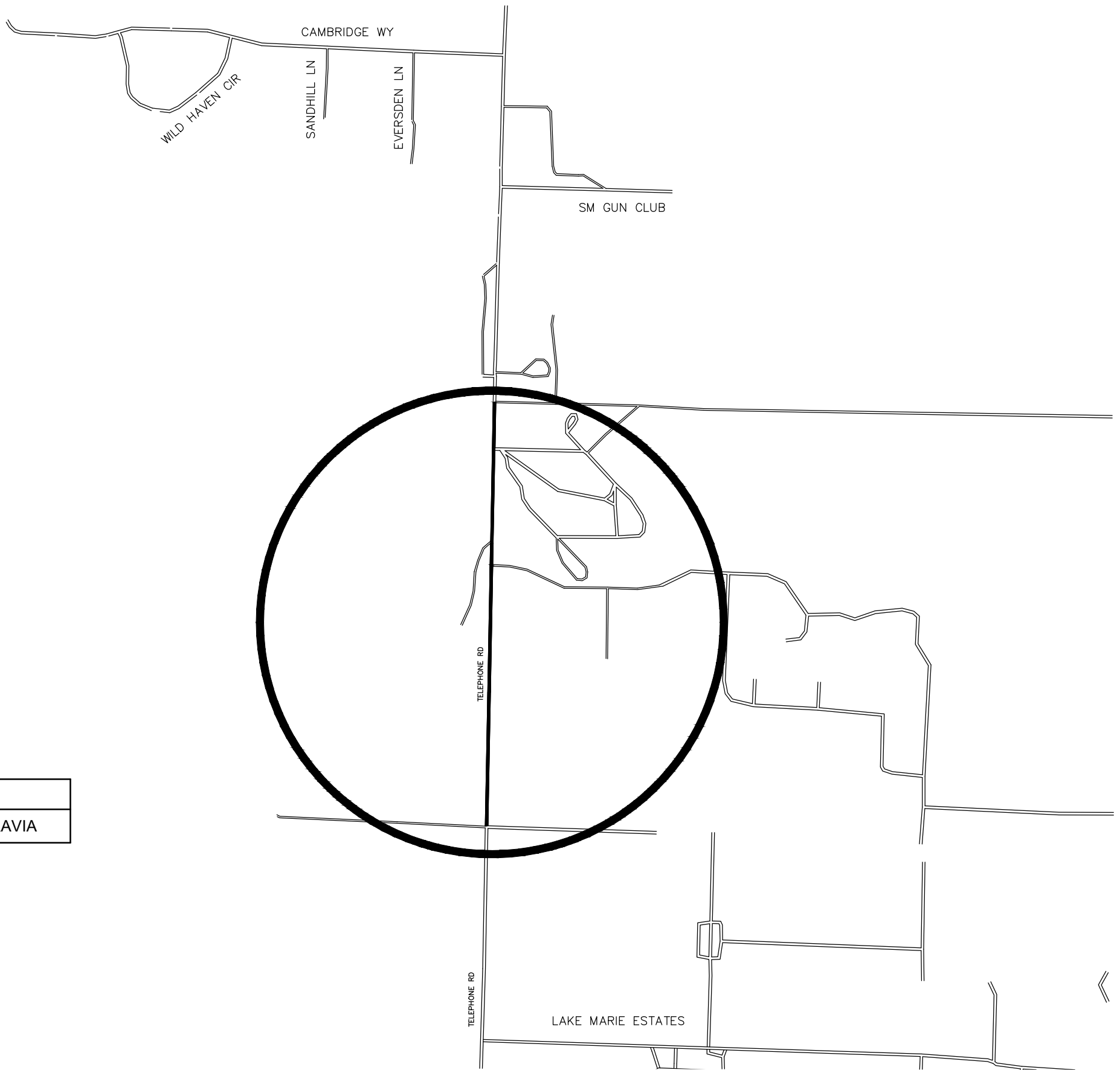
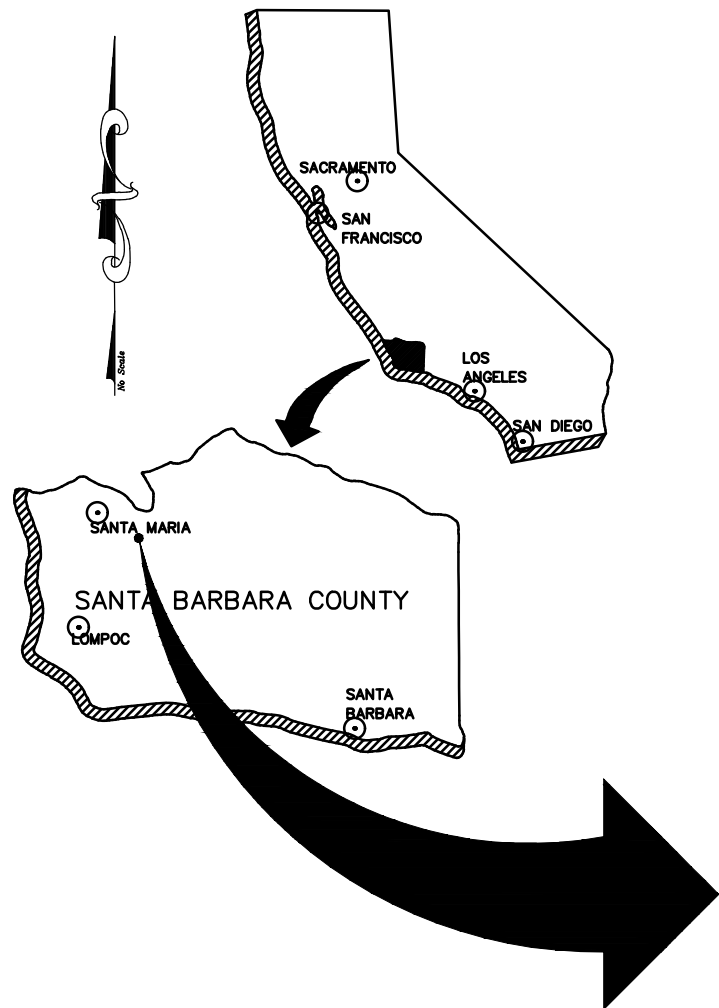

Section ID	Street Name	From	To
E 4890	TELEPHONE RD	2.0 MI S/O BETTERAVIA	3.0 MI S/O BETTERAVIA

