

LEGAL DESCRIPTION

Lot 1, in the County of Santa Barbara, State of California, as described in Lot Line Adjustment No. 94LLA-00000-00001 recorded June 12, 2013 as Instrument Number 2013-39458 of Official Records in the office of the County Recorder of said County.

APN 145-190-007

Agricultural Preserve
11AGP-00000-00019



Kenneth J. Wilson
7-24-2013



APPROVED AS TO FORM
AND SURVEY CONTENT

E. Tenell Matkovskiy
Deputy
COUNTY SURVEYOR
LICENSE EXP. 12/31/2015



POR. RANCHO SAN MARCOS

145-19

Agricultural Preserve
11AGP-00000-00019

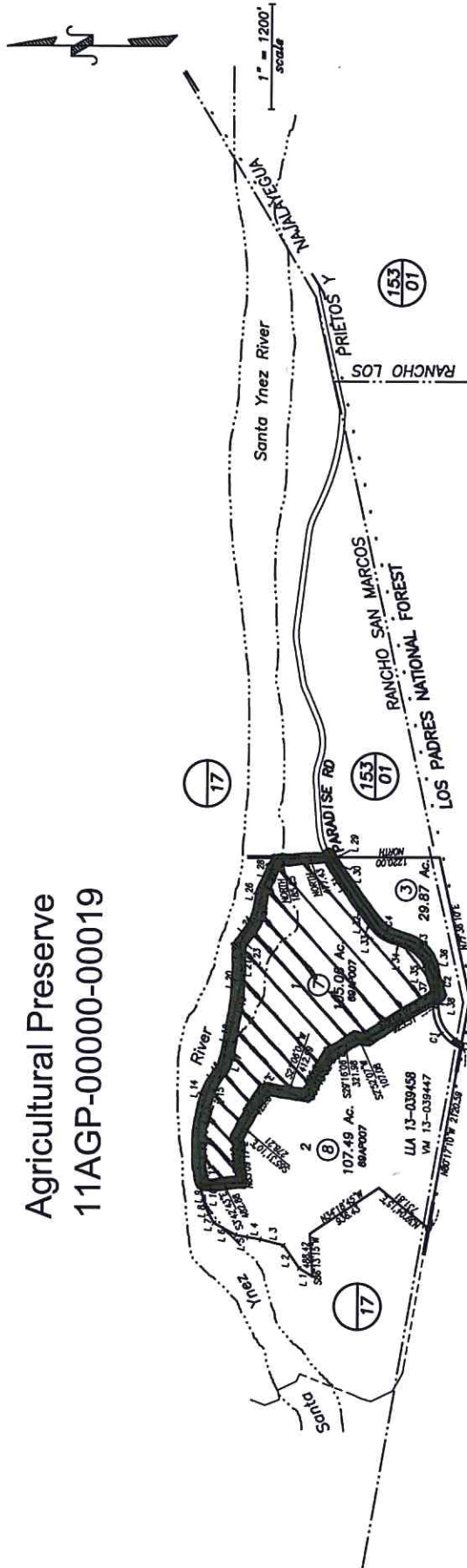

NO.	BEARING	DISTANCE	LINE TABLE	BEARING	DISTANCE	LINE TABLE	BEARING	DISTANCE	CURVE TABLE	LENGHT
L1	N22°30'20"E	170.00	L20	N63°21'23"W	109.30	C1	477.47	548.45		
L2	N54°42'01"E	318.71	L21	S89°07'44"W	174.73	C2	477.47	86.15		
L3	N14°14'50"E	288.88	L22	S85°11'35"W	183.44	C3	447.47	292.78		
L4	N5°45'30"E	124.12	L23	N69°14'27"W	77.00	C4	447.47	216.38		
L5	N5°45'30"E	124.12	L24	N69°14'27"W	77.00					
L6	S89°07'29"E	283.29	L25	N71°05'51"W	218.90					
L7	N57°39'25"E	114.68	L26	N82°29'43"W	151.65					
L8	N89°18'59"E	184.79	L27	N63°29'21"W	238.48					
L9	N77°12'00"E	38.40	L28	N79°43'35"W	143.03					
L10	N85°46'33"E	38.40	L29	N79°43'35"W	143.03					
L11	S89°07'29"E	283.29	L30	S20°01'	21.46					
L12	S89°44'05"W	451.44	L31	N57°06'30"E	636.89					
L13	N78°07'08"W	323.18	L32	N69°15'45"E	27.81					
L14	N72°18'27"W	103.89	L33	N57°06'30"E	308.84					
L15	N62°23'46"W	110.40	L34	N57°06'30"E	308.84					
L16	N57°52'27"W	270.00	L35	N12°33'00"E	47.80					
L17	N72°59'48"W	233.21	L36	N65°26'20"E	182.88					
L18	N72°59'48"W	233.21	L37	S89°08'00"E	184.29					
L19	N78°35'20"W	441.17	L38	N69°18'00"W	164.03					

NOTICE
Assessor's Parcels are for tax assessment purposes only and do not indicate either parcel legality or a valid building site.

Assessor's Map Bk, 145-Pg, 19
County of Santa Barbara, Calif.

12/13 2.3 & Per 170-36 Sub 7 & 8