

RECORDING REQUESTED BY:
Clerk of the Board
105 E. Anapamu St., Ste. 407
Santa Barbara, CA 93101

WHEN RECORDED MAIL TO:
Planning and Development
Attn: Tina Mitchell
624 W. Foster Rd., Ste. C
Santa Maria, CA 93455

(FOR RECORDER'S USE)

NOTICE OF NONRENEWAL

This is to notify the following named landowner(s) that the land conservation contract described below will not be renewed as of January 1, 2025.

Agricultural Preserve No. **84-AP-008**

Assessor's Parcel No(s). **131-070-046**

Current Owner(s) **Mann Living Trust; 1690 Country Hill Road, Nipomo, CA 93444**

Nonrenewal Date: **December 31, 2024**

The Contract designated described real property (**EXHIBIT A**) as **Agricultural Preserve Number 84-AP-008** and restricted the uses permitted on the below-described real property. The Contract is a matter of public record, recorded in the County of Santa Barbara on **December 28, 1984, as Instrument No. 1984-0069186.**

Pursuant to an action by the Board of Supervisors on October 15, 2024, the aforementioned agricultural preserve shall not be renewed as of the next automatic renewal date, nor considered renewed as provided in Section 51244 and 51244.5 of the Government Code, and the Land Conservation Agreement by and between Landowner and the County of Santa Barbara, entered into on January 1, 1985, shall be terminated effective December 31, 2033.

DATED: October 15, 2024

COUNTY OF SANTA BARBARA

By: 
Steve Lavagnino, Chair
Board of Supervisors

APPROVED AS TO FORM:

RACHEL VAN MULLEM
COUNTY COUNSEL

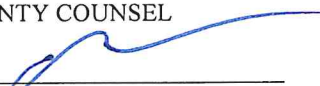
By: 
Tyler Sprague
Deputy County Counsel

CLERK OF THE BOARD

By: 
Sheila de la Guerra
Deputy Clerk

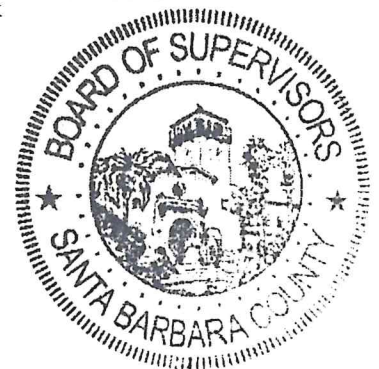

EXHIBIT A
Legal Description

AGRICULTURAL PRESERVE

24AGP-00008

LEGAL DESCRIPTION

A PORTION OF APN 131-070-046

ALL OF LOT 8 OF TENTATIVE TRACT #13,499, ADOPTED APRIL 2, 1984, BY THE BOARD OF SUPERVISORS OF SANTA BARBARA COUNTY, BEING A PORTION OF SECTION 19, IN TOWNSHIP 11 NORTH, RANGE 31 WEST OF THE SAN BERNARDINO BASELINE AND MERIDIAN, IN THE COUNTY OF SANTA BARBARA, STATE OF CALIFORNIA AND MORE PARTICULARLY DESCRIBED AS FOLLOWS:

BEGINNING AT A POINT ON THE SOUTH LINE OF SAID SECTION 19, DISTANT THEREON SOUTH 88°43'21" EAST, 1370.48 FEET FROM THE SOUTHWEST CORNER OF SAID SECTION 19; THENCE ALONG SAID SOUTH LINE, SOUTH 88°43'21" EAST, 3908.49 FEET TO THE SOUTHEAST CORNER OF SAID SECTION 19; THENCE ALONG THE EAST LINE OF SAID SECTION 19, NORTH 1°15'51" EAST, 1320.27 FEET TO THE NORTHEAST CORNER OF THE SOUTH ONE HALF OF THE SOUTHEAST ONE QUARTER OF SAID SECTION 19; THENCE ALONG THE NORTH LINE OF SAID SOUTH ONE HALF NORTH 88°42'46" WEST 659.73 FEET TO A POINT ON SAID NORTH LINE, BEING ALSO THE SOUTHEAST CORNER OF THE WEST ONE HALF OF THE NORTHEAST ONE QUARTER OF THE SOUTHEAST ONE QUARTER OF SAID SECTION 19; THENCE CONTINUING ALONG SAID NORTH LINE AND ITS WESTERLY PROLONGATION, NORTH 88°42'46" WEST, 2259.92 FEET TO A POINT; THENCE SOUTH 38°05'27" WEST 1649.73 FEET TO THE POINT OF BEGINNING.

CONTAINING 103.5 ACRES MORE OR LESS.

APPROVED AS TO FORM
AND SURVEY CONTENT

A Jevremovic

ALEKSANDAR JEVREMOVIC
COUNTY SURVEYOR



8 / 29 / 2024

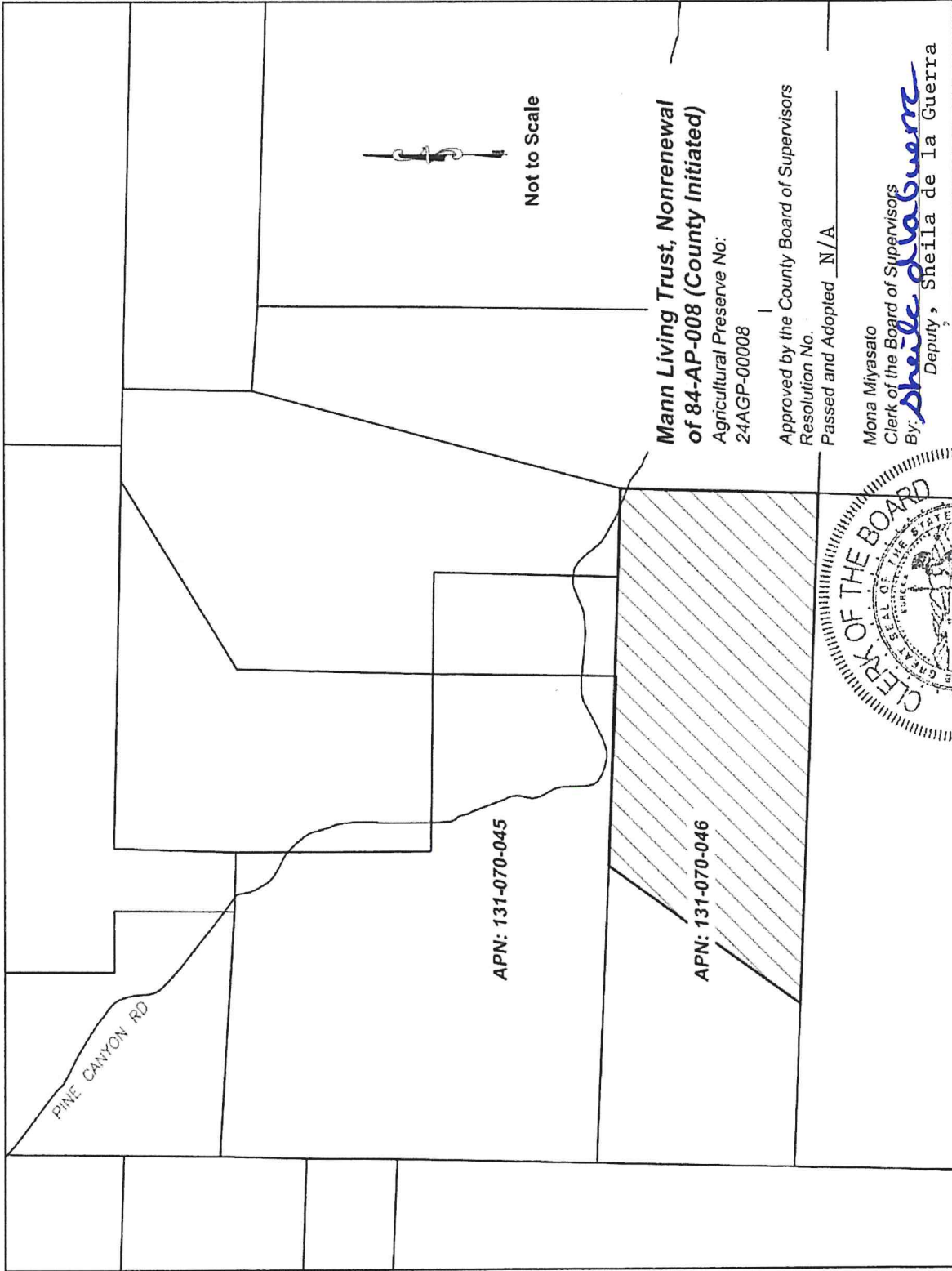

Not to Scale

**Mann Living Trust, Nonrenewal
of 84-AP-008 (County Initiated)**

Agricultural Preserve No:
24AGP-00008

Approved by the County Board of Supervisors
Resolution No. _____
Passed and Adopted N/A

Mona Miyasato
Clerk of the Board of Supervisors
By: *Sheila de la Guerra*
Deputy, Sheila de la Guerra

