

Agricultural Preserve
20AGP-00000-00005
Legal Description

Parcel One:

Parcel Two of Parcel Map No. 14,756, in the County of Santa Barbara, State of California, as per map recorded in Book 63 of Parcel Maps, Pages 73-75, in the office of the County Recorder of said County and State.

Parcel Two:

Parcel 2 of Parcel Map No. 14,322 in the County of Santa Barbara, State of California, as shown on map filed in Book 52, Page 6-10 of Parcel Maps in the Office of the County Recorder of said County.

APPROVED AS TO FORM
AND SURVEY CONTENT
AJevremovic
ALEKSANDAR JEVREMOVIC
COUNTY SURVEYOR
LICENSE EXP. 12/31/2021



7/29/2020

**HUB RUSSELL RANCH PROPERTIES, LLC
AGRICULTURAL PRESERVE REPLACEMENT**

Agricultural Preserve No: 20AGP-00000-00005

Approved by the County Board of Supervisors

Resolution No.

Passed and Adopted _____

Mona Miyasato

Clerk of the Board of Supervisors

By: _____

Deputy

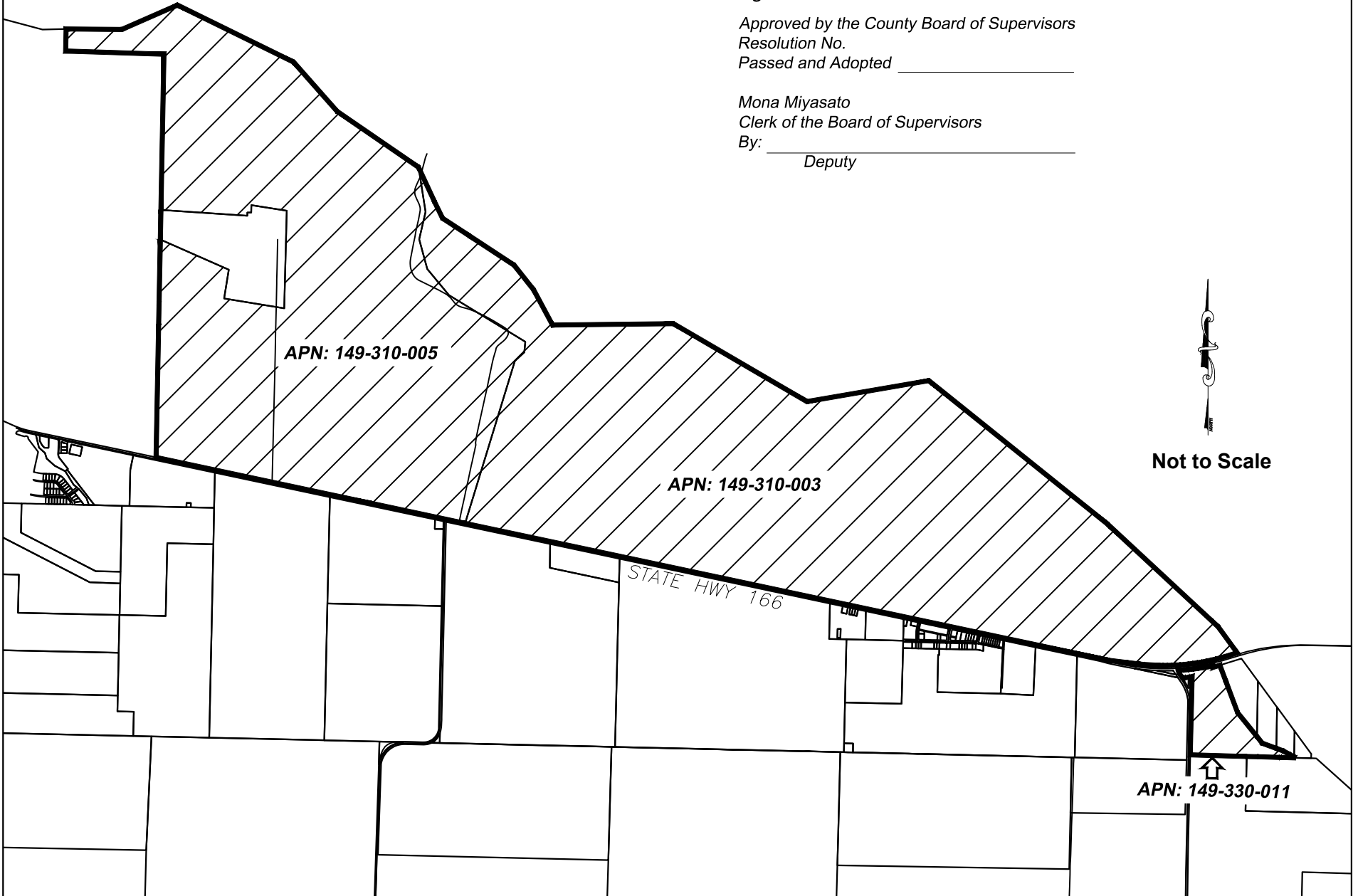

APN: 149-310-005

APN: 149-310-003

APN: 149-330-011

STATE HWY 166

Not to Scale