

Agricultural Preserve
20AGP-00000-00002
Legal Description

APNs: 099-230-025, 026

All that real property in the unincorporated area of the County of Santa Barbara, State of California, described as follows:

THAT CERTAIN TRACT OF LAND SHOWN AND DESIGNATED AS "285.204 ACRES" ON PARCEL MAP NO. 11602, FILED AUGUST 10, 1972, IN BOOK 10, PAGE 58 OF PARCEL MAPS IN THE OFFICE OF THE COUNTY RECORDER OF SAID COUNTY,

TOGETHER WITH,

THAT PORTION OF LOT 17, AS SHOWN ON SHEET NO. 2 OF A MAP OF A PORTION OF THE RANCHO SANTA ROSA AND ADJOINING LANDS AS SUBDIVIDED BY G.W. PRATT, RECORDED JULY 9, 1913 IN BOOK 2, PAGES 37 AND 38 OF MAPS AND SURVEYS, and SHOWN AS PARCEL C ON THE MAP FILED IN BOOK 86 OF RECORDS OF SURVEY, PAGE 28, IN THE OFFICE OF THE COUNTY RECORDER OF SAID COUNTY, DESCRIBED AS FOLLOWS:

BEGINNING AT THE SOUTHWEST CORNER OF THE TRACT OF LAND DESCRIBED AS "PARCEL ONE" IN THE DEED TO WILLIAM LEE RIECK, ET UX., RECORDED MAY 10, 1972 AS INSTRUMENT NO. 17022 IN BOOK 2399, PAGE 720 OF OFFICIAL RECORDS OF SAID COUNTY; BEING A POINT ON THE WEST LINE OF THE TRACT OF LAND IN DEED TO RUSSELL J. PESTER, ET UX., RECORDED OCTOBER 15, 1963 AS INSTRUMENT NO. 43920 IN BOOK 2017, PAGE 99 OF OFFICIAL RECORDS OF SAID COUNTY; THENCE ALONG THE SOUTH LINE OF SAID HEREINABOVE MENTIONED RIECK TRACT, EAST 1227.78 FEET TO THE SOUTHEASTERLY CORNER THEREOF, BEING A POINT ON THE WESTERLY LINE OF THE TRACT OF LAND DESCRIBED AS "PARCEL ONE" IN THE DEED TO JOHN R. CRAM, ET UX., RECORDED MAY 10, 1972 AS INSTRUMENT NO. 17024 IN BOOK 2399, PAGE 724 OF OFFICIAL RECORDS OF SAID COUNTY TO A SET 1/2" IRON PIPE TAGGED L.S. 2520; THENCE ALONG THE WESTERLY LINE OF SAID CRAM TRACT, SOUTH 61°19'37" WEST 305.00 FEET TO THE SOUTHWESTERLY CORNER THEREOF, BEING THE NORTHWESTERLY CORNER OF THE TRACT OF LAND DESCRIBED AS "PARCEL ONE" IN QUITCLAIM DEED TO WILLIAM R. YATES, ET UX., RECORDED MARCH 5, 1974 AS INSTRUMENT NO. 7620 IN BOOK 2504, PAGE 1456 OF OFFICIAL RECORDS OF SAID COUNTY; THENCE ALONG THE WESTERLY LINE OF SAID YATES TRACT THE FOLLOWING COURSES AND DISTANCES: SOUTH 41°09'37" WEST 324.53 FEET; SOUTH 44°26'35" WEST 510.79 FEET; AND SOUTH 16°19'05" EAST 409.53 FEET TO THE SOUTHWESTERLY CORNER THEREOF, BEING THE NORTHWESTERLY CORNER OF THE TRACT OF LAND DESCRIBED AS "PARCEL ONE" IN DEED TO ROBERT L. WEBB, RECORDED OCTOBER 8, 1974 AS INSTRUMENT NO. 36416 IN BOOK 2536, PAGE 967 OF OFFICIAL RECORDS OF SAID COUNTY; THENCE ALONG THE BOUNDARY LINES OF SAID WEBB TRACT THE FOLLOWING COURSES AND DISTANCES: SOUTH 16°19'05" EAST 415.44 FEET; SOUTH 33°14'28" WEST 490.25 FEET; SOUTH 25°53'30" EAST 523.41 FEET; SOUTH 14°42'22" EAST 326.48 FEET; SOUTH 04°45'21" EAST 380.49 FEET; SOUTH 23°24'40" EAST 231.39 FEET; SOUTH 43°06'36" EAST 522.69 FEET; SOUTH 19°43'53" EAST 282.44 FEET; SOUTH 49°18'14" WEST 429.86 FEET; NORTH 71°25'04" WEST 84.25 FEET;

Agricultural Preserve
20AGP-00000-00002
Legal Description

APNs: 099-230-025, 026

NORTH 25°20'41" WEST 883.54 FEET; AND NORTH 47°27'56" WEST 571.69 FEET TO A 1/2 INCH IRON PIPE MARKED L.S. 2520, BEING ON THE WESTERLY LINE OF SAID PESTER TRACT, THE FOLLOWING COURSES AND DISTANCES: NORTH 18°28'00" EAST 502.13 FEET; NORTH 05°32'00" WEST 2392.50 FEET; AND NORTH 06°04'00" WEST 287.67 FEET TO THE POINT OF BEGINNING.

THE ABOVE LEGAL DESCRIPTION IS PURSUANT TO THAT CERTIFICATE AND DECLARATION OF VOLUNTARY MERGER NO. 19-VM-04 RECORDED FEBRUARY 04, 2020 AS INSTRUMENT NO. 2020-5882 OF OFFICIAL RECORDS.

End Description

APPROVED AS TO FORM
AND SURVEY CONTENT

AJeyremovic
ALEKSANDAR JEYREMOVIC
COUNTY SURVEYOR
LICENSE EXP. _____



3/10/2020

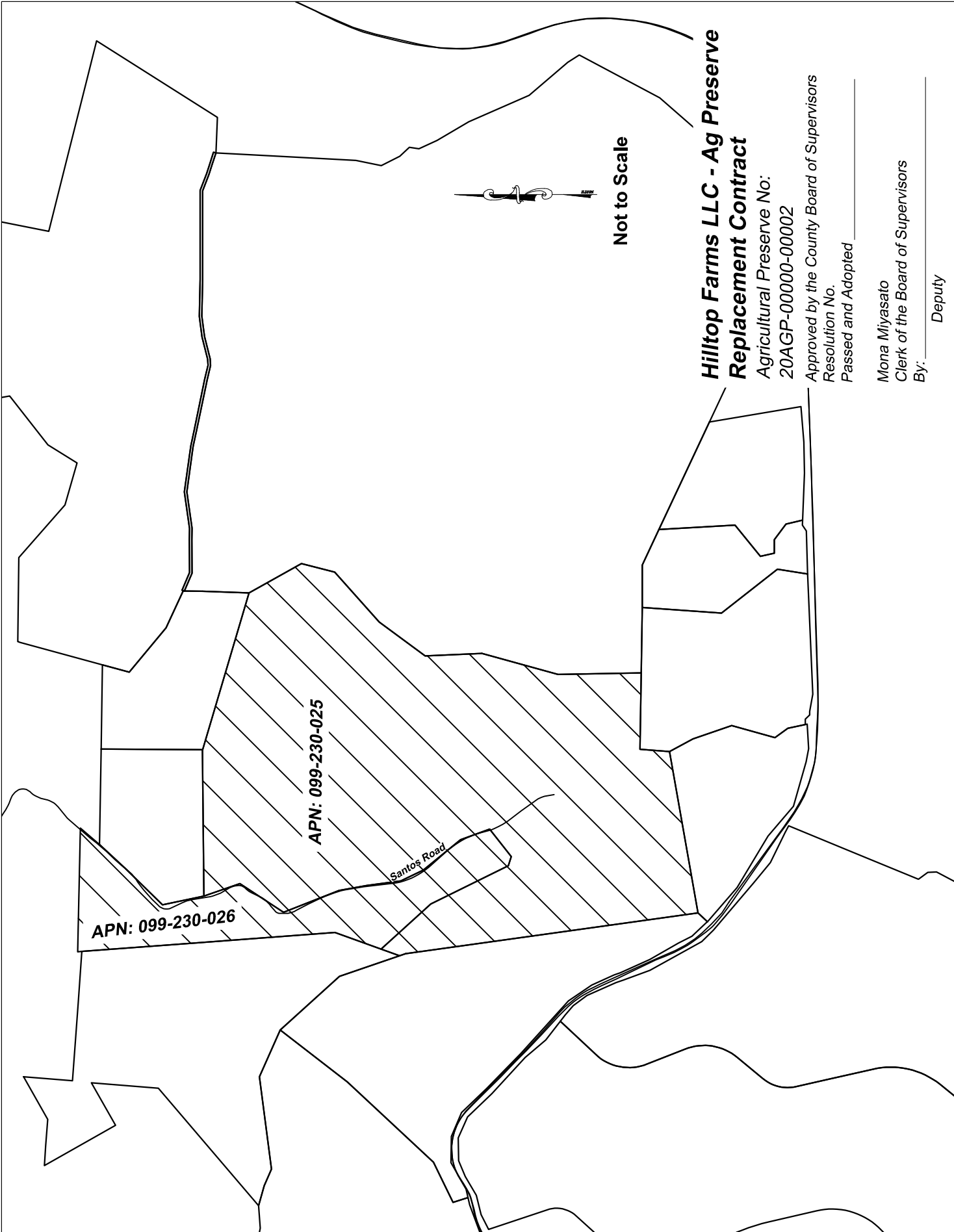

Not to Scale

**Hilltop Farms LLC - Ag Preserve
Replacement Contract**

Agricultural Preserve No:
20AGP-00000-00002

Approved by the County Board of Supervisors
Resolution No. _____
Passed and Adopted _____

Mona Miyasato
Clerk of the Board of Supervisors
By: _____ Deputy