

SANTA BARBARA COUNTY BUILDING & SAFETY DIVISION GRADING NOTES

1. ALL GRADING SHALL BE TO COUNTY OF SANTA BARBARA ORDINANCE NO. 447000 AS STATED. REQUIREMENTS FROM ANY OTHER JURISDICTIONS SHALL BE FOLLOADED. THE CONTRACTOR SHALL BE RESPONSIBLE FOR OBTAINING ALL NECESSARY PERMITS AND ENGINEERING APPROVALS. THE CONDITIONS OF APPROVAL, AND THE PERMIT CONDITIONS, SHALL BE REVIEWED AND UNDERSTOOD BY THE CONTRACTOR.
2. CONTRACTOR SHALL NOTIFY THE COUNTY GRADING INSPECTOR AND THE PROJECT ENGINEER AT LEAST 48 HOURS BEFORE COMMENCEMENT OF GRADING OPERATIONS AND THE LOCATION OF THE PRE-CONSTRUCTION CONFERENCE.
3. THE CONTRACTOR SHALL EMPLOY ALL LABOR, EQUIPMENT AND METHODS REQUIRED TO PREVENT HIS OPERATIONS FROM CAUSING DAMAGE TO ADJACENT PROPERTY, INCLUDING VEGETATION AND COSMETIC DAMAGES OR DAMAGE TO PUBLIC UTILITIES. THE CONTRACTOR SHALL BE RESPONSIBLE FOR ANY DAMAGE CAUSED BY DISTURBING FROM GRADING OPERATIONS.
4. BEFORE BEGINNING WORK, THE CONTRACTOR SHALL OBTAIN APPROVAL FROM THE COUNTY GRADING DIVISION AND THE COUNTY ENGINEER FOR THE GRADING PLAN AND THE COUNTY ENGINEER SHALL MONITOR HIS OPERATIONS WITH THE CONTRACTOR.
5. THE SOIL ENGINEER SHALL PROVIDE OBSERVATION AND TESTING OF MATERIALS. THE CONTRACTOR SHALL OBTAIN APPROVAL FROM THE COUNTY ENGINEER AND THE COUNTY GRADING DIVISION BEFORE GRADING OPERATIONS IN THE FIELD AND SHALL SUBMIT A FINAL REPORT TO THE COUNTY OF SANTA BARBARA SAFETY DIVISION AND PUBLIC WORKS INSPECTOR STATING THAT THE GRADING OPERATIONS HAVE BEEN COMPLETED. SOIL TESTS SHALL BE CONDUCTED AT NOT LESS THAN ONE TEST FOR EACH 15' SQUARE FOR EACH 500 CUBIC YARDS OF FILL.
6. AREAS TO BE GRADED SHALL BE CLEARED OF ALL VEGETATION, INCLUDING ROOTS AND ROOT STRUCTURES, AND OTHER UNSUITABLE MATERIAL SHALL BE REMOVED FROM THE PROJECT SITE AND TRANSPORTED TO A SUITABLE DISPOSAL AREA. PRIOR TO GRADING OPERATIONS, ALL EXISTING UTILITIES SHALL BE LOCATED AND MARKED BY THE COUNTY PUBLIC WORKS INSPECTOR (ALONG 48 HOUR MINIMUM ADVANCE NOTICE). THE AREAS SHALL BE PROTECTED BY THE COUNTY ENGINEER.
7. A THOROUGH SEARCH SHALL BE MADE FOR ALL ABANDONED MAN-MADE FEATURES SUCH AS SEPTIC TANK SYSTEMS, FUEL OR WATER STORAGE TANKS, AND OTHER SUCH FACILITIES. ENCOUNTERED SHALL BE REMOVED UNLESS OTHERWISE SPECIFIED IN THE GRADING PLAN. ALL EXISTING DRAINAGE SHALL BE MAINTAINED UNLESS OTHERWISE SPECIFIED IN THE GRADING PLAN. ALL EXISTING DRAINAGE SHALL BE MAINTAINED UNLESS OTHERWISE SPECIFIED IN THE GRADING PLAN. ALL EXISTING DRAINAGE SHALL BE MAINTAINED UNLESS OTHERWISE SPECIFIED IN THE GRADING PLAN.
8. AREAS WITH EXISTING SLOPES SHALL BE TO RECEIVE FILL MATERIAL SHALL BE AGED AND BENCHED TO THE DESIGN AND DETAIL. 80-113.
9. FILL MATERIAL SHALL BE SPREAD IN LAYS NOT EXCEEDING 6 INCHES IN COMPACTED THICKNESS. MOISTURE TO BE MAINTAINED AS NEARLY AS POSSIBLE TO THE MOISTURE CONTENT OF THE FILL MATERIAL. THE CONTRACTOR SHALL BE RESPONSIBLE FOR OBTAINING THE MOISTURE CONTENT OF THE FILL MATERIAL. THE CONTRACTOR SHALL BE RESPONSIBLE FOR OBTAINING THE MOISTURE CONTENT OF THE FILL MATERIAL.
10. THE CONTRACTOR SHALL BE RESPONSIBLE FOR OBTAINING THE MOISTURE CONTENT OF THE FILL MATERIAL. THE CONTRACTOR SHALL BE RESPONSIBLE FOR OBTAINING THE MOISTURE CONTENT OF THE FILL MATERIAL.
11. SURFACE DRAINAGE SHALL NOT BE LESS THAN 1% EXCEPT FOR PAVED SURFACES. A MINIMUM OF 2% FOR THE (S) TEST AWAY FROM THE FOUNDATION LINE OF ANY BUILDING OR STRUCTURE IS REQUIRED.
12. ALL TREES NOT DESIGNATED TO BE REMOVED AND TO REMAIN ON SITE SHALL BE PROTECTED FROM DAMAGE BY TEMPORARY REMOVAL AROUND THE GRADING DURING GRADING OPERATIONS.

GENERAL GRADING NOTES

1. GRADING SUPERVISION REQUIREMENTS SHALL BE COMPLETED AS FOLLOWS:
 - A. THE PROJECT ENGINEER SHALL BE A REPRESENTATIVE OF PERFIELD & SMITH.
 - B. LINE AND GRADE STAKES SHALL BE SET BY THE SUPERVISOR UNDER THE GENERAL SUPERVISION OF THE PROJECT ENGINEER. THE PROJECT ENGINEER SHALL PROVIDE GENERAL CONSTRUCTION REVIEW.
 - C. THE SOILS ENGINEER SHALL PROVIDE GENERAL REVIEW OF THE GRADING AND SURFACE PREPARATION AND FINISHES. THE SOILS ENGINEER SHALL BE RESPONSIBLE TO ENSURE QUALITY CONSTRUCTION AND COMPLY WITH THE GRADING ORDINANCE.
 - D. THE SOILS ENGINEER SHALL PROVIDE GENERAL REVIEW OF THE GRADING AND SURFACE PREPARATION, PERFORM CONSTRUCTION TESTING, PERFORM IN PLACE TESTING, RECOMMEND THE STRUCTURAL SECTION FOR THE PRIVATE STREET TO BE CONSTRUCTED AND PROVIDE A PRELIMINARY FOUNDATION INVESTIGATION REPORT BY EXISTING SYSTEMS.
2. IN ADDITION TO THESE NOTES, ALL REQUIREMENTS CONTAINED IN THE SOILS REPORT PREPARED FOR THIS PROJECT BY PERFIELD & SMITH SHALL BE FOLLOADED.
3. SUPERVISION SERVICE AGENT (S.S.A.) SHALL BE CONTACTED AT (805) 422-4133 (9MT-DEPT) (48) HOURS PRIOR TO START OF ANY GRADING OPERATIONS.
4. PRIOR TO ANY CONSTRUCTION, A GRADING PERMIT SHALL BE OBTAINED FROM THE SANTA BARBARA COUNTY PLANNING AND DEVELOPMENT GRADING DIVISION.
5. MOST GRADING CONSTRUCTION ACTIVITIES SHALL BE LIMITED TO THE HOURS OF 7:00 AM TO 7:00 PM, MONDAY THROUGH FRIDAY. CONSTRUCTION EQUIPMENT THAT GENERATES NOISE WHICH EXCEEDS 65 DB AT THE PROJECT BOUNDARIES SHALL BE SHIELDED TO THE COUNTY'S SATISFACTION AND SHALL BE LOCATED AT A MINIMUM OF 50 FEET FROM OCCUPIED RESIDENCES.
6. STONES LARGER THAN 6 INCHES IN DIAMETER SHALL NOT BE PLACED IN THE FILL AND NO STONES LARGER THAN 6 INCHES IN DIAMETER SHALL BE PLACED IN THE FILL OR ON TOP OF THE FILL.
7. EARLY WORKING AND WORKING OPERATIONS SHALL BE CONDUCTED TO PREVENT WATER FROM RUNNING AND ESCAPING FROM THE WORK AREA. ANY EROSION CONTROL MEASURES SHALL BE THOROUGHLY MAINTAINED THROUGHOUT THE PROJECT.
8. WHEN THE MOISTURE CONTENT OF THE FILL MATERIAL IS NOT SUFFICIENT TO ACHIEVE REQUIRED COMPACTION, WATER SHALL BE ADDED UNTIL THE SOILS AT A MINIMUM MOISTURE CONTENT SO THAT THOROUGH BONDING IS ACHIEVED DURING THE GRADING OPERATIONS. THE CONTRACTOR SHALL BE RESPONSIBLE FOR OBTAINING THE MOISTURE CONTENT OF THE FILL MATERIAL AND NOTIFY THE COUNTY ENGINEER PRIOR TO CONSTRUCTION OF THE FILLING. THE CONTRACTOR SHALL BE RESPONSIBLE FOR OBTAINING THE MOISTURE CONTENT OF THE FILL MATERIAL.
9. THE CONTRACTOR SHALL BE RESPONSIBLE FOR OBTAINING THE MOISTURE CONTENT OF THE FILL MATERIAL. THE CONTRACTOR SHALL BE RESPONSIBLE FOR OBTAINING THE MOISTURE CONTENT OF THE FILL MATERIAL.
10. REPORT OR ONE-SITE TESTS USED IN FILL OPERATIONS SHALL BE FREE FROM ORGANIC MATERIAL AND OTHER DELETERIOUS MATERIALS. THE CONTRACTOR SHALL BE RESPONSIBLE FOR OBTAINING THE MOISTURE CONTENT OF THE FILL MATERIAL.
11. THE CONTRACTOR SHALL BE RESPONSIBLE FOR OBTAINING THE MOISTURE CONTENT OF THE FILL MATERIAL. THE CONTRACTOR SHALL BE RESPONSIBLE FOR OBTAINING THE MOISTURE CONTENT OF THE FILL MATERIAL.
12. THE COMPACTOR STAMPS SHALL BE THE ASTM D 1557-78 METHOD OF COMPACTION.
13. THE CONTRACTOR SHALL BE RESPONSIBLE FOR OBTAINING THE MOISTURE CONTENT OF THE FILL MATERIAL. THE CONTRACTOR SHALL BE RESPONSIBLE FOR OBTAINING THE MOISTURE CONTENT OF THE FILL MATERIAL.
14. IN PAVED AREAS AND ALLWAYS, THE TOP 12 INCHES OF SUBGRADE SOILS SHALL BE REMOVED AND COMPACTED TO A MINIMUM OF 95% RELATIVE COMPACTION PRIOR TO FILL PLACEMENT.
15. IN STREETS AND DRIVEWAYS AND/OR PARKING AREAS, THE TOP 12 INCHES OF SUBGRADE SOILS SHALL BE REMOVED AND COMPACTED TO A MINIMUM OF 95% RELATIVE COMPACTION.

11CDH-00000-00006 AS-BUILT GRADING AND MODIFICATIONS TO THE HABITAT RESTORATION AND REVEGETATION PLAN 2825 PADARO LANE SUMMERLAND, SANTA BARBARA COUNTY, CA

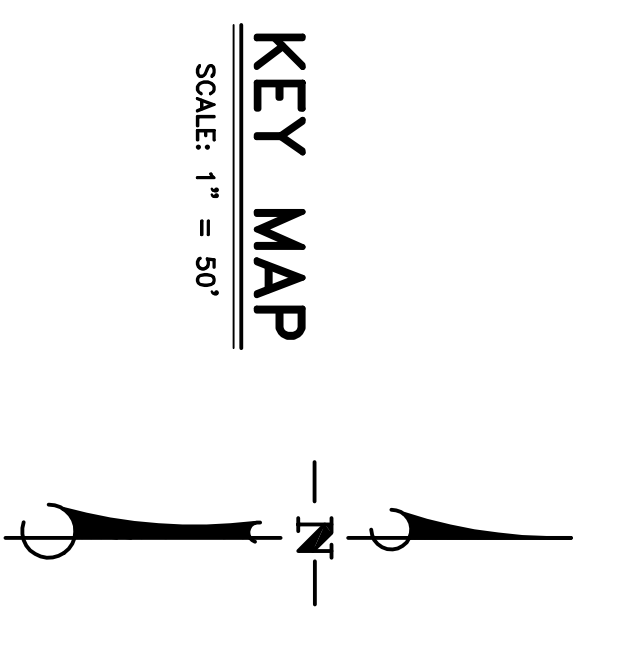

- ### SHEET INDEX
1. TITLE & NOTES
 2. EXISTING PROPOSED SLOPE STABILIZATION PLAN
 3. PROPOSED SLOPE STABILIZATION PLAN
 4. CROSS SECTIONS AND PICTURES
 5. EXCAVATED SOIL RELOCATION EXHIBIT - PERFORMED IN 2010

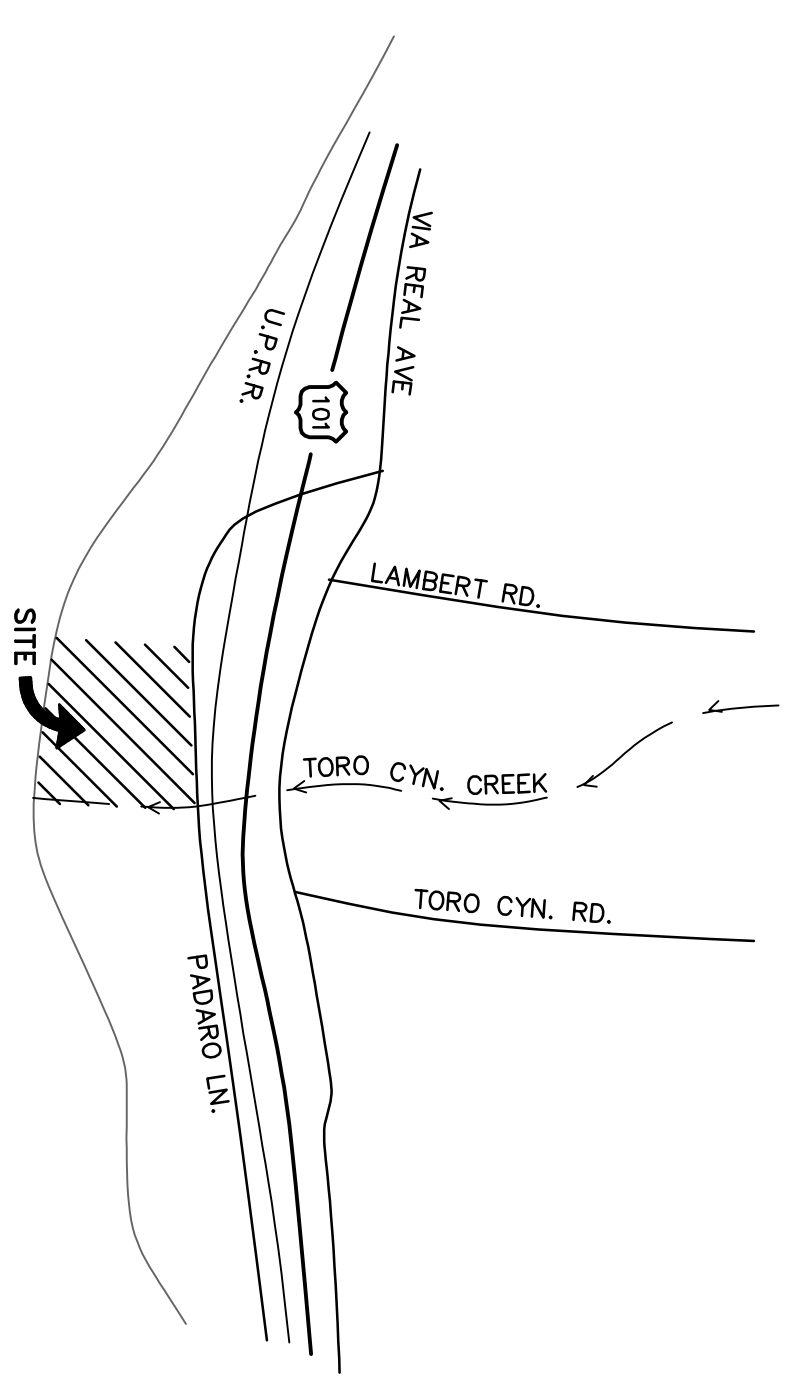

SURVEYOR'S NOTES

1. BOUNDARY: THE BOUNDARY INFORMATION SHOWN HEREON WAS COMPILER FROM RECORD DATA, MEASUREMENTS OF RECORD IN ORDER TO OBTAIN THE GEOSPATIAL AND PLANNING BOUNDARY ESTABLISHMENT SURVEY. THE BOUNDARY INFORMATION SHOWN HEREON IS THE PROPERTY OF PERFIELD & SMITH.
2. WARNING: THIS SURVEY WAS COMPILED BY A SURVEYOR OF 1st CLASS WITH A LICENSE NO. 11279. THE SURVEY WAS COMPILED IN ACCORDANCE WITH THE SURVEYING PROFESSIONAL BOARD'S REGULATIONS. THE SURVEYOR IS NOT RESPONSIBLE FOR ANY DAMAGE CAUSED BY THIS SURVEY. THE SURVEYOR IS NOT RESPONSIBLE FOR ANY DAMAGE CAUSED BY THIS SURVEY.
3. BASIS OF BEASONS: THE BASIS OF BEASONS FOR THIS SURVEY IS SOUTH 8833'18" EAST FROM A POINT REPORTED IN BOOK 234 PAGE 72-73 IN THE OFFICE OF THE COUNTY SURVEYOR IN THE COUNTY OF SANTA BARBARA, CALIFORNIA.
4. VERTICAL DATUM: THE ELEVATIONS SHOWN HEREON ARE HIGHER BASED UPON THE 1988 datum. THE ELEVATIONS SHOWN HEREON ARE HIGHER BASED UPON THE 1988 datum. THE ELEVATIONS SHOWN HEREON ARE HIGHER BASED UPON THE 1988 datum.
5. SITE INFORMATION: APN 005-260-016, COUNTY OF SANTA BARBARA

PROJECT CONTACTS

OWNERS: 2825 BEZUCHILUB FAMILY TRUST
ARCHITECT: MARK WYMAN
MARK WYMAN DESIGN, LLC
PACIFIC PALMSIDES, CA 90272
(917) 641-4600
ENGINEER: PETER JENISON
PETER JENISON CONSULTANTS
SANTA BARBARA, CA 93101
(805) 965-7532

LEGEND

- PROPERTY BOUNDARY
- TITLE BOUNDARY
- 7' BUFFER SETBACK AND COUNCIL COMMISSION ACTION OF SHEET SETBACK
- BLUFF RIMMAY SETBACK
- PROPOSED MAJOR CONTOUR PARCEL B
- EXISTING MAJOR CONTOUR
- PROPOSED CONTOUR PARCEL A
- EXISTING CONTOUR
- EXISTING UTILITY POLE
- PROPOSED FLOWLINE
- EXISTING FLOWLINE
- PROPOSED FENCE
- EXISTING FENCE
- EXISTING WATERLINE
- EXISTING OVERHEAD WIRE
- EXISTING WALL
- PROPOSED WALL

NO.	DATE	REVISIONS

DESIGNED BY: PETER JENISON
CHECKED BY: JENISON
NO. 2981

COUNTY OF SANTA BARBARA, CA
DRAWN BY: PETER JENISON
DATE: 11/26/2013

PROJECT NO. 17189.03
SHEET 1 OF 5
PLAN DATE 11/26/2013