

ATTACHMENT-8 COASTAL LAND USE PLAN AMENDMENT

RESOLUTION OF THE BOARD OF SUPERVISORS
COUNTY OF SANTA BARBARA, STATE OF CALIFORNIA

IN THE MATTER OF ADOPTING A SPECIFIC)
AMENDMENT TO THE COASTAL LAND USE PLAN) RESOLUTION NO. 18 ~~4~~45
OF THE SANTA BARBARA COUNTY LOCAL COASTAL)
PROGRAM BY THE ADOPTION OF A NEW SITE)
SPECIFIC LAND USE DESIGNATION.) Case No.: 08GPA-00000-00007
_____)

WITH REFERENCE TO THE FOLLOWING:

- A. On January 7, 1980, by Resolution No. 80-12, the Board of Supervisors of the County of Santa Barbara adopted the Santa Barbara County Coastal Land Use Plan.
- B. On December 20, 1980, by Resolution No. 80-566, the Board of Supervisors adopted the Land Use Element of the Comprehensive Plan for the County of Santa Barbara.
- C. In 1992, the Board of Supervisors adopted the Summerland Community Plan as an amendment to the Comprehensive Plan.
- D. On May 6, 2014, by Resolution No. 14-118, the Board of Supervisors adopted an amendment for Land Use Element updates to the Summerland Community Plan.
- E. On May 6, 2014, by Resolution No. 14-119, the Board of Supervisors adopted an amendment for Coastal Land Use Plan updates to the Summerland Community Plan.
- F. On May 17, 2016, the Board adopted Resolution No. 16-130 accepting and agreeing to the eight California Coastal Commission Modifications to the Summerland Community Plan modifications, and adopted the Coastal Land Use Plan updates to the Summerland Community Plan with the suggested modifications.
- G. Citizens, California Native American Indian tribes, public agencies, public utility companies, and civic, education, and other community groups have been provided the opportunity for involvement in compliance with Government Code Section 65351.
- H. The County contacted and offered to conduct consultations with California Native American tribes in compliance with Government Code Sections 65352.3 and 65352.4.
- I. The proposed amendment is consistent with the Coastal Act of 1976, the Santa Barbara County Coastal Land Use Plan, the Santa Barbara County Comprehensive Plan including the Summerland Community Plan, and the requirements of California Planning, Zoning, and Development laws.
- J. The County Planning Commission held duly noticed public hearings, as required by Government Code Section 65353, on the proposed amendments, at which hearings the amendments were explained and comments invited from the persons in attendance.

- K. The Planning Commission, after holding duly noticed public hearings on the above described amendments to the Comprehensive Plan, and transmits to the Board of Supervisors said recommended amendments in compliance with Government Code Section 65354.
- L. The Board received and considered the recommended actions and held a duly noticed public hearing, as required by Government Code Section 65353, on the proposed O'Neil amendment at which hearing the amendment was explained and comments invited from the persons in attendance.
- M. In compliance with Government Code Section 65350.5, before a substantial amendment of the Comprehensive Plan, the Board is required to review and consider a groundwater sustainability plan or groundwater management plan, an adjudication of water rights, and/or an order or interim plan by the State Water Resources Control Board; however, such plans do not exist at the time of this action, thus the Board has satisfied its duties pursuant to Government Code Section 65350.5.

NOW, THEREFORE, IT IS HEREBY RESOLVED as follows:

- 1. The above recitations are true and correct.
- 2. The Board of Supervisors now finds, consistent with its authority in Government Code Section 65358, that it is in the public interest to provide orderly development of the County and important to the preservation of the health, safety, and general welfare of the residents of the County to:
 - a. Amend the maps of the Coastal Land Use Plan of the Santa Barbara County Local Coastal Program as follows:
 - (1) Amend the map titled Summerland Community Plan Land Use Designation Map which depicts the land use designations within the Summerland Community Plan area, to amend the land use designation of 2551 Wallace Avenue (Assessor's Parcel Number 005-250-001) (Exhibit A) from Recreation/Open Space to Residential-4.6 Units Per Acre.
- 3. In compliance with the provisions of Government Code Section 65356, the above described changes are hereby adopted as amendments to the Coastal Land Use Plan of the Santa Barbara County Local Coastal Program.
- 4. Pursuant to provisions of Government Code Section 65357, the Clerk of the Board is hereby described to make the documents amending the Santa Barbara County Comprehensive Plan, including the diagrams and text, available to the public for inspection.
- 5. The Chair and the Clerk of this Board are hereby authorized and directed to sign and certify all maps, documents, and other materials in accordance with this Resolution to reflect the above described action by the Board.
- 6. Pursuant to the provisions of Government Code Section 65357 the Clerk of the Board is hereby authorized and directed to send endorsed copies of said maps to the planning agency of each city within this County.

7
011602
A#8

PASSED, APPROVED AND ADOPTED by the Board of Supervisors of the County of Santa Barbara, State of California, this 27th day of February, 2018, by the following vote:

AYES: Supervisor Williams, Supervisor Adam, and Supervisor Lavagnino

NOES: Supervisor Wolf

ABSTAINED: None

ABSENT: Supervisor Hartmann

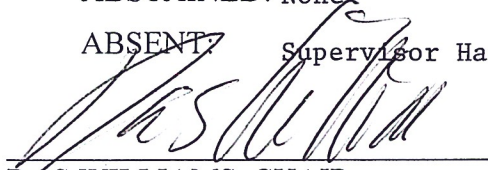

DAS WILLIAMS, CHAIR
BOARD OF SUPERVISORS
COUNTY OF SANTA BARBARA

MONA MIYASATO, COUNTY EXECUTIVE OFFICER
CLERK OF THE BOARD

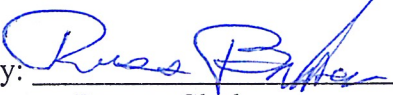
By: 
Deputy Clerk

APPROVED AS TO FORM:

MICHAEL C. GHIZZONI
COUNTY COUNSEL

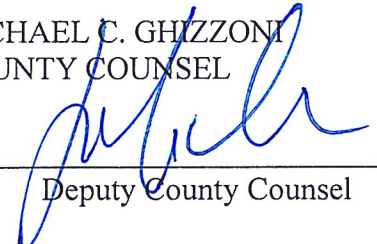
By: 
Deputy County Counsel

Exhibits:

Exhibit A Land Use Designation Change to Summerland Community Plan Land Use Designation Map

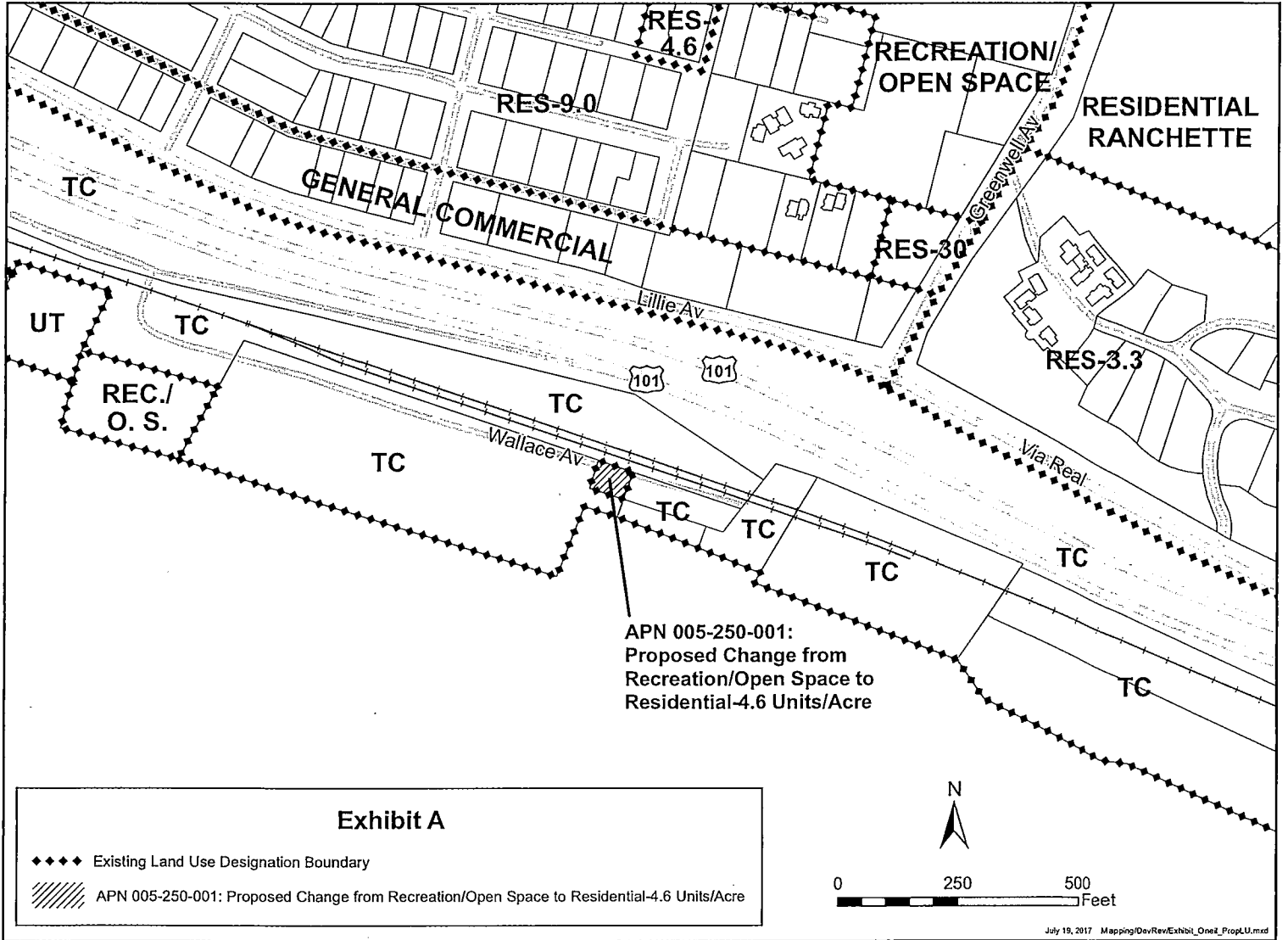

APN 005-250-001:
 Proposed Change from
 Recreation/Open Space to
 Residential-4.6 Units/Acre

Exhibit A

- ◆◆◆◆ Existing Land Use Designation Boundary
- ▨▨▨▨ APN 005-250-001: Proposed Change from Recreation/Open Space to Residential-4.6 Units/Acre

