

ORDINANCE NO. _____

AN ORDINANCE AMENDING SECTIONS 23-14., 23-15., 23-15.1., 23-15.2., 23-15.3., 23-15.4., 23-15.5., 23-15.6. AND 23-15.7. OF THE SANTA BARBARA COUNTY CODE, CALIFORNIA, REGARDING SPEED LIMITS AND THE CHANGING OF SPEED LIMITS ON CERTAIN COUNTY ROADS;

PLACING ANITA LANE (FROM A POINT 355 FEET WEST OF SAN MARCOS ROAD TO INWOOD DRIVE) WITHIN A 15 MILE PER HOUR SPEED LIMIT DESIGNATION;

PLACING PINAL AVENUE, (FROM A POINT 100 FEET WEST OF GRAY STREET TO OAK STREET) WITHIN A 15 MILE PER HOUR SPEED LIMIT DESIGNATION;

REMOVING SAN ANTONIO CREEK ROAD (BETWEEN CATHEDRAL OAKS ROAD AND A POINT ONE THOUSAND FIFTY-SIX FEET NORTH OF THE CATHEDRAL OAKS ROAD) FROM A 20 MILE PER HOUR SPEED LIMIT DESIGNATION;

PLACING ALSTON ROAD (FROM THE SANTA BARBARA CITY LIMITS TO HOT SPRINGS ROAD) WITHIN A 35 MILE PER HOUR SPEED LIMIT DESIGNATION;

REMOVING MARINA DRIVE (FROM ROBLE DRIVE TO THE WESTERLY CITY LIMITS OF THE CITY OF SANTA BARBARA) FROM A 35 MILE PER HOUR SPEED LIMIT DESIGNATION;

PLACING MARINA DRIVE (FROM ROBLE DRIVE TO CLIFF DRIVE) WITHIN A 40 MILE PER HOUR SPEED LIMIT DESIGNATION;

The Board of Supervisors of the County of Santa Barbara ordains as follows:

SECTION 1

Section 23-14. of the County Code of the County of Santa Barbara is hereby amended to provide as follows:

Section 23-14. Alteration of Speed Limits.

It is hereby determined, pursuant to applicable California Vehicle Code sections, that the speeds permitted by state law upon the highways hereafter designated in this chapter are greater or less than is reasonable or safe under the conditions found to exist upon such highways. It is hereby declared that the prima facie speed limits shall be as designated in this article, effective when signs are erected giving notice thereof, pursuant to the provisions of sections 22357, 22357.1, 22358, 22358.3, 22358.4 and 22358.5 of the California Vehicle Code and any amendments or successors thereto.

SECTION 2

Section 23-15. of the County Code of the County of Santa Barbara is hereby amended to provide as follows:

Section 23-15. Fifteen Miles per Hour Speed Limit. The speed limit for the highways or portions thereof designated in this section is hereby determined and declared to be fifteen miles per hour.

ANITA LANE, from a point 355 feet west of San Marcos Road to Inwood Drive.
PINAL AVENUE, from a point 100 feet west of Gray Street to Oak Street.

SECTION 3

Section 23-15.1. of the County Code of the County of Santa Barbara is hereby amended to provide as follows:

Section 23-15.1. Twenty Miles per Hour Speed Limit. The speed limit for the highways or portions thereof designated in this section is hereby determined and declared to be twenty miles per hour.

NO ROADS ARE CURRENTLY DESIGNATED TWENTY MILES PER HOUR

SECTION 4

Section 23-15.2. of the County Code of the County of Santa Barbara is hereby amended to provide as follows:

Section 23-15.2. Twenty-five Miles per Hour Speed Limit. The speed limit for the highways or portions thereof designated in this section is hereby determined and declared to be twenty-five miles per hour.

BASELINE AVENUE, between Alamo Pintado Road and a point eighteen hundred feet easterly thereof.

CAMINO CORTO, from Estero Road to Del Playa Drive.

CAMINO DEL SUR, from El Colegio to Del Playa Drive.

CAMINO PESCADERO, from El Colegio to Del Playa Drive.

CHANNEL DRIVE, from Butterfly Lane to Hill Road.

EUCALYPTUS LANE, between south Jameson Lane and Miramar Avenue.

MAIN STREET, from Den Street to Bell Street.

SECTION 5

Section 23-15.3. of the County Code of the County of Santa Barbara is hereby amended to provide as follows:

Section 23-15.3. Thirty Miles per Hour Speed Limit. The speed limit for the highways or portions thereof designated in this section is hereby determined and declared to be thirty miles per hour.

BRADLEY ROAD, from Rice Ranch Road to Stubblefield Road.
BROADWAY, from Rice Ranch Road to Clark Avenue.
CALIFORNIA BLVD, from Broadway to the Santa Maria city limits.
CALZADA AVENUE, from Pine Street to Cimmaron Drive.
CAMINO CORTO, from El Colegio to Estero Road.
CLARK AVENUE, from a point three hundred and fifty feet west of Broadway to Norris Street.
COUNTRY ROAD, from Refugio Road to Calzada Avenue.
HOPE AVENUE, from Sterrett Avenue to State Street (Those portions within the unincorporated territory of the county).
LAS CANOAS ROAD, from Mission Canyon Road to the Santa Barbara City Limits.
MIDDLE ROAD, between the city limits of Santa Barbara and Hot Springs Road.
NOGAL DRIVE, from Vieja Drive to Hollister Avenue.
OLIVE MILL ROAD, from Hill Road to Coast Village Road (Those portions within the unincorporated territory of the county).
ORCUTT ROAD, from Waller Lane to Goodwin Road.
PARK LANE, from State Route 192 to Mountain Drive.
PICACHO LANE, from East Valley Road (State Route 192) to Mountain Drive.
ROMERO CANYON ROAD, from State Route 192 to Lilac Drive.
SAMANTHA DRIVE, from Refugio Road to Calzada Avenue.
SAN MARCOS ROAD, from Calle Real to Cathedral Oaks Road.
SAN YSIDRO ROAD, from State Route 192 to Bolero Drive.
VEREDA DEL PADRE, between Farren Road and Vereda Leyenda.
VEREDA LEYENDA, from Calle Real to its northerly terminus.

SECTION 6

Section 23-15.4. of the County Code of the County of Santa Barbara, is hereby amended to provide as follows:

Section 23-15.4. Thirty-Five Miles Per Hour Speed Limit. The speed limit for the highways or portions thereof designated in this section is hereby determined and declared to be thirty-five miles per hour.

ALSTON ROAD, from the Santa Barbara City Limits to Hot Springs Road.
BARKER PASS ROAD, between Sycamore Canyon Road and the city limits of the City of Santa Barbara.
BRADLEY ROAD, from 150 feet north of the centerline of Amethyst Drive to Via Mavis.
BROADWAY, from Rice Ranch Road to California Boulevard.
BURTON MESA BOULEVARD, between eight hundred feet east of Arneb Avenue and Apollo Way.
CAMINO VIEJO, between Sycamore Canyon Road and the easterly city limits of the City of Santa Barbara.
CIENEGUITAS ROAD, between Foothill Road (State Route 192) and its northerly terminus.
CLARK AVENUE, from El Portal Street to Leon Street.
COLD SPRINGS ROAD, from Sycamore Canyon Road (State Route 192) to La Paz Road.
CONSTELLATION ROAD, from Jupiter Avenue to Sirius Avenue.
EDISON STREET, from Tivola Street to two hundred feet north of Lindero Street.

EL COLEGIO, from Storke Road to the west boundary of the University of California.

GRAND AVENUE, from Roblar Avenue to Hollister Street.

HOT SPRINGS ROAD, between the city limits of the City of Santa Barbara and East Valley Road (State Route 192).

KELLOGG AVENUE, from the Goleta City Limits to Cathedral Oaks Road.

LA CUMBRE ROAD, between the northerly city limits of the City of Santa Barbara, approximately one hundred forty feet north of the centerline of Stacy Lane and Foothill Road.

LAS PALMAS DRIVE, from Paloma Drive to Roble Drive.

MISSION CANYON ROAD, from Foothill Road (State Route 192) to the northerly city limits of the City of Santa Barbara.

MODOC ROAD, from Hollister Avenue to seven hundred seventy-five feet east of Vista Clara Road.

OLIVE MILL ROAD, from Coast Village Road to Hot Springs Road (Those portions within the unincorporated territory of the County of Santa Barbara).

ORCUTT ROAD, from State Route 135 to Lakeview Road.

ORTEGA RIDGE ROAD, from Ortega Hill Road to State Route 192.

PATTERSON AVENUE, between Cathedral Oaks Road and Cambridge Drive.

PATTERSON ROAD, from Orcutt Road to Bradley Road.

PUENTE DRIVE, between Hollister Avenue and Via Huerto.

REFUGIO ROAD, from Redondo Court to Deer Trail Lane (south).

ROBLE DRIVE, from Las Palmas Drive to Marina Drive.

SAINT ANDREWS WAY, between Clubhouse Road and Oak Hill Drive.

SAN LEANDRO LANE, from Santa Rosa Lane to Sheffield Drive.

SAN YSIDRO ROAD, from East Valley Road, (State Route 192) to North Jameson Lane.

SAN YSIDRO ROAD, from Bolero Drive to Mountain Drive.

SHEFFIELD DRIVE, from East Valley Road (State Route 192) to North Jameson Lane.

SYCAMORE CANYON ROAD, between Hot Springs Road and East Valley Road.

TORO CANYON ROAD, from Via Real to State Route 192.

TURNPIKE ROAD, from Hollister Avenue to Cathedral Oaks Road.

VEREDA DEL CIERVO, between Vereda Leyenda and the northern terminus of Vereda Del Ciervo.

VERONICA SPRINGS ROAD, (those portions only within the unincorporated area of the County), between Modoc Road and Las Positas Road.

VIEJA DRIVE, between Via Huerto and its southwesterly terminus.

SECTION 7

Section 23-15.5. of the County Code of the County of Santa Barbara, is hereby amended to provide as follows:

Section 23-15.5. Forty Miles Per Hour Speed Limit. The speed limit for the highways or portions thereof designated in this section is hereby determined and declared to be forty miles per hour.

BASELINE AVENUE, between a point eighteen hundred feet east of Alamo Pintado Road and Refugio Road.

BRADLEY ROAD, from Via Mavis to Rice Ranch Road.

BURTON MESA BOULEVARD, from a point four hundred feet west of Rucker Road and Via Lato.

CALLE REAL, from El Sueno Road to State Route 154.

CATHEDRAL OAKS ROAD, from the Goleta City Limits to Turnpike Road.

CLARK AVENUE, from State Route 1 to a point three hundred and fifty feet west of Broadway.
CLARK AVENUE, from Norris Street to Bethany Lane.
FOSTER ROAD, from Orcutt Road to Bradley Road.
FOXEN CANYON ROAD, from a point one hundred feet east of Brooks Street to a point one thousand three hundred twenty feet north of Depot Road.
HOT SPRINGS ROAD, between East Valley Road (State Route 192) and Mountain Drive.
JAMESON LANE NORTH, from Olive Mill Road to Sheffield Drive.
LAKEVIEW ROAD, between Orcutt Road and Bradley Road.
LAS PALMAS DRIVE, from La Cumbre Road to Paloma Drive.
MARINA DRIVE, from Roble Drive to the westerly city limits to the City of Santa Barbara.
MIGUELITO ROAD, from the southerly city limits of the City of Lompoc to eight thousand two hundred thirty feet southerly thereof.
ORCUTT ROAD, from Clark Avenue to Rice Ranch Road.
ORCUTT ROAD, from Foster Road to 600 feet north of Mooncrest Lane.
PARADISE ROAD, between a point 2.5 miles east of State Highway 154 and the southerly bank of the Santa Ynez River.
SAN ANTONIO CREEK ROAD, between Via Los Santos and State Route 154.
SOLOMON ROAD, from Blosser Road to State Route 1.
VIA REAL, from Toro Canyon Road to Sentar Road.

SECTION 8

Section 23-15.6. of the County Code of the County of Santa Barbara, is hereby amended to provide as follows:

Section 23-15.6. Forty-Five Miles Per Hour Speed Limit. The speed limit for the highways or portions thereof designated in this section is hereby determined and declared to be forty-five miles per hour.

ALAMO PINTADO ROAD, between the city limits of Solvang and Santa Barbara Avenue.
BASELINE AVENUE, from Refugio Road to Edison Street.
BETTERAVIA ROAD, between a point nine hundred feet east of the centerline of U.S. Highway 101 and a point fourteen hundred feet west of the centerline of U.S. Highway 101.
BLOSSER ROAD, from Clark Avenue to the Santa Maria city limits.
BRADLEY ROAD, from Santa Maria Way to 150 feet north of the centerline of Amethyst Drive.
CALLE REAL, from the Goleta City Limits to Patterson Avenue.
CALLE REAL, from San Marcos Road to Turnpike Road.
CALLE REAL, from Turnpike Road to El Sueno Road.
CALZADA AVENUE, from Cimmaron Drive to Baseline Avenue.
CATHEDRAL OAKS ROAD, from Turnpike Road to State Route 154.
CLARK AVENUE, from Leon Street to a point nine hundred and twenty feet east of U.S. 101 northbound off-ramp.
COLLEGE DRIVE, between Santa Maria Way and Santa Maria city limits.
EDISON STREET, from two hundred feet north of Lindero Street to Baseline Avenue.
FOXENWOOD LANE, from Clark Avenue to the Santa Maria City Limits.
HOLLISTER AVENUE, from the Goleta City Limits to Modoc Road.
LOS CARNEROS ROAD, from El Colegio Road to the Goleta City Limits.

MODOC ROAD, from Las Positas Road (State Route 225) to seven hundred seventy-five feet east of Vista Clara Road (Those portions within the unincorporated territory of the county).

ORCUTT ROAD, from Lakeview Road to Foster Road.

ORCUTT ROAD, from 600 feet north of Mooncrest Lane to Clark Avenue.

PADARO LANE, from its westerly terminus at Via Real to four thousand eight hundred feet east of its westerly terminus at Via Real.

PATTERSON AVENUE, from the Goleta City Limits to Cathedral Oaks Road.

PATTERSON AVENUE, between Shoreline Drive and the city limits of Goleta.

REFUGIO ROAD, from Deer Trail Lane (south) to Country Road.

RICE RANCH ROAD, from Lorraine Avenue to Bradley Road.

RUCKER ROAD, between Lompoc-Casmalia Road and a point two hundred feet south of Calle Primera.

SANTA BARBARA AVENUE, from Alamo Pintado Road to Alamo Pintado Avenue.

SANTA MARIA WAY, between U.S. 101 and the Santa Maria city limit.

STATE STREET, from Modoc Road to the Santa Barbara City Limits.

STORKE ROAD, from El Colegio Road to the Goleta City Limits.

UNION VALLEY PARKWAY, from Bradley Road to Boardwalk Lane.

VIA REAL, from Greenwell Avenue to Toro Canyon Road.

VIA REAL, from Sentar Road to the westerly limits of the City of Carpinteria.

SECTION 9

Section 23-15.7. of the County Code of the County of Santa Barbara, is hereby amended to provide as follows:

Section 23-15.7. Fifty Miles Per Hour Speed Limit. The speed limit for the highways or portions thereof designated in this section is hereby determined and declared to be fifty miles per hour.

BURTON MESA BOULEVARD, between four hundred feet west of Rucker Road and eight hundred feet east of Arneb Avenue.

CLARK AVENUE, from Bethany Lane to El Portal Street.

LOMPOC CASMALIA ROAD, between State Highway 1 and Utah Avenue (Vandenberg Air Force Base).

UNION VALLEY PARKWAY, from Hummel Drive to Bradley Road.

SECTION 10

This ordinance shall take effect and be in force thirty (30) days from the date of its passage; and before the expiration of fifteen (15) days after its passage it, or a summary of it, shall be published once, with the same in the Santa Barbara News Press, a newspaper of general circulation published in the County of Santa Barbara.

PASSED AND ADOPTED by the Board of Supervisors of the County of Santa Barbara,
State of California, this _____ day of _____ 2008, by the following vote:

AYES:

NOES:

ABSENT:

Chair, Board of Supervisors

ATTEST:
MICHAEL F. BROWN
Clerk of the Board

BY _____
Deputy Clerk

APPROVED AS TO FORM:
STEPHEN SHANE STARK,
County Counsel

BY  _____
Deputy County Counsel

c: PW Accounting
File: C800.10 & C1700

G:\Traffic\Winword\Ordinances\2008\Speeds_Feb08.doc

VICINITY MAP

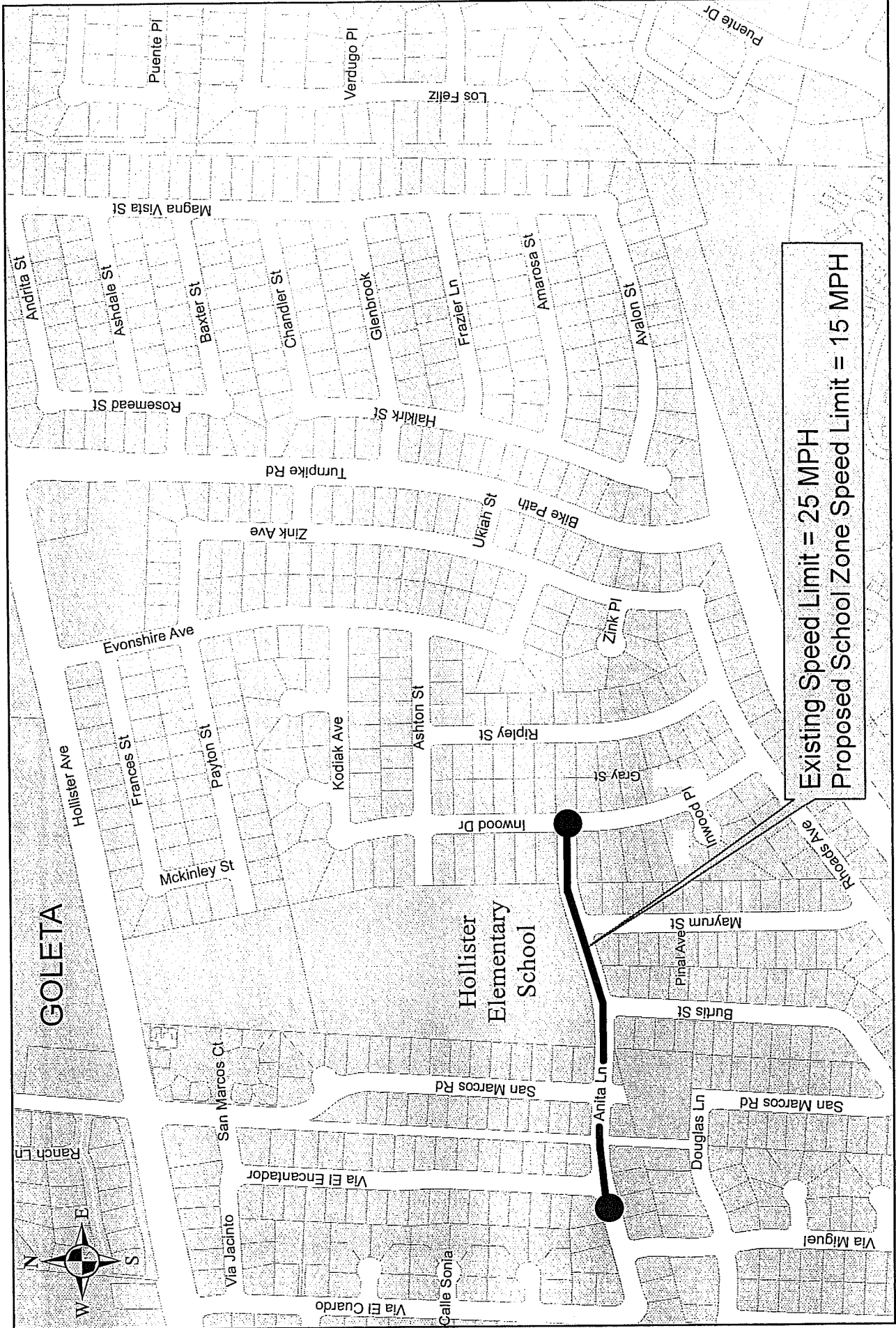

Existing Speed Limit = 25 MPH
Proposed School Zone Speed Limit = 15 MPH

Proposed school zone speed limit
on Anita Lane

VICINITY MAP

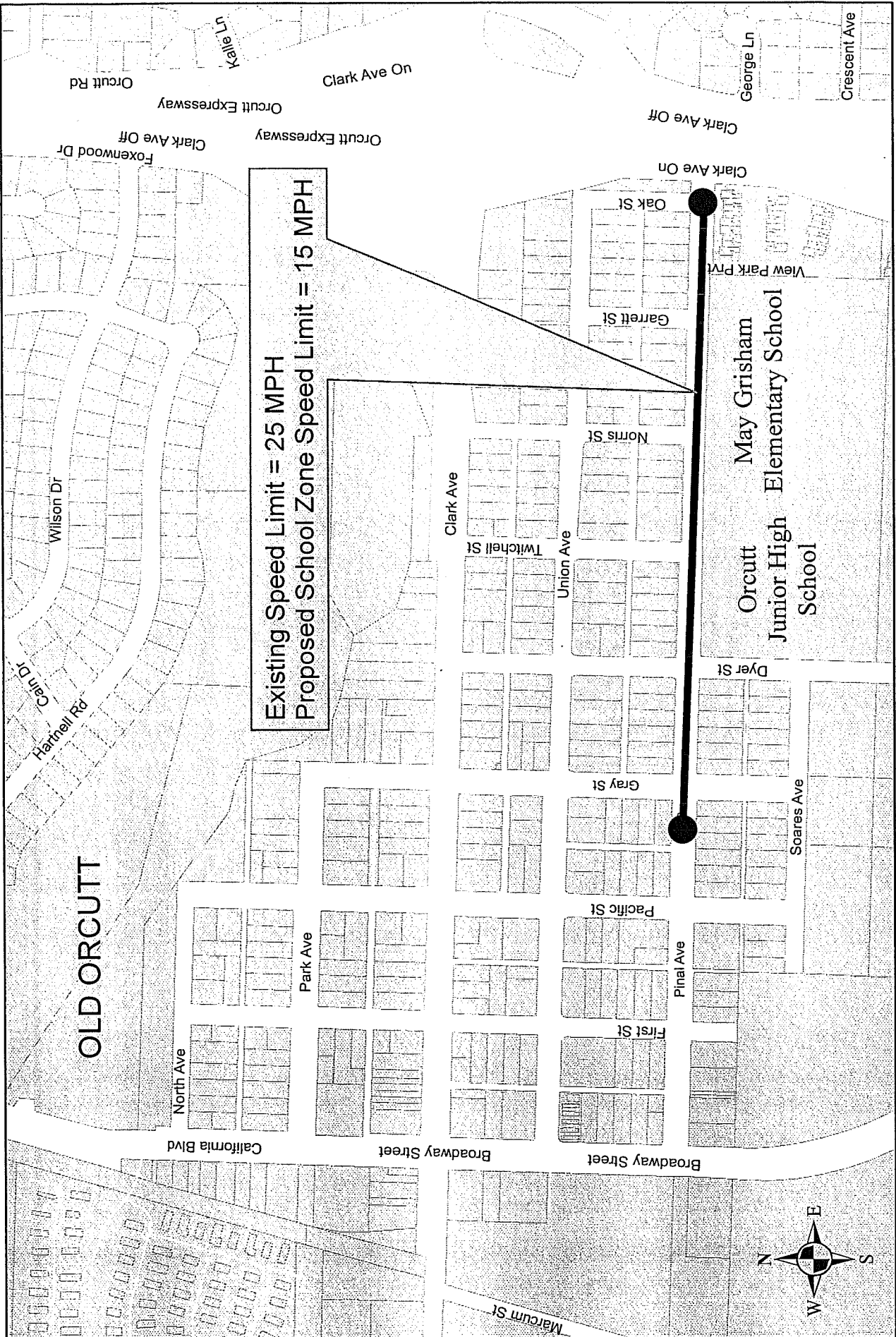

Proposed school zone speed limit
on Pinal Avenue

VICINITY MAP

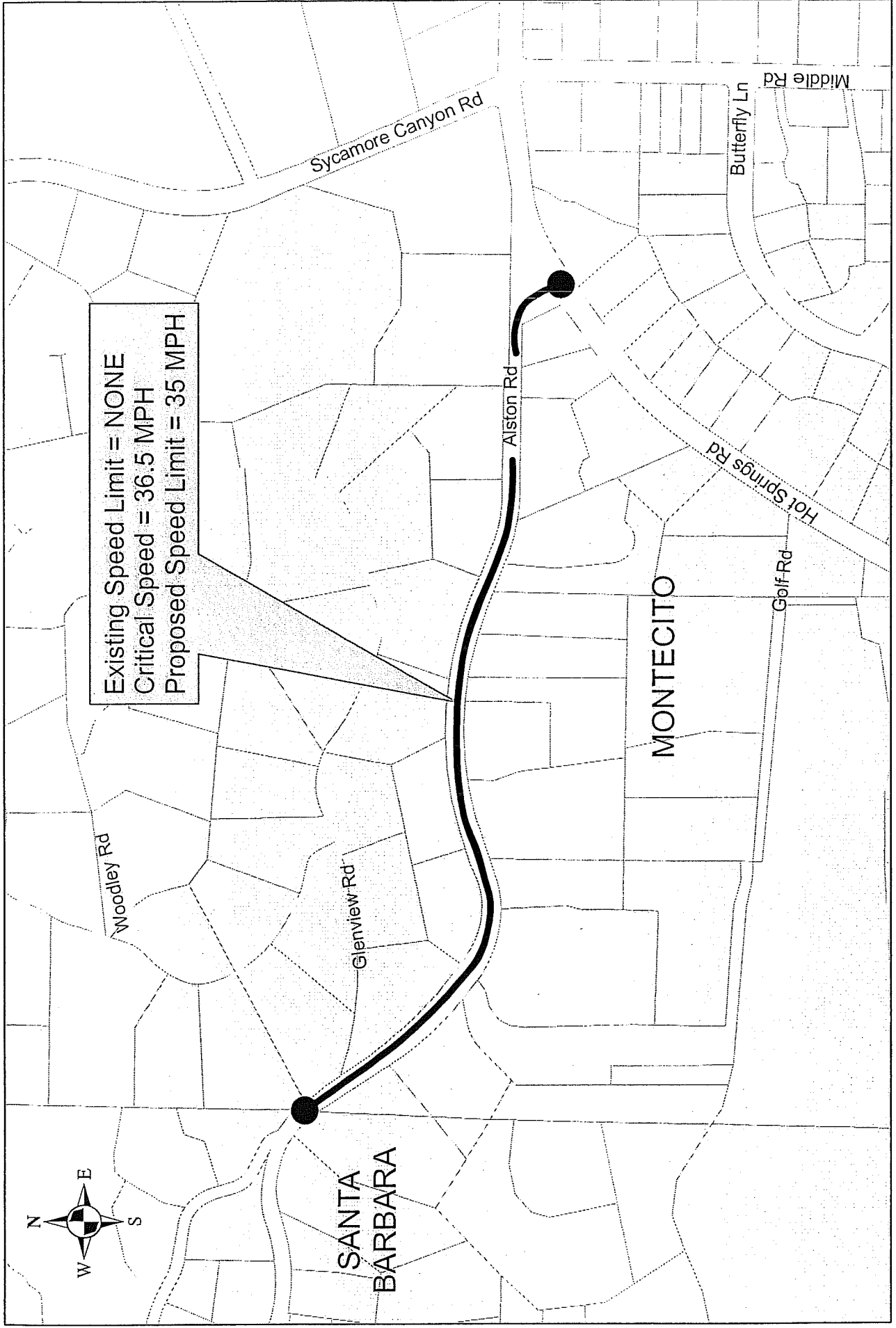

Proposed Speed Zone
on Alston Rd

VICINITY MAP

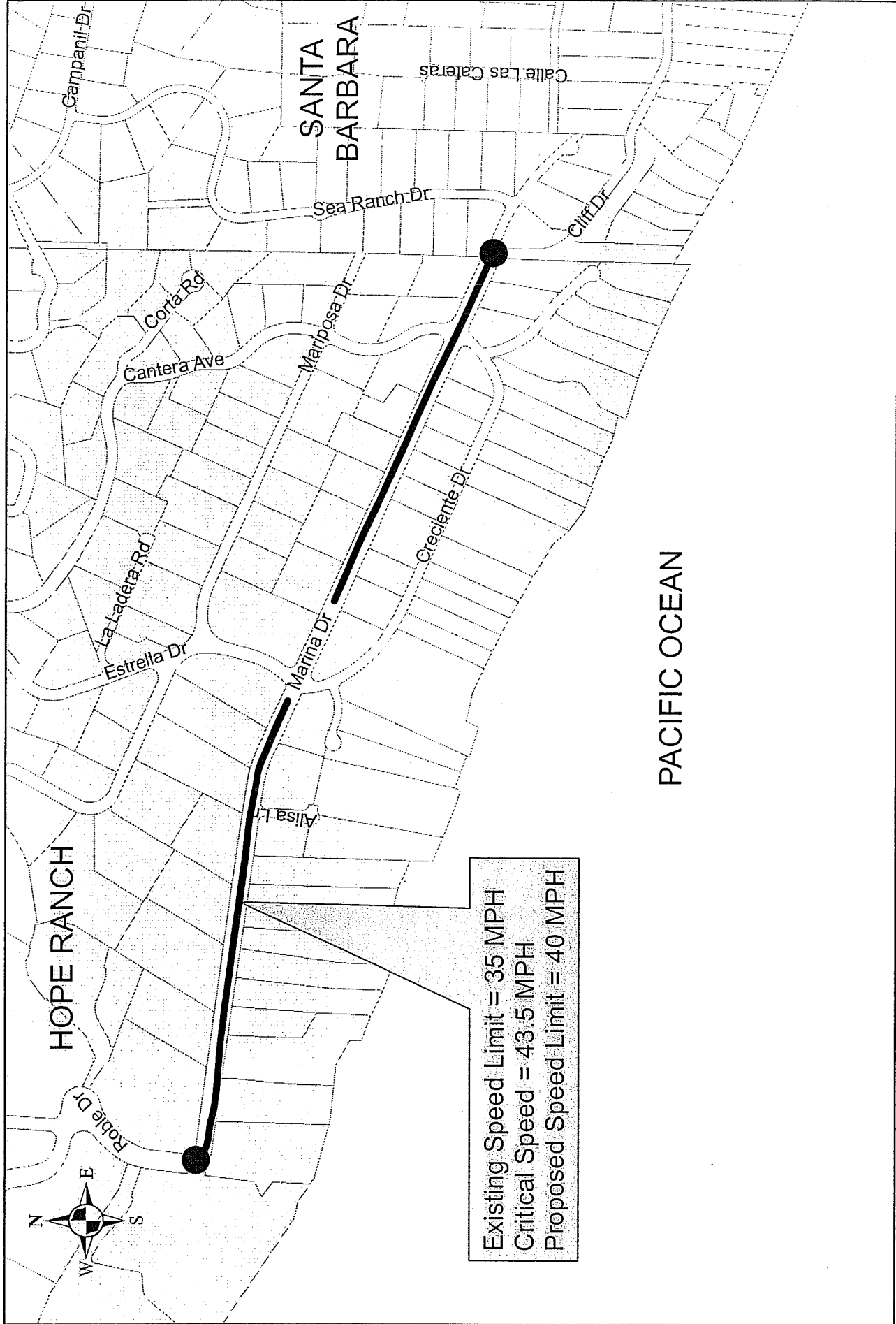

Proposed Speed Limit Change
on Marina Dr

VICINITY MAP

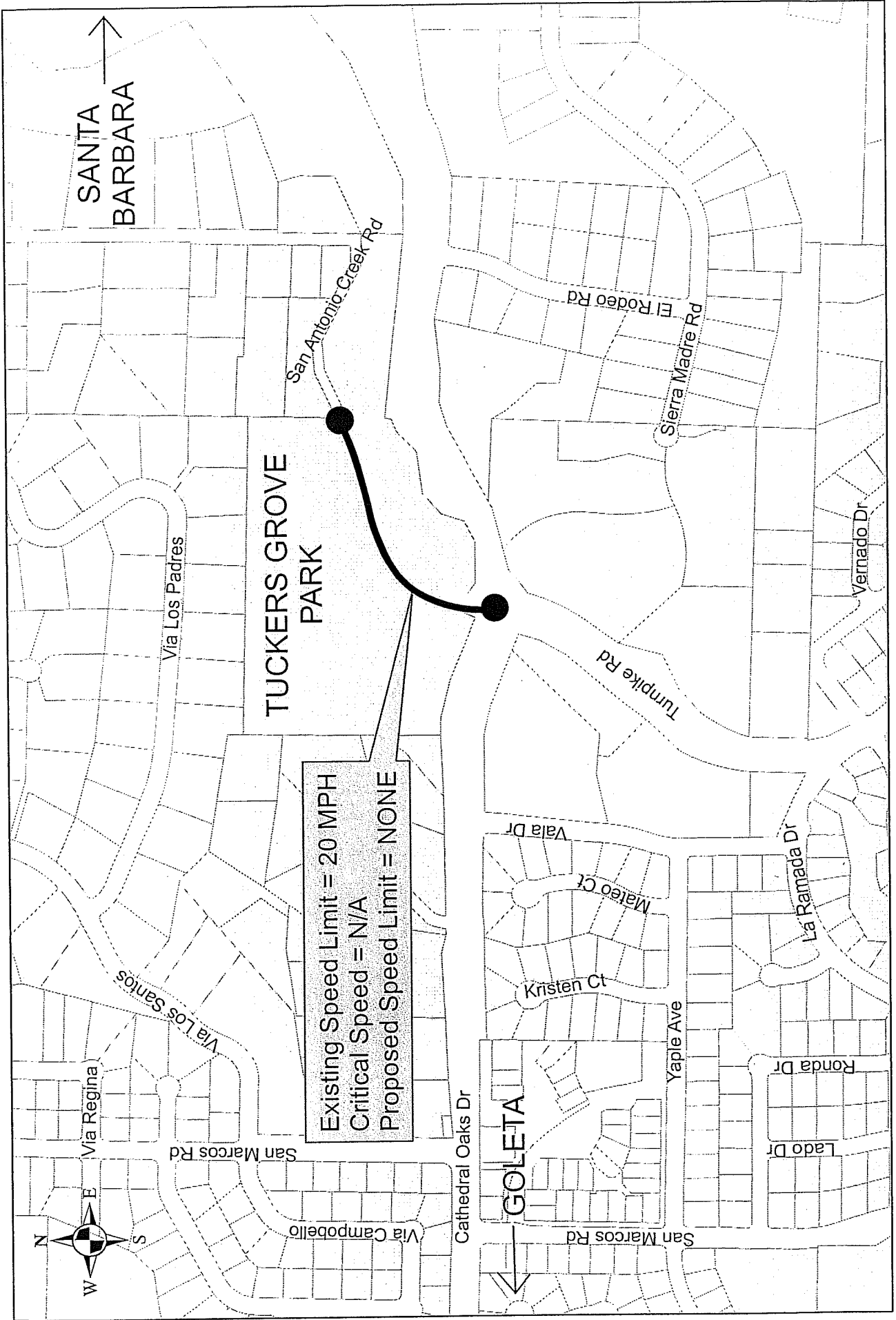

Proposed Speed Zone Removal
on Abandoned San Antonio Creek Rd