

Legal Description

16AGP-00000-000 17

The East one-half (E 1/2) of Tract No. 3 of The Rancho San Carlos De Jonata, in the County of Santa Barbara, State of California, according to the map thereof recorded in Book 5, Pages 51 to 56, inclusive, of Maps, in the Office of the County Recorder of said County.

Excepting therefrom all of said Tract No. 3 lying Southerly of the centerline of State Highway 246

Also excepting therefrom that portion thereof conveyed to the State of California by Deed recorded February 23, 1998 as Document No. 98-010798 of Official Records.

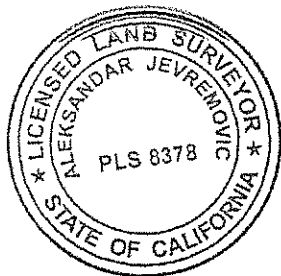

10/21/2016

APPROVED AS TO FORM
AND SURVEY CONTENT

AJevremovic
ALEKSANDAR JEVREMOVIC
COUNTY SURVEYOR
LICENSE EXP. 12/31/2016

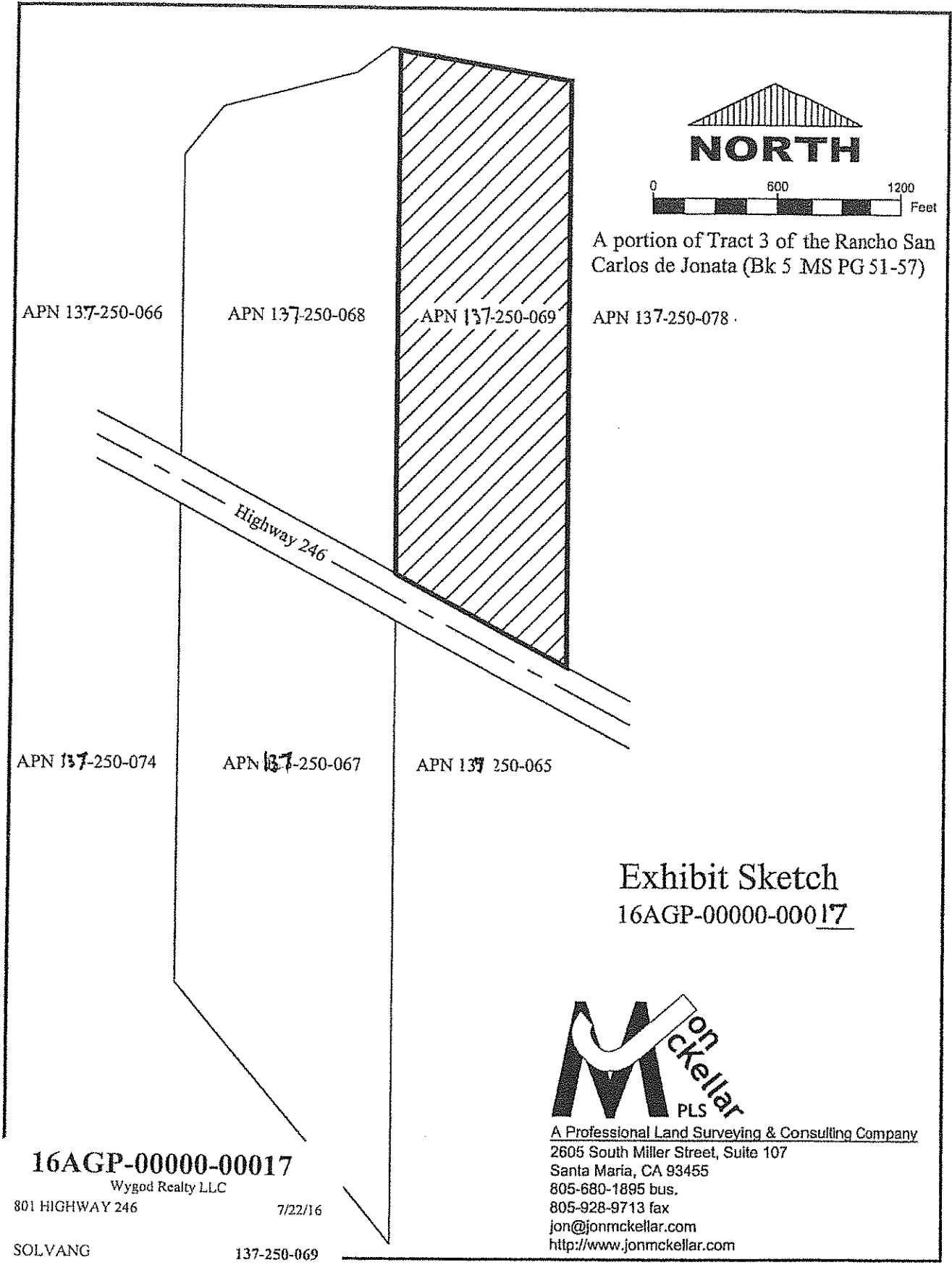

A portion of Tract 3 of the Rancho San Carlos de Jonata (Bk 5 MS PG 51-57)

Exhibit Sketch
16AGP-00000-00017



A Professional Land Surveying & Consulting Company
 2605 South Miller Street, Suite 107
 Santa Maria, CA 93455
 805-680-1895 bus.
 805-928-9713 fax
 jon@jonmckellar.com
 http://www.jonmckellar.com

16AGP-00000-00017

Wygod Realty LLC
 801 HIGHWAY 246 7/22/16
 SOLVANG 137-250-069