

08AGP-00000-00031
Legal Description

The West ½ of the southwest quarter of Section 26, and the northwest quarter of the northwest quarter of Section 35, in Township 7 North, Range 33 West, San Bernardino Meridian, in the County of Santa Barbara, State of California.

APPROVED AS TO FORM
AND SURVEY CONTENT

*Deputy County
Surveyor*

Edmund R. Villa

For:

MICHAEL B. EMMONS, PLS 5899
COUNTY SURVEYOR
LICENSE EXP. 12/31/08



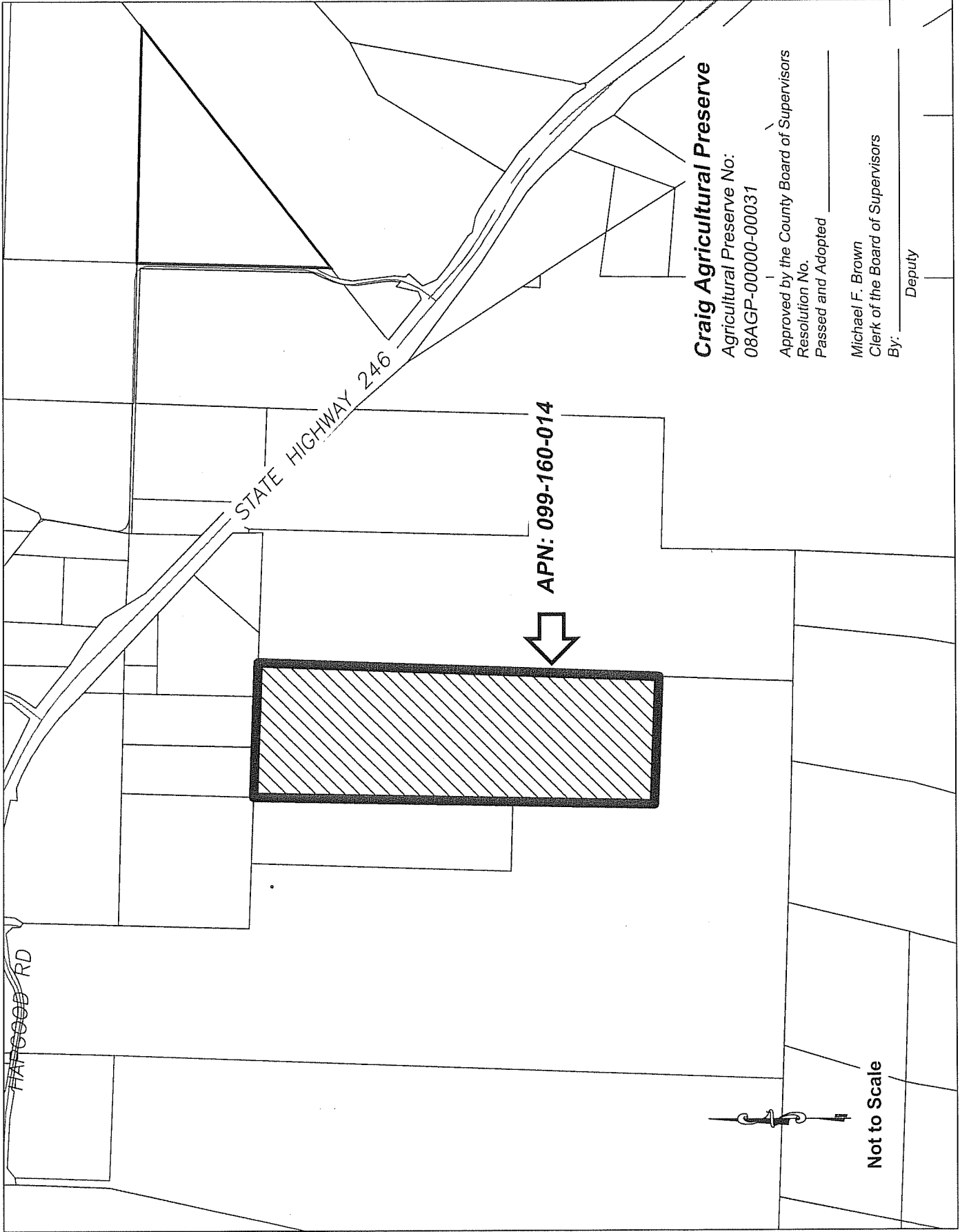

Craig Agricultural Preserve

Agricultural Preserve No:
08AGP-00000-00031

Approved by the County Board of Supervisors
Resolution No. _____
Passed and Adopted _____

Michael F. Brown
Clerk of the Board of Supervisors
By: _____ Deputy



Not to Scale