

BOARD OF SUPERVISORS

UNIVERSITY OF CALIFORNIA SANTA BARBARA (UCSB) LONG RANGE DEVELOPMENT PLAN (LRDP)

March 24, 2009



OFFICE OF LONG RANGE PLANNING

www.longrange.sbcountyplanning.org

AGENCY ROLES

- **UCSB**

- UC Regents Determines Campus Growth
- Academic Plan Guides Future Growth
- LRDP Implements the Academic Plan

- **COUNTY OF SANTA BARBARA**

- Provides Public Services & Infrastructure
- Responsive to Community Concerns
- Establish Positive Fiscal Position

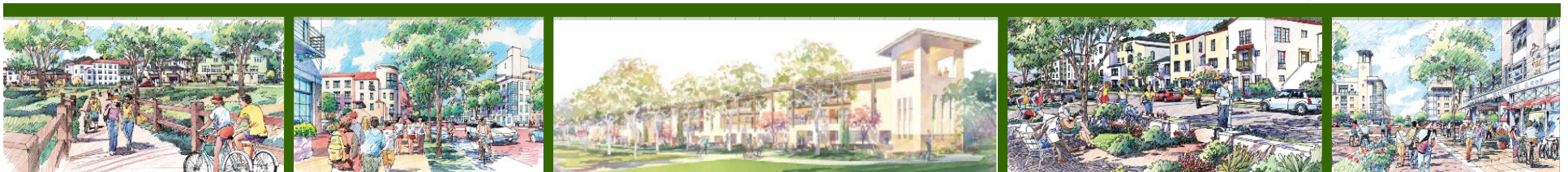

PLANNING PROCESS

- **LRDP & DRAFT EIR**

- Released March 20, 2008
- Public Review Ended June 23, 2008

- **RECIRCULATED DRAFT EIR**

- Air Quality, Population/Housing, Transportation/Circulation, Water Supply & Wastewater
- Released February 9, 2009
- Public Review Ending March 30, 2009



PROPOSED 2008 LRDP

LRDP SUMMARY			
Use Type	Existing	Proposed	Total by 2025
Student Enrollment	20,000	+ 5,000	25,000
Faculty Population	1,054	+ 336	1,400
Staff Population	3,631	+ 1,400	5,031
Academic Building Space	2.7 Mil.	+ 1.8 Mil.	4.5
Student Bed Spaces	6,652	+ 5,443	12,095
Student Families Housing Units	704	+ 239	943
Faculty/Staff Housing Units	226	+ 1,874	2,100
Recreational Acres	26	+ 5	31
Parking Spaces	10,480	+ 3,650	14,230
SUMMARY			
Total New Housing		7,556 Units/Beds	
Total New Population		11,106 Persons	
Total New Building		2.5 Million Sq.Ft.	
Source: UCSB LRDP DEIR, March 2008			



ENVIRONMENTAL ISSUES

- **AESTHETICS**

- **Scale and Context: Height Increases Up to 80 Feet**
- **Neighborhood Compatibility**

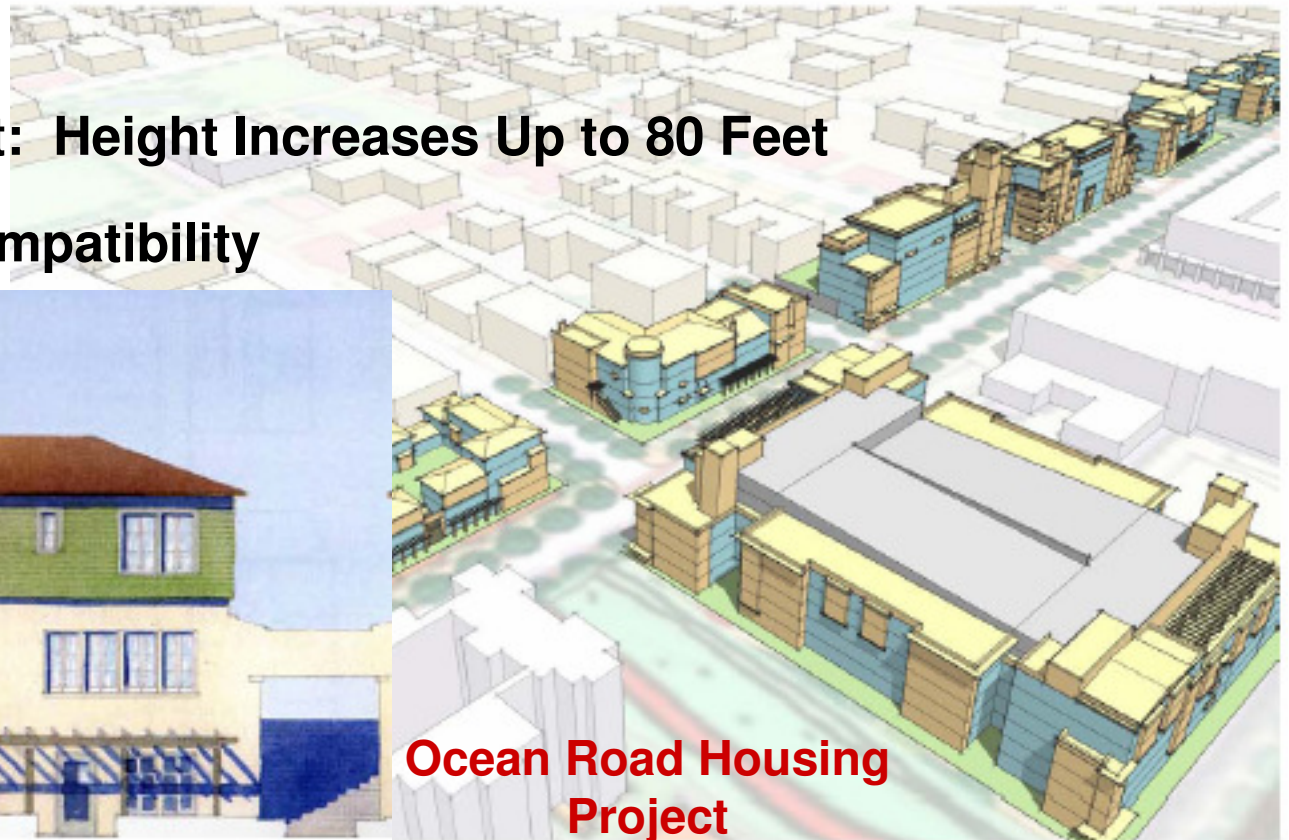

Ocean Road Housing Project

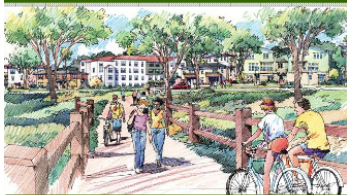

ENVIRONMENTAL ISSUES

- **Air Quality**

- Increased Vehicle Emissions & Global Warming

- **Biology**

- Adjacency to ESHA & Impacts to Sensitive Species

- **Cultural Resources**

- Avoidance vs. Mitigation of Impacted Resources

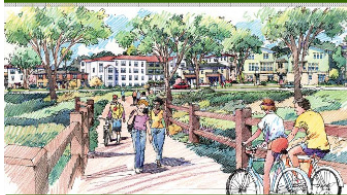

ENVIRONMENTAL ISSUES

- **Geology**

- Earthquake Faults & Relationship to Building Sites
- Seawalls Needed for East Facing Bluffs

- **Hazards**

- Increased Waste Generation, Exposure and Handling
- Impairment of Emergency Evacuation Capability



ENVIRONMENTAL ISSUES

- **Hydrology & Water Quality**

- Increased Surface Water Runoff & Need for BMPs
- Degradation of Goleta Slough & Impaired Water Bodies

- **Land Use & Planning**

- Policy Inconsistencies with Community Plans
- Commercial Retail Impacts on Local Businesses

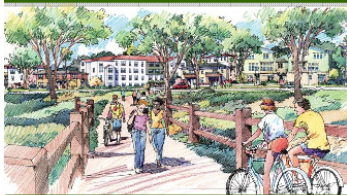

ENVIRONMENTAL ISSUES

- **Noise**

- Increased Traffic & Impacts to Sensitive Receptors
- Deficient Baseline Data and Assessment Methodology

- **Population & Housing**

- Enrollment and Housing Construction Lag Time
- Growth Inducing and Cumulative Impacts

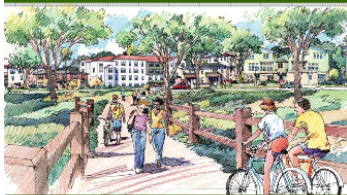

ENVIRONMENTAL ISSUES

- **Public Services**

- Impact on Law Enforcement and Fire Protection
- Need for 30.8 Deputies & 24.1 Firefighters (8-posts)

- **Recreation**

- Increased Demand & Overuse of Existing Facilities

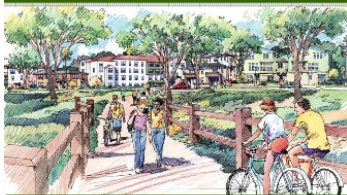

ENVIRONMENTAL ISSUES

- **Transportation & Circulation**

- Inadequate Baseline and Deficient Analysis
- 7,000+ Peak Hour Trips and Consequent LOS Impacts

- **Water & Wastewater**

- Demand in Excess of UCSB Service Allotment
- Cumulative Impacts on Water Supplies

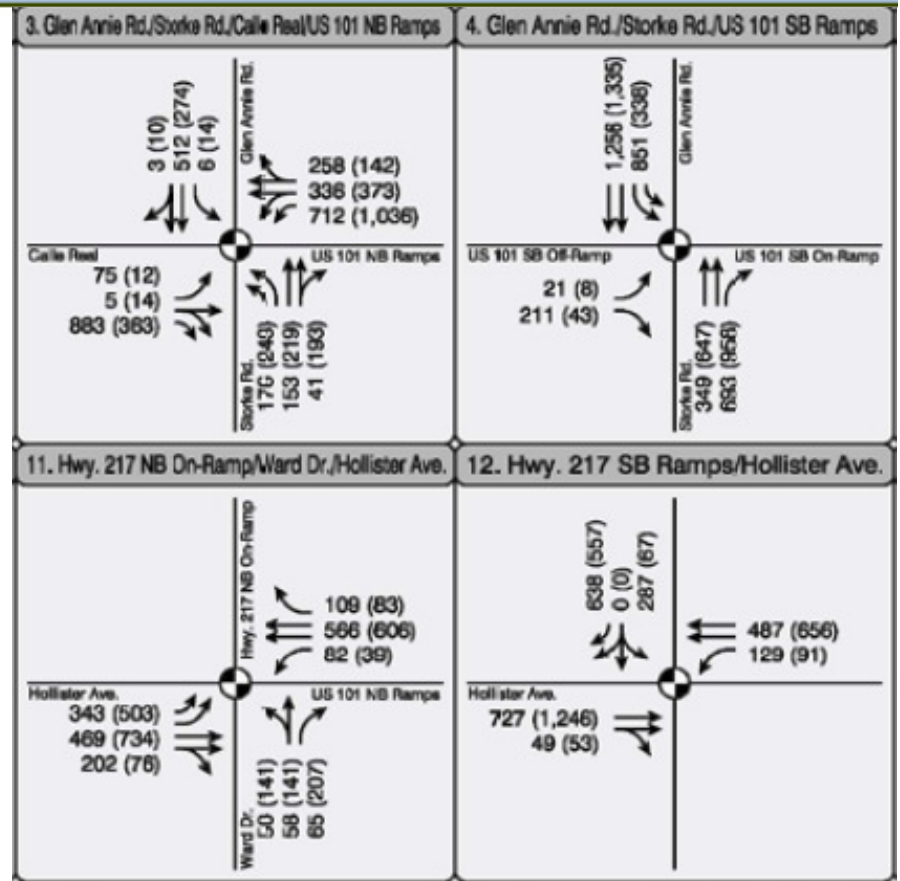

ENVIRONMENTAL ISSUES

- **Mitigation Challenges**

- **Deferred Mitigation (Future Studies & Agreements)**
- **Consideration of Indirect and Cumulative Impacts**
- **Lack of Mitigation Specificity (e.g., TDM Measures)**
- **Assignment of Fair Share Responsibility for Mitigation**

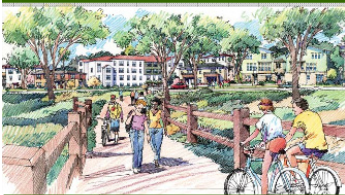
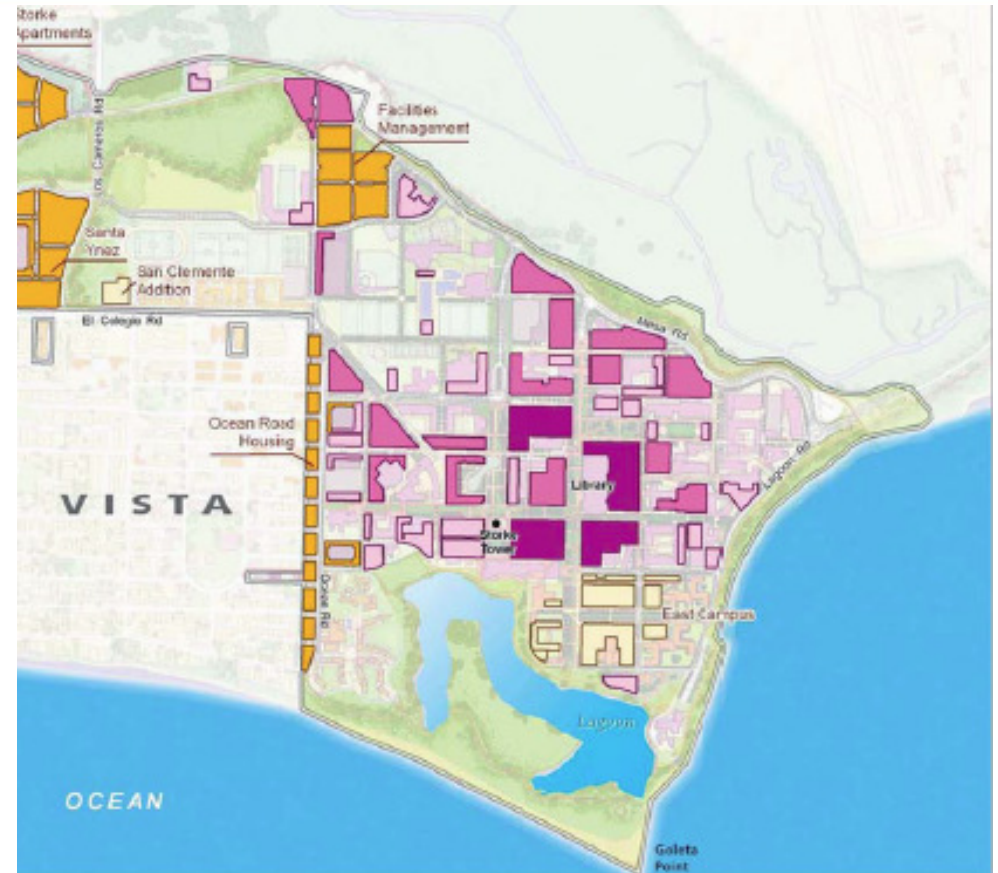

FISCAL IMPACT ANALYSIS

CAPTIAL IMPROVEMENT REQUIREMENTS

Row #	Item	Student Units	Faculty Units	Institutional	Total	%
<u>Net New Development Summary¹</u>						
1	Single Student Units, at 2 beds per unit	2,722	--	--		
2	Family Units	239	1,874	--		
3	Academic Square Footage (Gross)	--	--	2,500,000		
4	Totals by Type	2,961	1,874	2,500,000		
<u>Development Impact Fees</u>						
		<u>Fee per Unit²</u>	<u>Fee per Unit²</u>	<u>Fee per 1,000 SqFt.³</u>		
Total Fees						
5	Parks	\$7,868,000	\$4,979,600	\$5,372,500	\$18,220,100	13%
6	Fire - Goleta	\$1,566,400	\$991,300	\$1,757,500	\$4,315,200	3%
7	Fire - Countywide ⁴	\$154,000	\$206,100	\$250,000	\$610,100	0%
8	Library	\$846,800	\$536,000	\$475,000	\$1,857,800	1%
9	Public Administration	\$3,615,400	\$2,288,200	\$2,032,500	\$7,936,100	6%
10	Sheriff	\$965,300	\$610,900	\$1,087,500	\$2,663,700	2%
11	Transportation ⁵	\$22,035,800	\$11,643,200	\$23,329,800	\$57,008,800	41%
12	Total - Existing Fees	\$37,051,700	\$21,255,300	\$34,304,800	\$92,611,800	67%
13	Additional Departmental Capital Impacts⁶				\$44,804,000	33%
Total Capital Costs Allocated to UCSB					\$137,415,800	100%



FISCAL IMPACT ANALYSIS

ONGOING COSTS FOR PUBLIC SERVICES

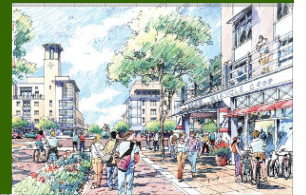
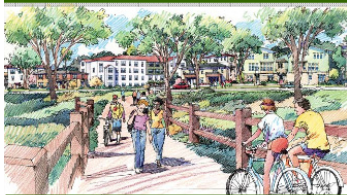
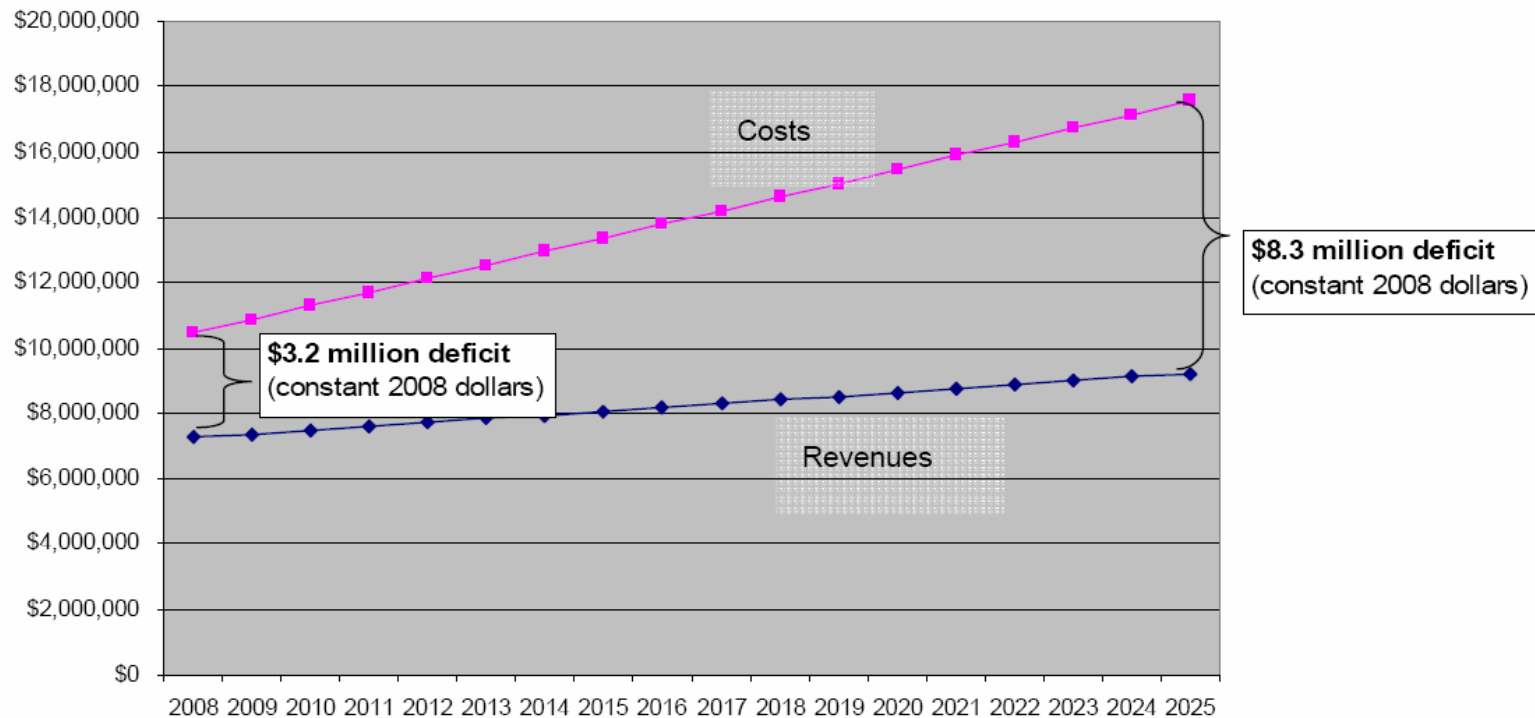

FISCAL IMPACT ANALYSIS

• CAPITAL IMPROVEMENTS

- \$90.4 Million for Roads
- \$12.7 Million for Public Safety
- \$33.9 Million for Parks/Miscellaneous

• OPERATING COSTS

- Fund 30.8 Sheriff Officers
- Fund 24.1 Firefighters (8 Posts)
- Net Difference Between Revenues and Costs - **\$8.3 Million**

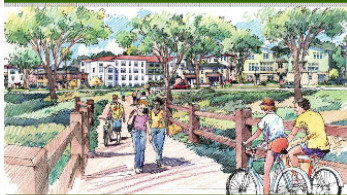

GUIDING PRINCIPLES

• UCSB STATURE

- A World-Class University
- Undisputed Asset to the Community
- Enriches Lives of All County Residents

• COUNTY GOALS

- Support UCSB's Academic Goals
- Foster Positive Relations
- Equitable Sharing of Responsibilities



HISTORY IN REVIEW

- **1990 LONG RANGE DEVELOPMENT PLAN (LRDP)**

- Planning Horizon to 2006
- Enrollment Target – 20,000 Students

- **COOPERATION/SETTLEMENT AGREEMENT**

- On and Off-Site Housing Mitigation
- \$3.2 Million Traffic Mitigation
- Traffic Demand Management
- Limit on Annual Enrollment (1% Growth Rate)

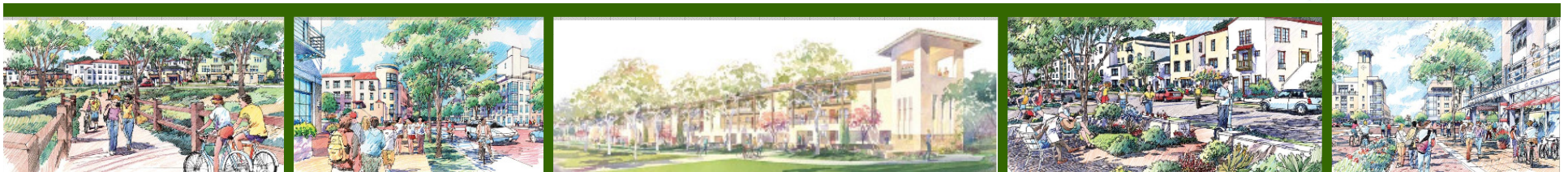

NEXT STEPS

- **ENVIRONMENTAL REVIEW**

- Recirculation for Public Comment
- Release Date: **February 9, 2009**
- End of Public Review Period: **March 30, 2009**

- **DECISION MAKING**

- UC Regents: **Summer 2009**
- Coastal Commission: **Winter 2009 - 2010**

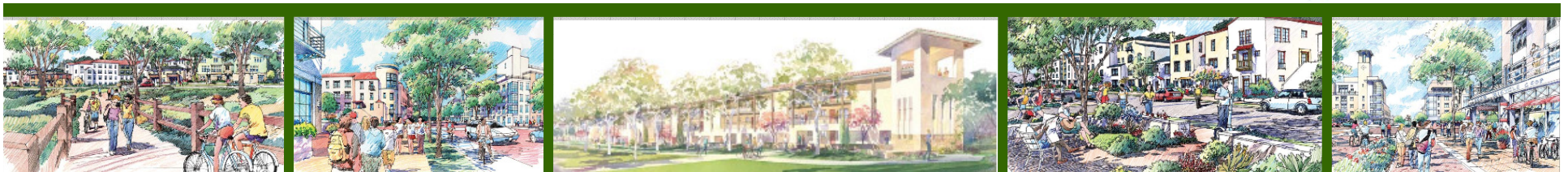

RESOURCES

- **COUNTY DOCUMENTS**

- **Fiscal Impact Study (June 2008)**
- **LRDP Comment Letter (June 2008)**
- **Ocean Road Initial Study/NOP Comment Letter (December 2008)**

- **COUNTY WEBSITE**

- http://longrange.sbcountyplanning.org/programs/ucsblrpreview/ucsb_lrp_review.php

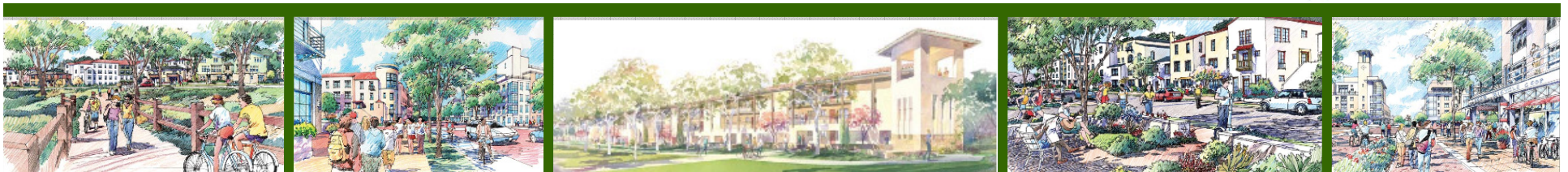

Recommendation

- **RECOMMENDED ACTION**

- Receive and file the staff report and presentation and the County's comments dated June 23, 2008
- Direct staff to prepare and submit comments regarding the UCSB LRDP & RDEIR

- **NEXT STEPS**

- Submit RDEIR comments by March 30, 2009 deadline
- Monitor review and approval steps related to LRDP DEIR

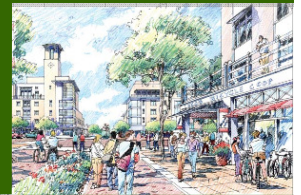
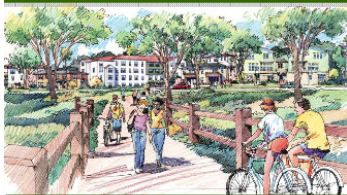

BOARD OF SUPERVISORS

UNIVERSITY OF CALIFORNIA SANTA BARBARA (UCSB) LONG RANGE DEVELOPMENT PLAN (LRDP)

March 24, 2009



OFFICE OF LONG RANGE PLANNING

www.longrange.sbcountyplanning.org