

LEGAL DESCRIPTION

Lot 2, in the County of Santa Barbara, State of California, as described in Lot Line Adjustment No. 94LLA-00000-00001 recorded June 12, 2013 as Instrument Number 2013-39458 of Official Records in the office of the County Recorder of said County.

APN 145-190-008

Agricultural Preserve
11AGP-00000-00020



Kenneth J. Wilson
7-24-2013



APPROVED AS TO FORM
AND SURVEY CONTENT

E. Tenell Matlovsky

Deputy:
COUNTY SURVEYOR
LICENSE EXP. 12/31/2015



POR. RANCHO SAN MARCOS

145-19

Agricultural Preserve
11AGP-00000-00020

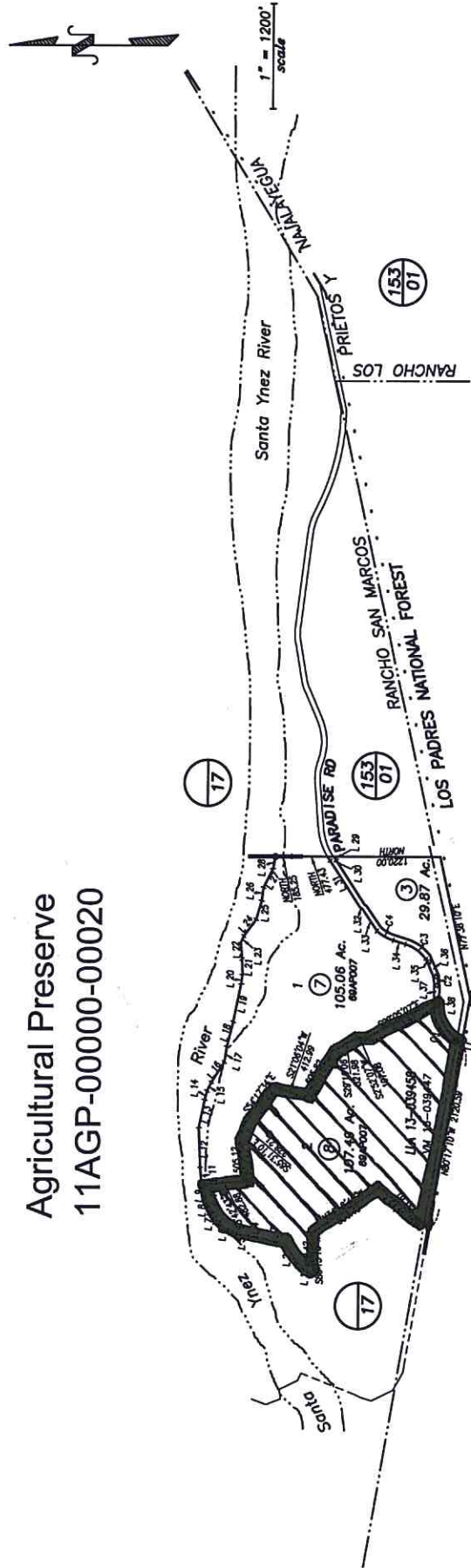

LINE TABLE		
NO.	BEARING	DISTANCE
L 1	N82°39'20"E	179.08
L 2	N65°42'01"E	318.71
L 3	N44°46'30"E	184.18
L 4	N65°42'01"E	184.18
L 5	N65°46'30"E	131.81
L 6	N69°07'29"E	283.29
L 7	N67°39'35"E	114.68
L 8	N67°18'59"E	194.79
L 9	N77°12'08"E	184.79
L 10	S89°58'51"E	102.00
L 11	S55°48'33"W	187.30
L 12	S57°44'05"W	451.48
L 13	N78°07'08"W	323.18
L 14	N75°18'37"W	103.89
L 15	S73°18'49"W	171.00
L 16	N52°54'27"W	213.00
L 17	N61°27'26"W	178.05
L 18	N75°35'49"W	283.21
L 19	N78°35'30"W	441.17

LINE TABLE		
NO.	BEARING	DISTANCE
L 20	N82°37'23"W	109.30
L 21	S89°07'44"W	174.73
L 22	S89°11'59"W	151.44
L 23	N89°11'59"W	151.44
L 24	N85°18'21"W	239.06
L 25	N74°05'51"W	218.80
L 26	N82°29'43"W	151.85
L 27	N83°50'31"W	128.48
L 28	N74°05'51"W	239.06
L 29	N57°06'30"E	54.27
L 30	S30°01'	71.46
L 31	N87°06'30"E	636.89
L 32	N69°15'40"E	27.81
L 33	N77°03'00"E	148.24
L 34	N77°03'00"E	47.80
L 35	N33°33'00"E	47.80
L 36	N89°06'00"E	162.88
L 37	N89°06'00"W	162.88
L 38	N89°06'00"W	64.43

CURVE TABLE		
NO.	RADIUS	LENGTH
C 1	477.47	564.55
C 2	477.47	564.55
C 3	447.47	292.78
C 4	507.47	216.39

NOTICE
Assessor's Parcels are for tax assessment purposes only and do not indicate either parcel legality or a valid building etc.

Assessor's Map Bk, 145-Pg. 19
County of Santa Barbara, Calif.

12/13 2.3 & Per 170-38 sub 7 & 8