

## ATTACHMENT 2: LEGAL DESCRIPTION

AGRICULTURAL PRESERVE

16AGP-00000-00008

### Exhibit A

(legal description)

That portion of the Rancho Canada De Los Pinos, or College Rancho, as shown on the map of the subdivision thereof filed in the Office of the County Recorder of Santa Barbara County, State of California, August 8, 1888, and being Map No.4, in Rack No.3, in the Office of the County Recorder of said County described as follows:

Beginning at the southeast corner of that certain 102.00 acre parcel as shown on the Record of Survey filed in Book 117, Page 47 of Records of Surveys in the Office of the County Recorder of said County, being a point on the westerly line of Meadowlark Road, 60 feet in width, as shown on said map;

thence (1), South 00°18'20" West 369.24 feet along said westerly line of Meadowlark Road to a point on the northerly line of the tract of land as described as Parcel One in the deed to Bryant E. Meyers, et ux., recorded July 7, 1953, as Instrument No. 11161, in Book 1165, Page 280 of Official Records of said County;

thence (2), North 84°13'00" West 523.99 feet along said Meyers Tract the following bearings and distances;

thence (3), North 82°40'30" West 1357.92 feet;

thence (4), South 44°39'00" West 935.86 feet;

thence (5), South 00°19'30" West 330.40 feet;

thence (6), South 02°14'30" East 452.82 feet;

thence (7), South 17°31'30" West 231.33 feet;

thence (8), South 21°33'00" West 250.98 feet;

thence (9), South 07°02'00" West 422.34 feet;

thence (10), North 82°04'00" East 136.64 feet; thence (11), South 00°35'00" East 4458.94 feet to an angle point in said Meyers Tract and a point in the bed of the Santa Ynez River;

thence (12), leaving said Meyers Tract and running northwesterly along the bed of said river North 55°49'50" West 276.61 feet; thence (13), South 78°00'40" West 529.51 feet

to the northeast corner of the parcel of land described in the deed to Pierre C. Merillon, et ux., recorded December 21, 1950, as Instrument No. 18476 in Book 959, Page 281 of Official Records; thence (14), North 66°28'00" West along the northerly line of said

Merillon parcel and along said river bed to a point on the east line of Lot 1 of Tract 14 of said Map No.4 in Rack No. 3; thence (15), Northerly along said east line of said Lot 1 of

Tract 14 to the northeast corner thereof; thence (16), North 88°46'00" West along the north line of said Lot 1 of Tract 14 to the southeast corner of The Con Murphy Tract as shown on Maps and Surveys Book 8, Page 60 filed in said County Recorder's Office;

(continued)

thence (17), North 00°08'00" West 5317.90 feet to the northeast corner of said Con Murphy Tract;

thence (18), North 89°26'00" West 3077.30 feet to the northwest corner of said Con Murphy Tract;

thence (19), South 00°21'30" East, along the westerly line of said Con Murphy Tract, 3280.17 feet;

thence (20), leaving the westerly line of said Con Murphy Tract, South 89°38'30" West 475.06 feet;

thence (21), North 89°44'17" West 777.16 feet to the southeast corner of the first parcel as described in the deed to Archie M. Hunt, recorded in Book 224, Page 233 of Deeds in the Office of the County Recorder of said County;

thence (22), North 08°54'20" East 21.00 feet, along the westerly line of Parcel One as described in the deed to Daniel H. Gainey, Trustee of the Daniel H. Gainey Trust, dated 03/30/98 recorded August 13, 1998, as Instrument No. 98-061724 of Official Records of said County and also more fully shown on Record of Survey Book 44, Page 83 filed in said County Recorders Office; thence along the westerly line of said Daniel H. Gainey property and Record of Survey Book 44, Page 83 the following courses and distances;

thence (23), North 20°44'20" West 248.70 feet;

thence (24), North 09°08'20" West 125.90 feet;

thence (25), North 42°24'20" West 83.30 feet;

thence (26), North 59°15'00" East 30.20 feet;

thence (27), North 59°24'50" East 490.71 feet;

thence (28), North 14°11'20" West 307.37 feet;

thence (29), North 11°44'30" West 511.24 feet;

thence (30), North 08°06'00" East 442.56 feet;

thence (31), North 10°49'20" East 649.80 feet;

thence (32), North 00°13'20" West 337.40 feet;

thence (33), North 01°23'00" West 426.95 feet;

thence (34), North 00°24'10" East 273.32 feet;

thence (35), North 01°24'20" East 404.90 feet;

thence (36), North 30°56'15" East 155.37 feet;

thence (37), North 74°49'00" East 132.75 feet;

thence (38), North 11°56'10" East 247.11 feet;

thence (39), North 22°28'20" East 148.28 feet;

thence (40), North 25°23'10" East 297.99 feet;

thence (41), North 14°33'50" East 216.63 feet;

thence (42), North 35°05'50" East 260.40 feet;

thence (43), North 64°22'50" East 191.40 feet;

thence (44), North 57°24'10" East 191.03 feet;

thence (45), North 39°57'10" East 289.50 feet;

thence (46), North 15°43'10" East 355.10 feet;

(continued)

thence (47), North 22°20'10" East 272.60 feet;  
thence (48), North 23°55'10" East 86.90 feet;  
thence (49), North 50°29'30" East 396.83 feet more or less, to the intersection with the northwesterly prolongation of that certain course shown as N 89°39'40" W 584.70' of said Record of Survey Book 44, Page 83;  
thence (50), South 89°39'40" East 552.23 feet more or less, to the westerly terminus of said course;  
thence (51), South 00°40'30" West, along the westerly line of the Santa Ynez Airport as shown on map of survey filed as County Survey Map No. 695 in the Office of the County Surveyor of said County, 616.55 feet;  
thence (52), South 81°44'40" East, along the southerly line of said airport, 3504.49 feet to a point in the westerly line of that certain 139.02 acre parcel as shown on said map of survey filed in Book 117, Page 47 of Record of Surveys;  
thence (53), leaving said southerly airport line, South 00°19'05" West 929.45 feet to the southwest corner of said 139.02. acre parcel;  
thence (54), South 89°40'55" East, along the south line of said 139.02 acre parcel 317.02 feet to the northwest corner of said 102.00 acre parcel;  
thence (55), South 00°19'05" West 1564.48 feet to the southwest corner of said 102.00 acre parcel;  
thence (56), South 89°40'55" East, along the south line of said 102.00 acre parcel, 2840.00 feet to the Point of Beginning;

Also being Parcel 2 of Lot Line Adjustment No. 99-LA-011 in the County of Santa Barbara, State of California, filed October 26,2000, in Book 170, Pages 60 and 61 of Records of Surveys in the Office of County Recorder of said County.

Excepting therefrom that portion of said Parcel 2 of Lot Line Adjustment No. 99-LA-011 as conveyed by Grant Deed per Instrument No. 2007-0077430 O.R., described as follows:

Beginning at the southeasterly corner of a parcel of land shown on Record of Survey Book 117, Page 47 of Records of Surveys recorded with said County as a 102.00 acre parcel, said corner being on the westerly right of way of Meadowlark Road, 60 feet in width, as shown on said map;

thence (1), South 00°18'20" West 369.24 feet along said westerly line of Meadowlark Road to a point on the northerly line of the tract of land as described as Parcel One in the deed to Bryant E. Meyers, et ux., recorded July 7, 1953, as Instrument No. 11161, in Book 1165, Page 280 of Official Records of said County,

thence (2), North 84°13'00" West 523.99 feet along said Meyers Tract the following bearings and distances;

thence (3), North 82°40'30" West 1357.92 feet to a point;

thence (4), South 44°39'00" West 935.86 feet to a point;

thence (5), North 89°40'55" West 1377.64 feet to a point;

(continued)

thence (6), North 00°19'05" East 1174.28 feet to a point;  
thence (7), South 89°40'55" East 744.00 feet to a point;  
thence (8), North 00°19'05" East 1213.31 feet to a ½" pipe, being the southwesterly corner of a 139.02 acre parcel as shown on a Record of Survey Book 117, Page 47 of Records of Surveys recorded with said County;  
thence (9), South 89°40'55" East along the southerly line of said 139.02 acre parcel, 317.02 feet to the northwest corner of said 102.00 acre parcel,  
thence (10), South 00°19'05" West 1564.48 feet to the southwest corner of said 102.00 acre parcel;  
thence (11), South 89°40' 55" East along the southerly line of said 102.00 acre parcel 2840.00 feet to the Point of Beginning.



APPROVED AS TO FORM  
AND SURVEY CONTENT

*Aleksandar Jevremovic*  
ALEKSANDAR JEVREMOVIC, PLS 8378  
COUNTY SURVEYOR  
LICENSE EXP. 12/31/2017

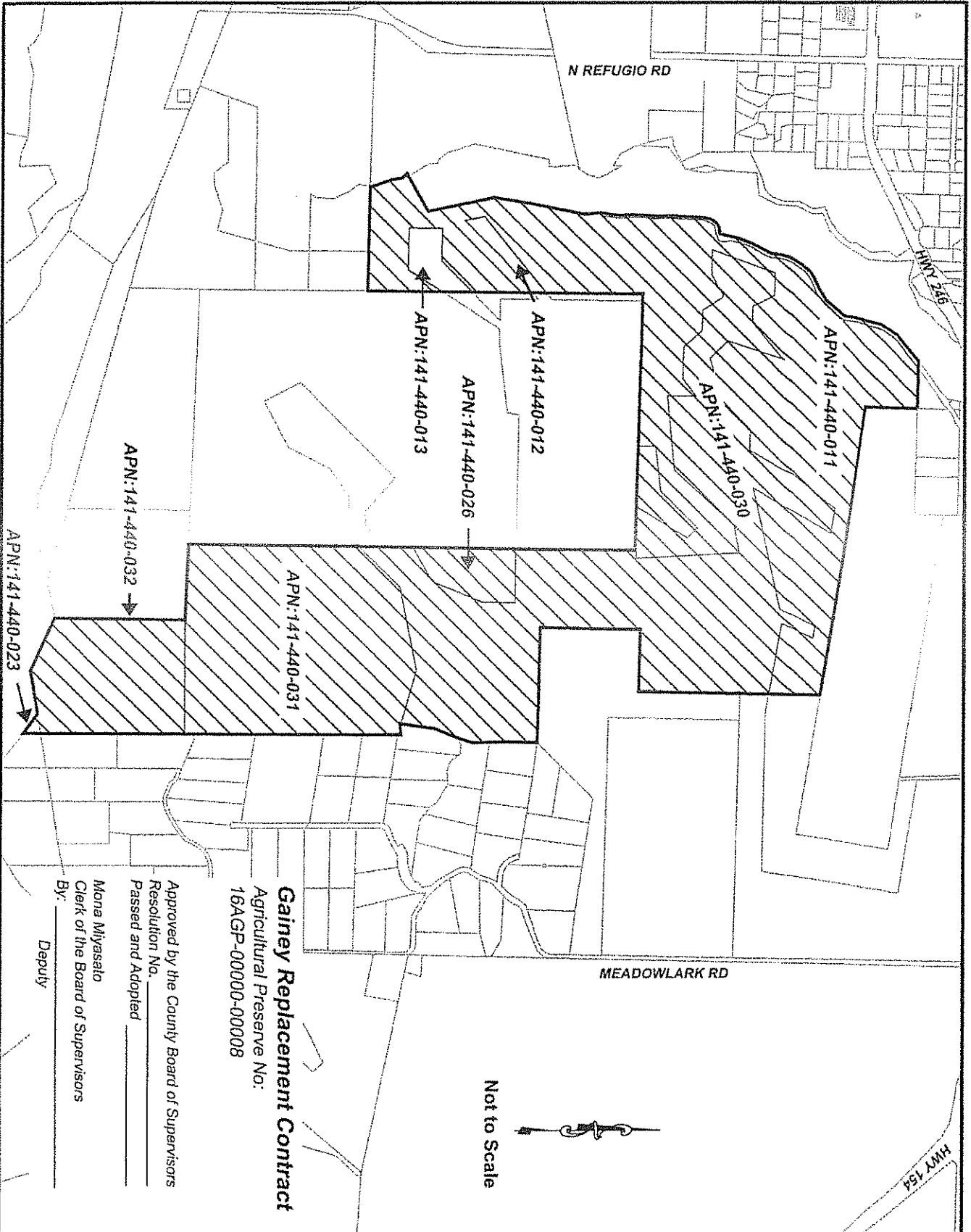

N REFUGIO RD

HWY 154

APN:141-440-011

APN:141-440-030

APN:141-440-012

APN:141-440-026

APN:141-440-013

APN:141-440-031

APN:141-440-032

APN:141-440-023

MEADOWLARK RD

HWY 154



Not to Scale

**Gainey Replacement Contract**  
 Agricultural Preserve No:  
 16AGP-00000-00008

Approved by the County Board of Supervisors  
 Resolution No. \_\_\_\_\_  
 Passed and Adopted \_\_\_\_\_  
 Mona Miyasato  
 Clerk of the Board of Supervisors  
 By: \_\_\_\_\_  
 Deputy