

Attachment A

ANNEXATION MAP No.8 OF COMMUNITY FACILITIES DISTRICT NO. 2002-1

COUNTY OF SANTA BARBARA - STATE OF CALIFORNIA

CLERK OF THE BOARD'S STATEMENT

I HEREBY CERTIFY THAT THE WITHIN MAP SHOWING ANNEXATION No. 8 OF COMMUNITY FACILITIES DISTRICT 2002-1 (ORCUTT COMMUNITY PLAN) COUNTY OF SANTA BARBARA, STATE OF CALIFORNIA, WAS APPROVED BY THE BOARD OF SUPERVISORS OF THE COUNTY OF SANTA BARBARA AT A REGULAR MEETING THEREOF, HELD ON THE ____ DAY OF _____, 2023, BY RESOLUTION NO. _____.

FILED IN THE OFFICE OF THE COUNTY CLERK, COUNTY OF SANTA BARBARA THIS ____ DAY OF _____ 2023.

MONA MIYASATO
CLERK OF THE BOARD OF SUPERVISORS OF SANTA BARBARA COUNTY BY: _____
DEPUTY

COUNTY RECORDER'S STATEMENT

FILED THIS ____ DAY OF _____, 2023, AT THE HOUR OF ____ O'CLOCK ____ M. IN BOOK ____ OF MAPS OF ASSESSMENT AND COMMUNITY FACILITIES DISTRICTS AT PAGE(S) _____, IN THE OFFICE OF THE COUNTY RECORDER IN THE COUNTY OF SANTA BARBARA, STATE OF CALIFORNIA.

JOSEPH E. HOLLAND
COUNTY CLERK - RECORDER - ASSESSOR BY: _____
DEPUTY

COUNTY SURVEYOR'S STATEMENT

THIS MAP WAS PREPARED UNDER MY DIRECTION IN ACCORDANCE WITH CALIFORNIA GOVERNMENT CODE SECTION 27557, AT THE REQUEST OF THE TREASURER - TAX COLLECTOR OF SANTA BARBARA COUNTY. I CERTIFY THE EXISTING DISTRICT LINES SHOWN HEREON ARE CONSISTENT WITH COMMUNITY FACILITIES DISTRICT NO. 2002-1 APPROVED BY THE BOARD OF SUPERVISORS OF THE COUNTY OF SANTA BARBARA, ON THE 2nd DAY OF February, 2016, BY ORDINANCE NO. 4955, RECORDED AT BOOK 4 OF MAPS OF ASSESSMENT AND COMMUNITY FACILITIES DISTRICTS AT PAGE(S) 71-72, IN THE OFFICE OF THE COUNTY RECORDER FOR THE COUNTY OF SANTA BARBARA, STATE OF CALIFORNIA. I ALSO CERTIFY THAT THE ANNEXED AREA SHOWN IS CONSISTENT WITH ANNEXATION No. 8 OF SAID DISTRICT.

ALEKSANDAR _____ DATE _____
COUNTY SURVEYOR
P.L.S. 5899
LICENSE EXPIRATION DATE 12/31/2023

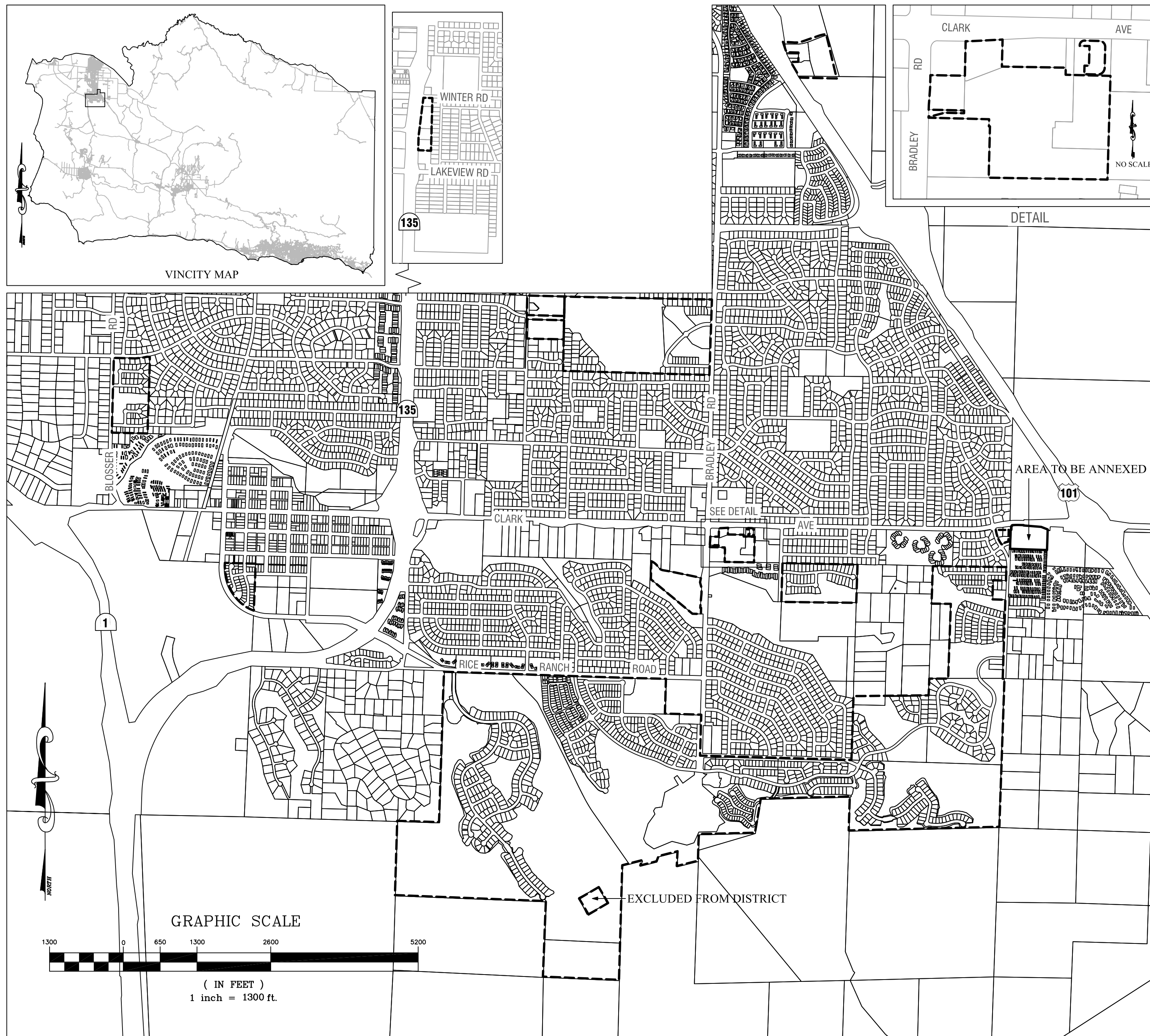

LEGAL DESCRIPTION (APN) ANNEXATION No.8 (ORCUTT GATEWAY RETAIL COMMERCIAL CENTER / KEY SITE 2)

ASSESSOR PARCEL NUMBER: 129-280-001

LEGEND

- COMMUNITY FACILITIES DISTRICT BOUNDARY
- ANNEXATION No.8 (ORCUTT GATEWAY RETAIL COMMERCIAL CENTER / KEY SITE 2)

**ANNEXATION NO. 8 OF
COMMUNITY FACILITIES DISTRICT 2002-1
(ORCUTT COMMUNITY PLAN)
COUNTY OF SANTA BARBARA, STATE OF CALIFORNIA**

SHEET
1 OF 1