

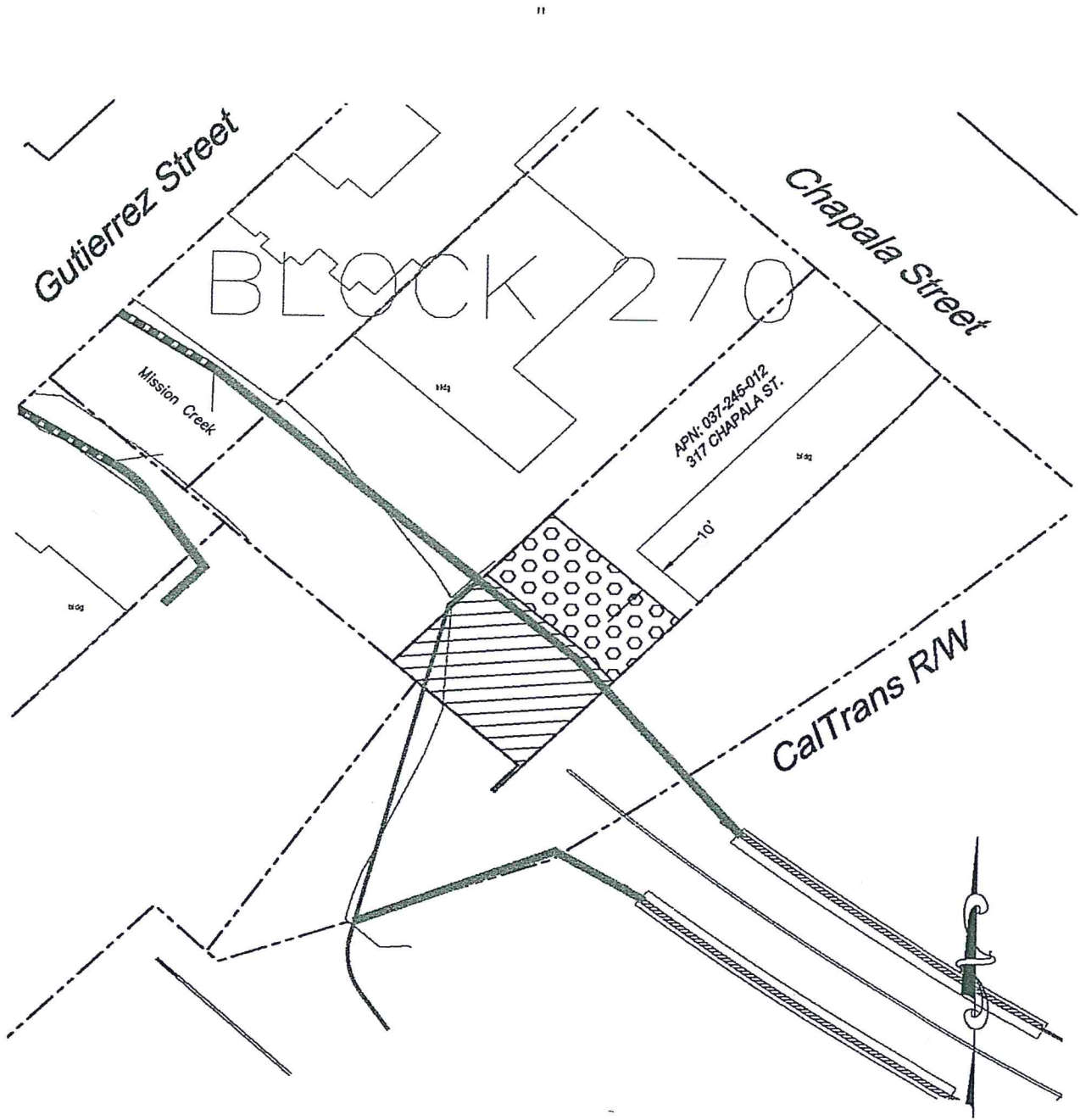



ATTACHMENT E

**Permanent
and
Temporary Construction
Easements**



-  PERMANENT EASEMENT
APPROX. EASEMENT AREA=2,936 sq.ft.
-  TEMPORARY CONSTRUCTION EASEMENT
APPROX. EASEMENT AREA=2,108 sq.ft.
-  EXISTING CHANNEL WALL
-  CHANNEL WALL TO BE CONSTRUCTED

EASEMENTS
SANTA BARBARA COUNTY
FLOOD CONTROL DISTRICT
APN: 037-245-012
SANTA BARBARA COUNTY, CALIFORNIA