

LEGAL DESCRIPTION  
BRADLEY ROAD UNDERGROUND UTILITIES  
From Amethyst Drive to ~525 feet north of Larch Avenue

Those portions of Sections 1, 2, 11 & 12, Township 9 North, Range 34 West San Bernardino Base and Meridian, in the County of Santa Barbara, in the State of California described as follows:

Beginning at the intersection of the most northerly line of Bradley Road Underground Utilities District as shown on Board of Supervisors Resolution Number 85-226 recorded June 25, 1985, filed in the County Clerk's Office in said County and the east line of Lot 44 as shown on Subdivision Map Tract Number 10,382 recorded in Book 75, Page 73 of Map Book filed in the Office of the County Recorder in said County

1. Thence, north along the west line of Bradley Road which is coincident with the east line of said Lot 44 to the northeast corner of said Lot 44;
2. Thence, continuing north along the west line of Bradley Road as shown on "EASEMENT FOR PUBLIC ROAD AND FOR CUT AND FILL SLOPE" recorded April 26, 1962 as Instrument Number 17041 in Book 1922 Page 388 of Official Record to the north line of a parcel containing 79.34 Acres as shown in Book 146, Page 26 of Record of Survey filed in said Office of the County Recorder;
3. Thence, continuing north along the west line of Bradley Road as shown on "RIGHT OF WAY GRANT" recorded February 16, 1962 as Instrument Number 6370 in Book 1904, Page 206 to the north line of Parcel C as shown on Tract Number 11721 in Book 90, Page 83 of Map Book, also being the southeast corner of Lot 18 as shown on TRACT NUMBER 10,204 UNIT NO. 1 in Book 71, Page 13 of Map Book file in said County Recorder's Office;
4. Thence, north along said west line of Bradley Road 8.96 feet of which is coincident with the east line of said Lot 18 to the most southerly corner of Lot 84 as shown on said TRACT;
5. Thence, northwesterly along the southwest line of said Lot 84 a distance 164.88 feet to a point of cusp with a curve concave northwest having a radius of 40.00 feet and being a point on the easterly line of Brookside Avenue cul-de-sac;
6. Thence, northerly along said curve and the west line of said Lot 84 a distance 40.49 feet through a central angle of 58°00'00" to the northwest corner of said Lot 84;
7. Thence, easterly along the north line of said Lot 84 a distance 102.61 feet to northeast corner of said Lot 84 and being a point on the west line of Bradley Road as shown on said TRACT NUMBER 10,204;
8. Thence, north along said west line of Bradley Road to the northeast corner of Lot 83 as shown on said TRACT NUMBER 10,204, also being the southeast corner of Lot 14 as shown on TRACT NUMBER 12,554 in Book 96, Page 56 of Map Book filed in said County Recorders Office and being a point of the west line of Bradley Road as shown in RIGHT OF WAY GRANT recorded March 15, 1962 as Instrument Number 10329 in Book 1910, Page 690 of Official Record filed in said County Recorder's Office;
9. Thence, north 999.03 feet along the west line of Bradley Road parallel with and 42.00 feet west of the centerline of Bradley Road to the north line of Foster Road as shown on said TRACT NUMBER 12,554;

**EXHIBIT A**

LEGAL DESCRIPTION  
BRADLEY ROAD UNDERGROUND UTILITIES  
From Amethyst Drive to ~525 feet north of Larch Avenue

10. Thence, north along said west line of Bradley Road parallel with and 42.00 feet west of the centerline of Bradley Road 1485.76 feet to the beginning of a tangent curve, concave west having a radius of 913.37 feet;
11. Thence, northerly along said curve and west line of said Bradley Road a distance of 370.71 feet through a central angle of 23°15'17" to the northeast corner of Lot 20 as shown on TRACT NUMBER 12,364 in Book 96, Page 49 of Map Book filed in said County Recorder's Office;
12. Thence, northeasterly along a prolongation of the radial of said curve 84.00 feet to a concentric curve having a radius of 997.37 feet and easterly line of Bradley Road parallel with and 42.00 feet east of the centerline of Bradley Road;
13. Thence, southerly along said curve and easterly line of Bradley Road parallel with and 42.00 feet east of the centerline of Bradley Road a distance of 404.80 feet through a central angle of 23°15'17";
14. Thence, continuing southerly along said east line of Bradley Road parallel with and 42.00 feet east of the centerline of Bradley Road to the southwest corner of Parcel C as shown on Parcel Map Number 12,345 recorded in Book 17, Page 84 of Parcel Map;
15. Thence, along said east line of Bradley Road to the westerly prolongation of the north line of Lot 60 as shown on TRACT NUMBER 12,412 recorded in Book 96, Page 78 of Map Book filed in said Office of the County Recorder;
16. Thence easterly along said prolongation of the north line 9.44 feet to the northwest corner of said Lot 60;
17. Thence, southerly along east line of Bradley Road which is coincident with the west line of Lot 60 and Lots 1 through 5 of said TRACT NO. 12,412 to the southwest corner of Lot 5 as shown on said TRACT NO. 12,412;
18. Thence, continuing southerly along the east line of Bradley Road to a point on the west line of Lot 28, distant north 84.20 feet from the southwest corner of said Lot 28 as shown on TRACT 13,363 recorded in Book 126, Page 88 of Map Book filed in said Office of the County Recorder;
19. Thence, continuing southerly along the east line of Bradley Road which is coincident with the west line of Lots 28 through 23 of said TRACT 13,363 to the southwest corner of said Lot 23;
20. Thence, west 5.73 feet to the northwest corner of Lot 1 as shown on TRACT 12,447 recorded in Book 121, Page 67 of Map Book filed in said Office of the County Recorder;
21. Thence, continuing southerly along the east line of Bradley Road which is coincident with the west line of Lots 1 through 7 of said TRACT 12,477 to southwest corner of said Lot 7 and also being the northwest corner of Lot 10 as shown on TRACT 12,476 Unit 1 recorded in Book 96, Page 82 and 83 of Map Book filed in said Office of the County Recorder;
22. Thence, continuing southerly along the east line of Bradley Road which is coincident with the west line of Lots 10 through 22 of said TRACT 12,476 UNIT 1 to southwest corner of Lot 22 as shown on said TRACT 12,476 UNIT 1 and also being the northwest corner of Lot 290 as shown on TRACT 10,004 UNIT 7 recorded in Book 53, Page 6 of Map Book filed in said Office of the County Recorder;
23. Thence, continuing southerly along the east line of Bradley Road which is coincident with the west line Lot 290 of said TRACT 10,004 UNIT 7 to the most northerly line of

LEGAL DESCRIPTION  
BRADLEY ROAD UNDERGROUND UTILITIES  
From Amethyst Drive to ~525 feet north of Larch Avenue

said Bradley Road Underground Utilities District as shown on Board of Supervisors Resolution Number 85-226;  
24. Thence, leaving the east line of Bradley Road west along said northerly line 84.00 feet to the Point of Beginning.

END OF DESCRIPTION

This Legal Description was prepared by me or under my direction in conformance with the requirements of the Professional Land Surveyors Act

E. Teñell Matlovsky  
E. Teñell Matlovsky, PLS8629



02/11/2013

Date

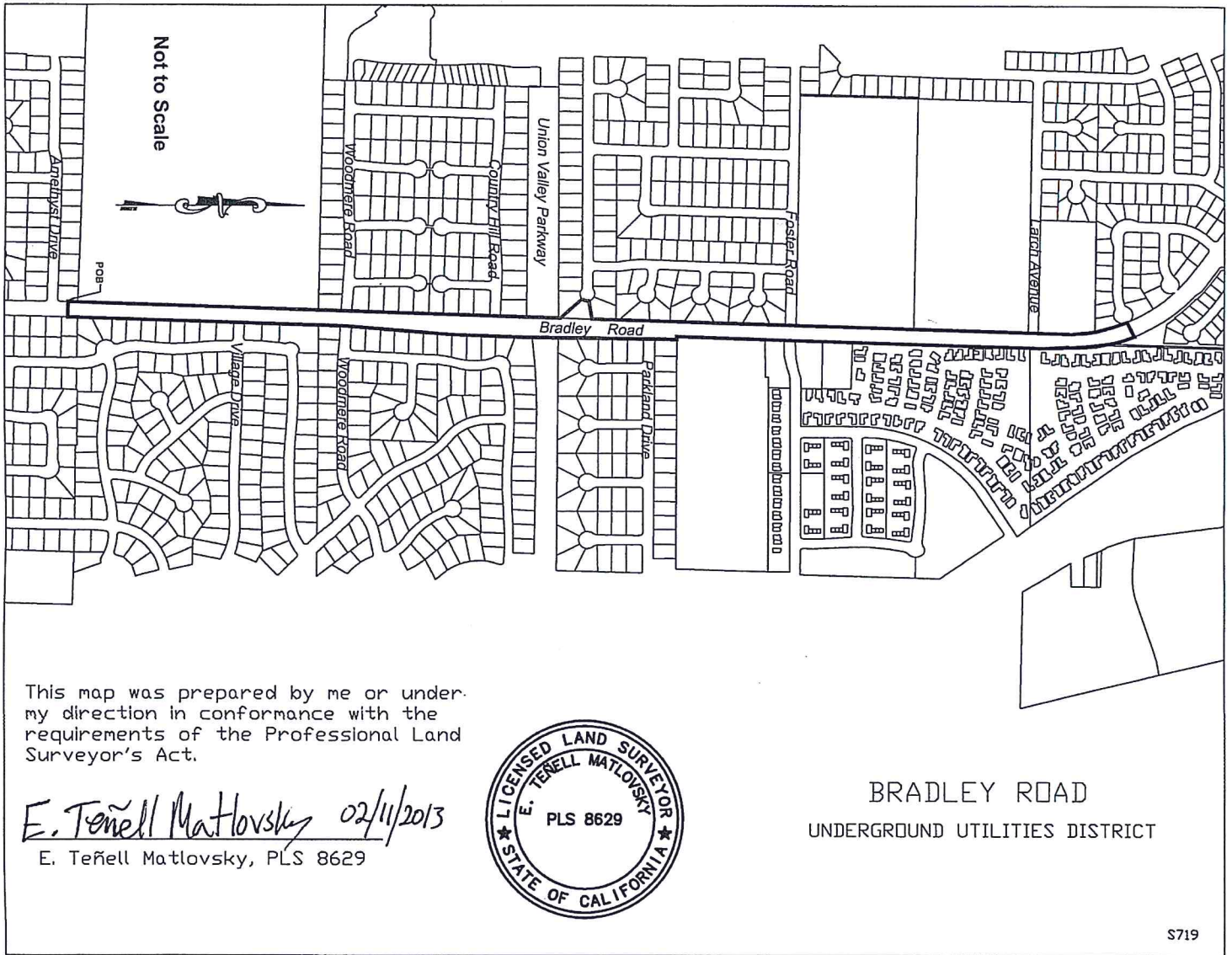

**EXHIBIT B**