

**AREA MAP**  
NO SCALE

**LEGEND:**

- ① = 40' road R / W rec. per Dds. Bk 26 pg. 346
- ② = private road not a public road
- \*1 = rec. per O.R. Bk. 1244 pg. 289
- \*2 = rec. per R / S bk. 35 pg. 75
- \*3 = rec. per O.R. Bk. 1342 pg. 101 ; O.R. Bk. 2122 pg. 106 ; O.R. Instr. No. 90 - 0074289
- \*4 = rec. per R / S bk. 37 pg. 52
- \*5 = rec. per O.R. Bk. 1444 pg. 436
- \*6 = rec. per O.R. Bk. 1939 pg. 287
- ① = replacement sewer service lateral for Parcel Two
- ② = proposed 20 foot wide private sanitary sewer and private utility easement for the benefit of 740 Arcady Road
- ③ = stub at main for future sewer service lateral for Parcel One
- ④ = existing water meter - service for Parcel Two
- ⑤ = existing water meter - service for Parcel One ( future )
- ⑥ = 13.7' tie

**EASEMENT NOTES**

The following easements affecting the subject property - the exact location and extent of the easement is not disclosed of record.  
 Deeds Bk. 38 pg. 391  
 Deeds Bk. 57 pg. 206  
 Deeds Bk. 131 pg. 290  
 O.R. Bk. 705 pg. 203

**NOTE :**

Topographic information shown hereon taken from Santa Barbara County Flood Control aerial topo (NAVD 1988 Datum). Location of existing residence as shown hereon is based on a field survey .

We hereby apply for the Lot Line Adjustment of real property shown on this plat and certify that we are the owners or the authorized agent of the legal owners of said property and that the information shown hereon is true and correct to the best of our knowledge and belief.

**PROJECT INFORMATION**

**OWNERS :** Craig Hawker / Athena Philippides  
 1420 Greenworth Place  
 Santa Barbara , Ca. 93108  
**SITE ADDRESSES :** 3140 Eucalyptus Hill Road ( A.P.N. 013 - 191 - 14 )  
 740 Arcady Road ( A.P.N. 013 - 191 - 15 )  
**ZONING :** 2 - E - 1  
**Land Use Designation :** SRR - 0.5  
**Services :** electric / gas / water / telephone / sewer : PARCEL ONE - existing in place  
 PARCEL TWO - existing in place  
**Existing Parcels :** Parcel One ( 013 - 191 - 14 ) = 43,556 sq.ft. / 1.0 ac. gross  
 43,273 sq.ft. / 0.99 ac. net  
 Parcel Two ( 013 - 191 - 15 ) = 8,101 sq.ft. / 0.19 ac. gross and net  
**Proposed Parcels :** Parcel One = 29,990 sq.ft. / 0.69 ac. gross  
 29,707 sq.ft. / 0.68 ac. net  
 Parcel Two = 21,667 sq.ft. / 0.50 ac. gross and net

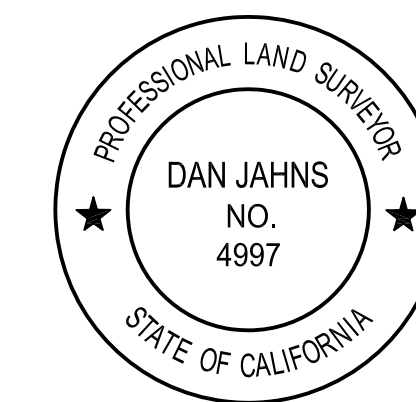

16LLA - 00000 - 00003  
**TENTATIVE MAP**  
 PROPOSED LOT LINE ADJUSTMENT BETWEEN TWO PARCELS  
 IN A PORTION OF THE OUTSIDE PUEBLO LANDS OF THE CITY  
 OF SANTA BARBARA .  
 COUNTY OF SANTA BARBARA  
 MAY 2019 SCALE : AS SHOWN

**SURVEYING SERVICES**  
 P . O . BOX 989 CARPINTERIA , CA. 93014

C:\Users\SSD\Documents\0-Surveying\Surveying\Hawker TM-LLA\HAWKER TentativeMap\16-20190521.dwg Tentative Map 5/21/2019 8:36:58 PM, 11