



BOARD OF SUPERVISORS
AGENDA LETTER

Agenda Number:

Clerk of the Board of Supervisors
105 E. Anapamu Street, Suite 407
Santa Barbara, CA 93101
(805) 568-2240

Department Name: Flood Control
Department No.: 054
For Agenda Of: 7/02/13
Placement: Administrative
Estimated Tme: NA
Continued Item: No
If Yes, date from:
Vote Required: Majority

TO: Board of Directors, Flood Control and Water Conservation District

FROM: Department Scott D. McGolpin, Public Works Director, 568-3010
Director(s)
Contact Info: Thomas D. Fayram, Deputy Public Works Director, 568-3436

SUBJECT: Lower Mission Creek Flood Control Project – Reach 2B, Phase 1, Santa Barbara,
Second Supervisorial District

County Counsel Concurrence

As to form: Yes

Other Concurrence: N/A

As to form:

Auditor-Controller Concurrence

As to form: N/A

Recommended Actions:

- a) Approve and authorize the Chair to execute the Statement of Final Quantities for work performed and materials supplied for the Lower Mission Creek Flood Control Project – Reach 2B, Phase 1, by the contractor Lash Construction, Inc. in the amount of \$2,144,105.86; and
- b) Find that pursuant to the California Environmental Quality Act (CEQA) Section 15162, no new effects will occur and no new mitigation measures would be required as a result of the proposed action and therefore pursuant to CEQA Section 15162, the Lower Mission Creek Flood Control Project Reach 2B, Phase 1 is within the scope of the project covered by the EIS/EIR for the Lower Mission Creek Flood Control Project as well as the Findings and Statement of Overriding Considerations accepted by the Board as a Responsible Agency on May 11, 2011, and no new environmental document is required. The Findings, Statement of Overriding Considerations, EIS/ EIR, and associated information can be found at:
<http://santabarbara.legistar.com/LegislationDetail.aspx?ID=874496&GUID=D14C4C9B-DEDF-48CB-AB30-D52A228FB5A2>

Summary Text:

The City of Santa Barbara (City) and the County continue to focus on implementation of elements of the Lower Mission Creek Flood Control Project below US 101. Reach 2B, Phase 1 of the Project is a portion of the bypass culvert that runs from the UPRR tracks to Montecito Street (see Exhibit 1, attached). This phase completes the box culvert improvements extending from the railroad tracks upstream to US 101. Construction of the bypass culvert portion (Reach 2A) on the downstream side of the tracks will proceed with construction of the downstream channel segments in the future. Construction of the bypass culvert portion (Reach 2B-2) through US 101 will occur when all downstream elements of the project are complete.

On June 19, 2012, the Board entered into an agreement with Lash Construction, Inc. to construct the Lower Mission Creek Flood Control Project – Reach 2B, Phase 1, in the amount of \$2,089,787.50 with a contingency approved in the amount of \$116,989.38. This project was completed at a cost of \$2,144,105.86. The extra costs were mostly attributed to the unknowns encountered at the site, which included an unmapped archeological site, soils that required special handling, post-bid City permitting requirements, buried man-made objects encountered in Montecito Street, and uncertain (location and type) landscaping and electrical facilities encountered in the City park. The Flood Control District has accepted the work of the contractor Lash Construction, Inc., completed on-time and per plans and specifications. On May 21, 2013, the Public Works Director signed and executed a Notice of Completion (NOC) for the project and the NOC was sent to the Clerk Recorder's office to be recorded.

Background:

The Lower Mission Creek Flood Control Project is a federal U.S. Army Corps of Engineers (Corps) project that has been under study and development since the 1960s. The City and the County worked with a community consensus group in the 1990s to develop the current project which focuses on both flood control and environmental issues.

The Corps completed the Feasibility Study over 10 years ago but has been slow to get adequate funding for design and construction. Since that time, the City and County have been working on finding opportunities to construct elements of the project as funding options arise.

With the completion of Reach 2B, Phase 1, the box culvert is now complete from the south side of US 101 to the south side of the railroad tracks. The box culvert under the railroad tracks was installed in January 2009 and the widening of the creek channel upstream of State Street, approximately half way to Mason Street, Reach 1A-1, was completed in February 2012.

Fiscal and Facilities Impacts:

Budgeted: Yes

Fiscal Analysis:

<u>Funding Sources</u>	<u>Current FY Cost:</u>	<u>Annualized On-going Cost:</u>	<u>Total One-Time Project Cost</u>
South Coast FZ			\$2,144,105.86
State			
Federal			
Fees			
Other:		-	
Total	\$	- \$	\$ 2,144,105.86

Narrative:

Costs for this phase of Lower Mission Creek Flood Control Project were included in the adopted 2012-13 and the proposed 2013-14 budget under the Water Resources Division of the Public Works Department. No General Fund will be utilized with these actions.

This project is also included in Capital Improvement Program on page B-61.

Special Instructions:

Direct the Clerk of the Board to a copy of the Statement of Final Quantities and the minute order to the Flood Control District office, Attn: Christina Lopez.

Attachments:

Exhibit 1: Map
Statement of Final Quantities

Authored by: Jonathan S. Frye, Engineering Manager, 568-3444

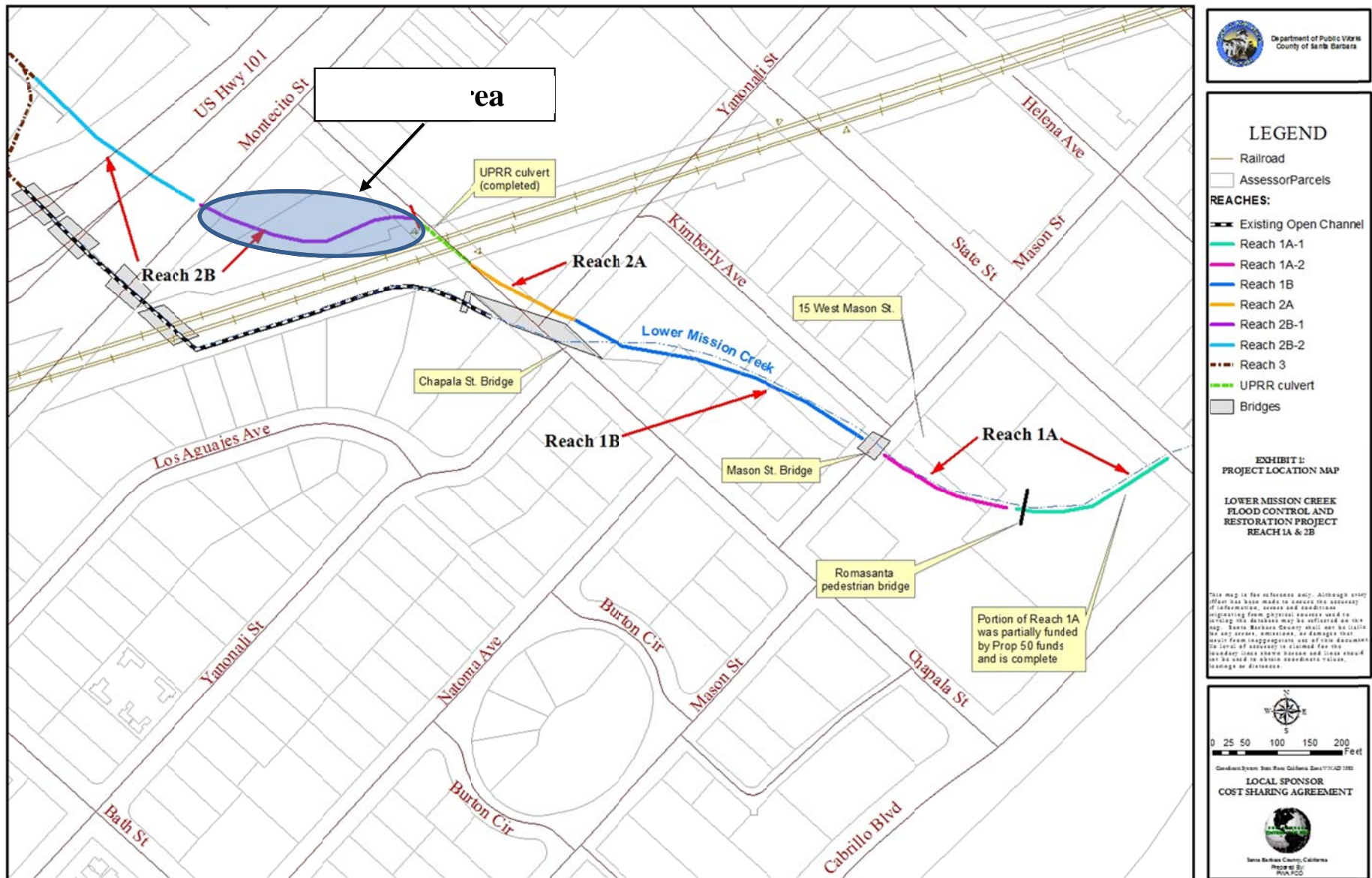

Exhibit 1