

AGRICULTURAL PRESERVE CONTRACT

14AGP-00000-00023

LEGAL DESCRIPTION

THE LAND REFERRED TO HEREIN BELOW IS SITUATED IN THE UNINCORPORATED AREA, COUNTY OF SANTA BARBARA, STATE OF CALIFORNIA, AND IS DESCRIBED AS FOLLOWS:

That portion of Subdivision No. 13 of the Partition of the Rancho Punta de la Laguna, in the County of Santa Barbara, State of California, allotted to Maria Ygnacia Elizalde in the Final Decree of Partition in Santa Barbara County Superior Court Action No. 12, entitled "S. I. Jamison, et al., vs. Luis Arellanes, et al., "a certified copy of which decree is recorded in Book "W", Page 333 of Deeds, records of said County, and as shown on map of said partition referred to as "Exhibit A" in commissioners report in said matter, described as follows:

Beginning at the Northeast corner of said Subdivision No. 13, being the quarter section corner common to Section 31, Township 10 North, Range 34 West and Section 36, Township 10 North, Range 35 West, San Bernardino Meridian, as shown on Map of Partition above referred to; thence North 89° 52' West through the center of said Section 36, 5374.4 feet to file quarter section corner of said Section 36 in the center of Guadalupe Lake, being the Northwesterly corner of that portion of said Subdivision No. 13 allotted and set apart to Eliza Pauline Elizalde in Final Decree of Partition in Santa Barbara County Superior Court Action No. 3255, entitled "Louisa Elizalde de Quintero, Plaintiff vs. Victoria C. Elizalde, et al., Defendants", a certified copy of said decree being recorded December 19, 1896 in Book 58, Page 602 of Deeds, records of said County;

Thence South 45° 18' East along the Westerly line of said last mentioned tract of land 3544.7 feet to an angle point in said line and the Northeast corner of the tract of land allotted and set apart to Ernest C. Graves by said Decree last above referred to;

Thence South 36° 15' West continuing along said Westerly line of said tract and land set apart to Eliza Pauline Curletti, above referred to 443.05 feet to the Northeasterly line of State Highway No. 1 described in deed to the State of California from Eliza Pauline Elizalde, also known as Eliza Pauline Curletti, recorded July 16, 1948 in Book 793, Page 284 of Official Records, records of said County;

thence along said Northeasterly line, as described in said deed, the following courses and distances:

South 50° 04' 30" East 194.90 feet; South 51° 30' 30" East 2400.00 feet; South 55° 19' 20" East 300.67 feet; and

South 51° 30' 30" East 1045.91 feet to a point in the Easterly line of said Subdivision No. 13 hereinbefore referred to;

Thence North along said Easterly line of said Subdivision No. 13, 5210.88 feet, more or less, to the point of beginning.

EXCEPTING THEREFROM that portion thereof conveyed to the State of California by deed recorded July 16, 1948 as Instrument No. 9890 in Book 793 at Page 284 of Official Records.

ALSO EXCEPTING THEREFROM any portion lying southerly of the northerly line of the 60.00 foot strip of land allotted for road purposes defined in paragraph No. 3 by final decree of partition of the Superior Court in and for said County, wherein said Louisa Elizalde de Quintero was sole plaintiff and Victoria C. Elizalde and Eliza Pauline Elizalde and others were defendants, recorded June 8, 1896 in Book 57 of Deeds, Page 469, in the office of the County Recorder of said County and State.

ALSO EXCEPTING THEREFROM that portion conveyed to Laguna County Sanitation District by Grant Deed recorded 06/30/2014 as Instrument No. 2014-0029515 of Official Records in the office of the County Recorder of said County and State.

APN: 113-240-002 (portion)



APPROVED AS TO FORM
AND SURVEY CONTENT

E. Tenell Matlovsky

Deputy:
COUNTY SURVEYOR
LICENSE EXP. 12/31/2015

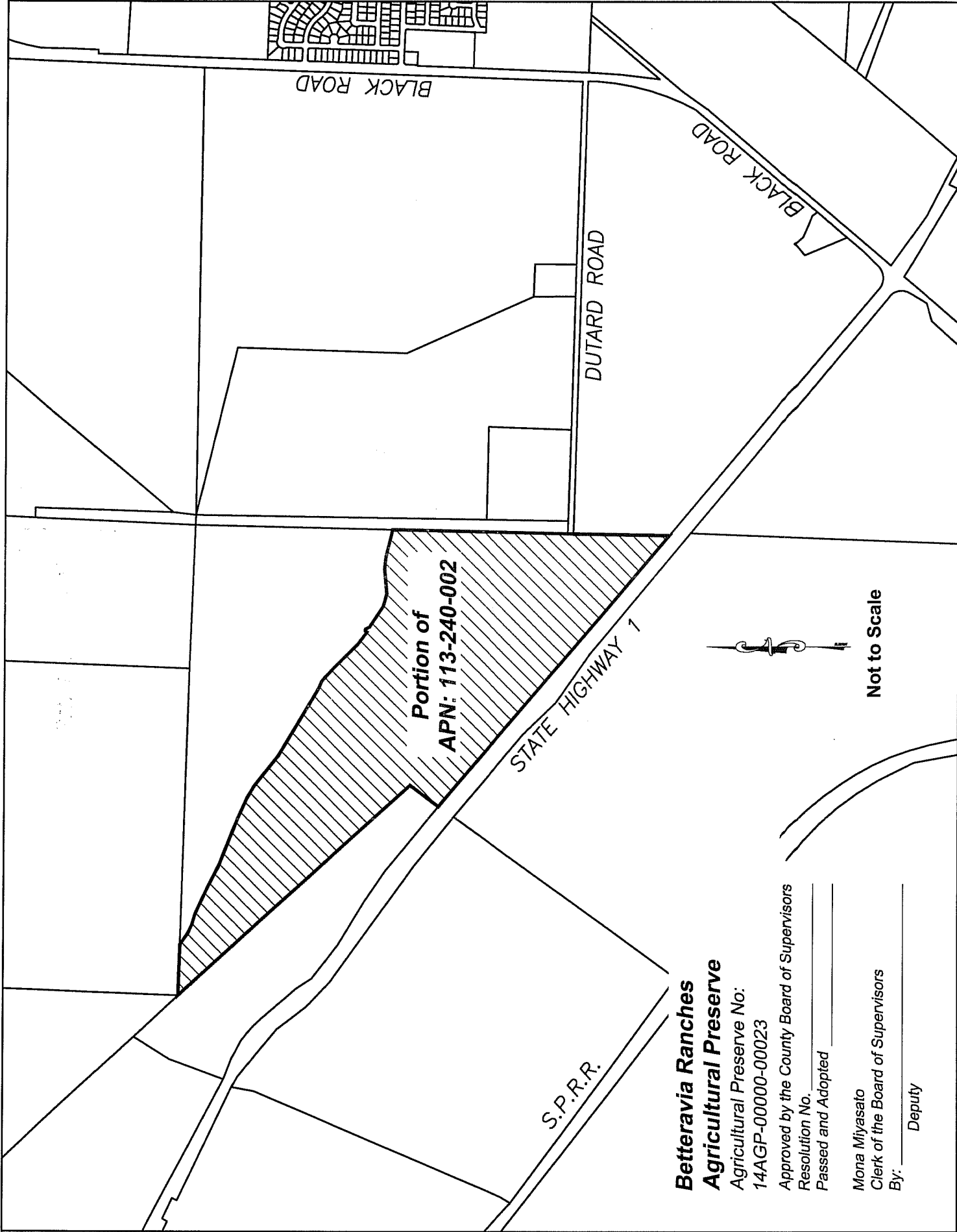

**Betteravia Ranches
Agricultural Preserve**

Agricultural Preserve No:
14AGP-00000-00023

Approved by the County Board of Supervisors
Resolution No. _____
Passed and Adopted _____

Mona Miyasato
Clerk of the Board of Supervisors
By: _____ Deputy