

# Agricultural Preserve

## 14AGP-00000-00019

### LEGAL DESCRIPTION

Real property in the unincorporated area of the County of Santa Barbara, State of California, described as follows:

ALL THAT CERTAIN LAND SITUATED IN THE STATE OF CALIFORNIA, IN THE UNINCORPORATED AREA OF THE COUNTY OF SANTA BARBARA, BEING PARCEL FOUR OF THE TRACT OF LAND CONVEYED TO, AND DESCRIBED IN THE GRANT DEED TO G.P. SCHOENFELDER, RECORDED DECEMBER 18, 1979 AS NO. 79-56847 OF OFFICIAL RECORDS OF SAID COUNTY, ALSO BEING A PORTION OF THE RANCH CORRAL DE QUANTI, AS SAID RANCHO WAS CONVEYED BY THE UNITED STATES OF AMERICA TO MARIA ANTONIA DE LA GUERRA Y LATAILLADE, BY PATENT DATED AUGUST 7, 1876, RECORDED IN BOOK "A" OF PATENTS, PAGE 258, SANTA BARBARA COUNTY RECORDS, AND WHICH PORTIONS ARE PARTICULARLY DESCRIBED AS FOLLOWS:

BEGINNING AT THE INTERSECTION OF THE CENTER LINE OF THAT CERTAIN RIGHT OF WAY GRANT TO THE COUNTY OF SANTA BARBARA, RECORDED AUGUST 16, 1950 AS INSTRUMENT NO. 11647 IN BOOK 934, PAGE 487 OF OFFICIAL RECORDS, WITH THE EASTERLY LINE OF THE LAND CONVEYED TO THE STATE OF CALIFORNIA BY DEED RECORDED NOVEMBER 10, 1954 AS INSTRUMENT NO. 19565 IN BOOK 1269, PAGE 605 OF OFFICIAL RECORDS; THENCE NORTHWESTERLY ALONG THE EASTERLY LINE OF SAID LAND CONVEYED TO THE STATE OF CALIFORNIA, THE FOLLOWING COURSES AND DISTANCES: 1) NORTH 47° 47' 30" WEST A DISTANCE OF 25.00 FEET TO AN ANGLE POINT THEREIN; 2) NORTH 32° 53' 20" WEST, A DISTANCE OF 225.77 FEET TO AN ANGLE THEREIN; 3) NORTH 19° 04' 30" WEST, A DISTANCE OF 330.00 FEET; 4) NORTH 25° 38' 00" WEST, A DISTANCE OF 437.85 FEET TO AN ANGLE POINT THEREIN; 5) NORTH 2° 02' 20" EAST, 212.70 FEET; 6) NORTH 27° 04' 30" WEST, A DISTANCE OF 20.00 FEET TO AN ANGLE POINT THEREIN; 7) NORTH 37° 00' 40" WEST, A DISTANCE OF 191.05 FEET TO AN ANGLE POINT THEREIN; 8) NORTH 19° 04' 30" WEST, A DISTANCE OF 1107.99 FEET TO AN ANGLE POINT THEREIN; 9) NORTH 28° 39' 00" WEST, A DISTANCE OF 400.32 FEET TO AN ANGLE POINT THEREIN; 10) NORTH 30° 01' 40" WEST, A DISTANCE OF 376.25 FEET TO A POINT IN THE NORTHERLY BOUNDARY LINE OF THE LAND CONVEYED TO CHARLES L. COBB, A SINGLE PERSON, BY QUITCLAIM DEED RECORDED JUNE 19, 1953 AS INSTRUMENT NO. 10148 IN BOOK 1160, PAGE 489 OF OFFICIAL RECORDS; THENCE LEAVING THE EASTERLY LINE OF SAID LAND CONVEYED TO THE STATE OF CALIFORNIA AND ALONG THE NORTHERLY BOUNDARY LINE OF SAID LAND CONVEYED TO CHARLES L. COBB, THE FOLLOWING COURSES AND DISTANCES: 1) SOUTH 68° 54' EAST, A DISTANCE OF 102.85 FEET TO AN ANGLE POINT THEREIN; 2) SOUTH 68° 41' EAST, A DISTANCE OF 100.00 FEET TO AN ANGLE POINT THEREIN; 3) SOUTH 67° 06' EAST, A DISTANCE OF 50.00 FEET TO AN ANGLE POINT THEREIN; 4) SOUTH 65° 21' EAST, A DISTANCE OF 50.00 FEET TO AN ANGLE POINT THEREIN; 5) SOUTH 63° 11' EAST, A DISTANCE OF 50.00 FEET TO AN ANGLE POINT THEREIN; 6) SOUTH 61° 11' EAST, A DISTANCE OF 50.00 FEET TO AN ANGLE POINT THEREIN; 7) SOUTH 59° 10' EAST, A DISTANCE OF 51.00 FEET TO AN ANGLE POINT THEREIN; 8) SOUTH 57° 55' EAST, A DISTANCE OF 631.80 FEET TO AN ANGLE POINT THEREIN; 9) SOUTH 58° 12' EAST, A DISTANCE OF 50.00 FEET TO AN ANGLE POINT THEREIN; 10) SOUTH 60° 08' EAST, A DISTANCE OF 50.00 FEET TO AN ANGLE POINT THEREIN; 11) SOUTH 62° 42' EAST, A DISTANCE OF 50.00 FEET TO AN ANGLE POINT THEREIN; 12) SOUTH 70° 00' EAST, A DISTANCE OF 50.00 FEET TO AN ANGLE POINT THEREIN; 13) SOUTH 74° 53' EAST, A DISTANCE OF 50.00 FEET TO AN ANGLE POINT THEREIN; 14) SOUTH 79° 51' EAST, A DISTANCE OF 50.00 FEET TO AN ANGLE POINT THEREIN; 15) SOUTH 84° 55' EAST, A DISTANCE OF 50.00 FEET TO AN ANGLE POINT THEREIN; 16) SOUTH 89° 51' EAST, A DISTANCE OF 50.00 FEET TO AN ANGLE POINT THEREIN; 17) NORTH 85° 07' EAST, A

DISTANCE OF 50.00 FEET TO AN ANGLE POINT THEREIN; 18) NORTH 80° 04' EAST, A DISTANCE OF 50.00 FEET TO AN ANGLE POINT THEREIN; 19) NORTH 74° 58' EAST, A DISTANCE OF 50.00 FEET TO AN ANGLE POINT THEREIN; 20) NORTH 70° 00' EAST, A DISTANCE OF 50.00 FEET TO AN ANGLE POINT THEREIN; 21) NORTH 65° 27' EAST, A DISTANCE OF 50.00 FEET TO AN ANGLE POINT THEREIN; 22) NORTH 60° 03' EAST, A DISTANCE OF 50.00 FEET TO AN ANGLE POINT THEREIN; 23) NORTH 55° 05' EAST, A DISTANCE OF 50.00 FEET TO AN ANGLE POINT THEREIN; 24) NORTH 49° 53' EAST, A DISTANCE OF 50.00 FEET TO AN ANGLE POINT THEREIN; 25) NORTH 43° 56' EAST, A DISTANCE OF 50.00 FEET TO AN ANGLE POINT THEREIN; 26) NORTH 39° 13' EAST, A DISTANCE OF 50.00 FEET TO AN ANGLE POINT THEREIN; 27) NORTH 29° 13' EAST, A DISTANCE OF 50.00 FEET TO AN ANGLE POINT THEREIN; 28) NORTH 24° 29' EAST, A DISTANCE OF 50.00 FEET TO AN ANGLE POINT THEREIN; 29) NORTH 20° 20' EAST, A DISTANCE OF 50.00 FEET TO AN ANGLE POINT THEREIN; 30) NORTH 17° 17' EAST, A DISTANCE OF 50.00 FEET TO AN ANGLE POINT THEREIN; 31) SOUTH 89° 17' 00" EAST, A DISTANCE OF 1460.00 FEET, MORE OR LESS TO THAT POINT DESIGNATED AS ENGINEER STATION 38+79.03, IN THAT CERTAIN RIGHT OF WAY GRANT TO THE COUNTY OF SANTA BARBARA, RECORDED IN BOOK 848, PAGE 468 OF OFFICIAL RECORDS OF SAID COUNTY, SAID POINT BEING ON A CURVE CONCAVE TO THE WEST HAVING A RADIUS OF 716.20 FEET AND CENTRAL ANGLE OF 45° 45' 15", THE RADIAL CENTER OF WHICH BEARS SOUTH 80° 36' 15" WEST, THENCE SOUTHEASTERLY, SOUTHERLY AND SOUTHWESTERLY ALONG THE ARC OF SAID CURVE, 571.93 FEET; THENCE SOUTH 36° 21' 30" WEST, 946.20 FEET TO THE BEGINNING OF A TANGENT CURVE TO THE RIGHT HAVING A RADIUS OF 5729.58 FEET AND A CENTRAL ANGLE OF 05° 54' 40"; THENCE ALONG THE ARC OF SAID CURVE, 591.11 FEET; THENCE SOUTH 42° 16' 10" WEST, 1422.50 FEET TO THE POINT OF BEGINNING.

EXCEPTING THEREFROM THAT PORTION THEREOF DESCRIBED IN THE FINAL ORDER OF CONDEMNATION, CASE NO. SM 113 299 BY THE SUPERIOR COURT OF THE STATE OF CALIFORNIA FOR THE COUNTY OF SANTA BARBARA, RECORDED DECEMBER 11, 2000 AS INSTRUMENT NO. 2000-0077911 OF OFFICIAL RECORDS.

ALSO EXCEPTING THEREFROM THOSE PORTIONS OF SAID LAND AS CONVEYED TO THE STATE OF CALIFORNIA BY GRANT DEED RECORDED APRIL 21, 2004 AS INSTRUMENT NO. 2004-0040574 OF OFFICIAL RECORDS.

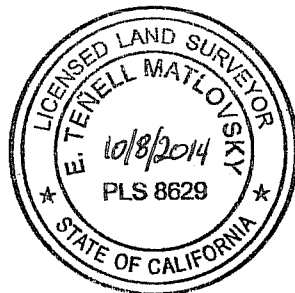

APPROVED AS TO FORM  
AND SURVEY CONTENT

E. Tenell Matlovsky  
Deputy  
COUNTY SURVEYOR  
LICENSE EXP. 12/31/2015

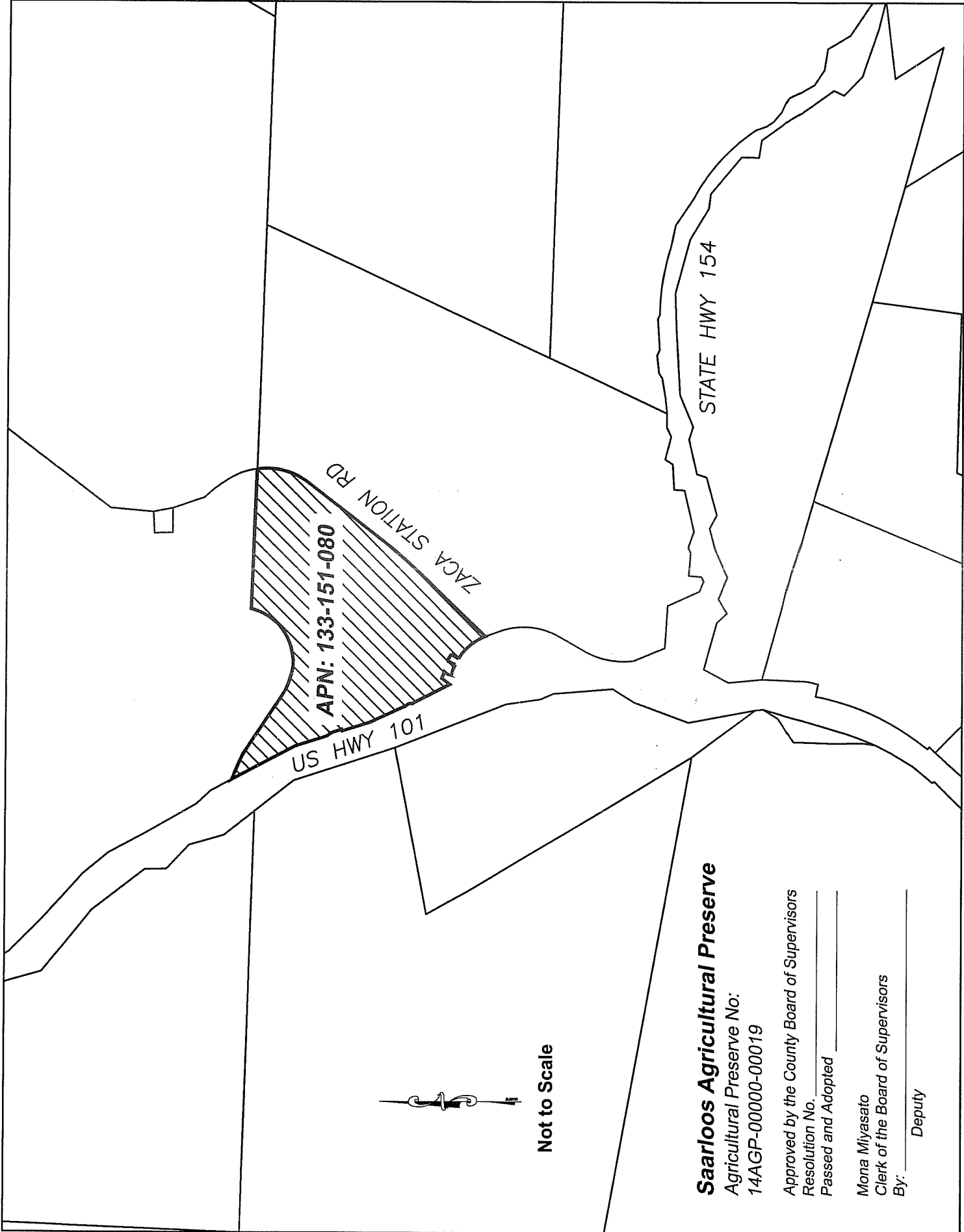

**Saarloos Agricultural Preserve**

Agricultural Preserve No:

14AGP-00000-00019

Approved by the County Board of Supervisors

Resolution No. \_\_\_\_\_

Passed and Adopted \_\_\_\_\_

Mona Miyasato

Clerk of the Board of Supervisors

By: \_\_\_\_\_

Deputy