

Exhibit A

15AGP-00000-00018

Being all that portion of the South one-half of the Northeast one-quarter of Section 12, Township 9 North, Range 33 West, San Bernardino Meridian, in the County of Santa Barbara, State of California, according to the official plat thereof, lying Southwesterly of the Northeasterly line of the Pacific Coast Railway Company right-of-way, together with;

All of the Southeast one-quarter of Section 12 of said Township and Range lying southerly of the southerly right of way of the Pacific Coast Railway, EXCEPTING THEREFROM, the Southeast one-quarter of the Southeast one-quarter of said Section 12, also EXCEPTING THEREFROM that portion condemned for public school purposes in the Final Order of Condemnation recorded August 7, 1951 in Book 1008, Page 276, Official Records of said County and State, more particularly described as follows:

- Commencing at the Southeast corner of said Section 12; thence, N00°19'50"E, along the east line of said Section 12, 660.43 feet to the Northeast corner of the Southeast one-quarter of the Southeast one-quarter of the Southeast one-quarter; thence, N89°44'20"W, 25.00 feet to the TRUE POINT OF BEGINNING; thence,
- 1) N89°44'20"W, continuing along the northerly line of the Southeast one-quarter of the Southeast one-quarter, 634.81 feet to an old 4" x 4" stake set at the Northwest corner of said Southeast one-quarter of the Southeast one-quarter of the Southeast one-quarter; thence,
 - 2) S00°22'20"W, along the westerly line of said Southeast one-quarter of the Southeast one-quarter of the Southeast one-quarter 164.00 feet to a ¾" iron pipe; thence,
 - 3) N56°50'40"W, 286.46 feet to a ¾" iron pipe; thence,
 - 4) N44°02'40"W, 260.69 feet to a ¾" iron pipe; thence,
 - 5) N37°31'40"E, 521.68 feet to a ¾" iron pipe set in the southerly line of the present public road; thence,
 - 6) S52°28'20"E along said southerly line, 932.20 feet to a ¾" iron pipe set at an angle point in said public road; thence,
 - 7) S00°19'50"W, 28.79 feet to the point of beginning

TOGETHER WITH all of Section 13 of said Township and Range,

TOGETHER WITH all that portion of the East ¾ of the East ½ of Section 23 of said Township and Range, EXCEPTING THEREFROM all that portion described in the Deed to the County of Santa Barbara recorded May 9, 1934 in Book 299, Page 234 of Official Records of said County and State,

TOGETHER WITH all of Section 24 of said Township and Range, EXCEPTING THEREFROM any interest therein conveyed to the Union Oil Company of

California by Deed dated March 30, 1949, and recorded April 23, 1949, in Book 850 at Page 99 of Official Records of said County and State.

End of Description

APPROVED AS TO FORM
AND SURVEY CONTENT

A. Jevremovic

COUNTY SURVEYOR
LICENSE EXP. 12/31/2015

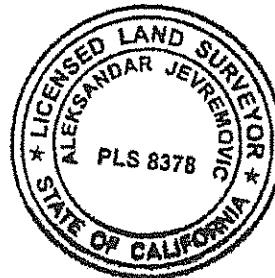

10/28/2015

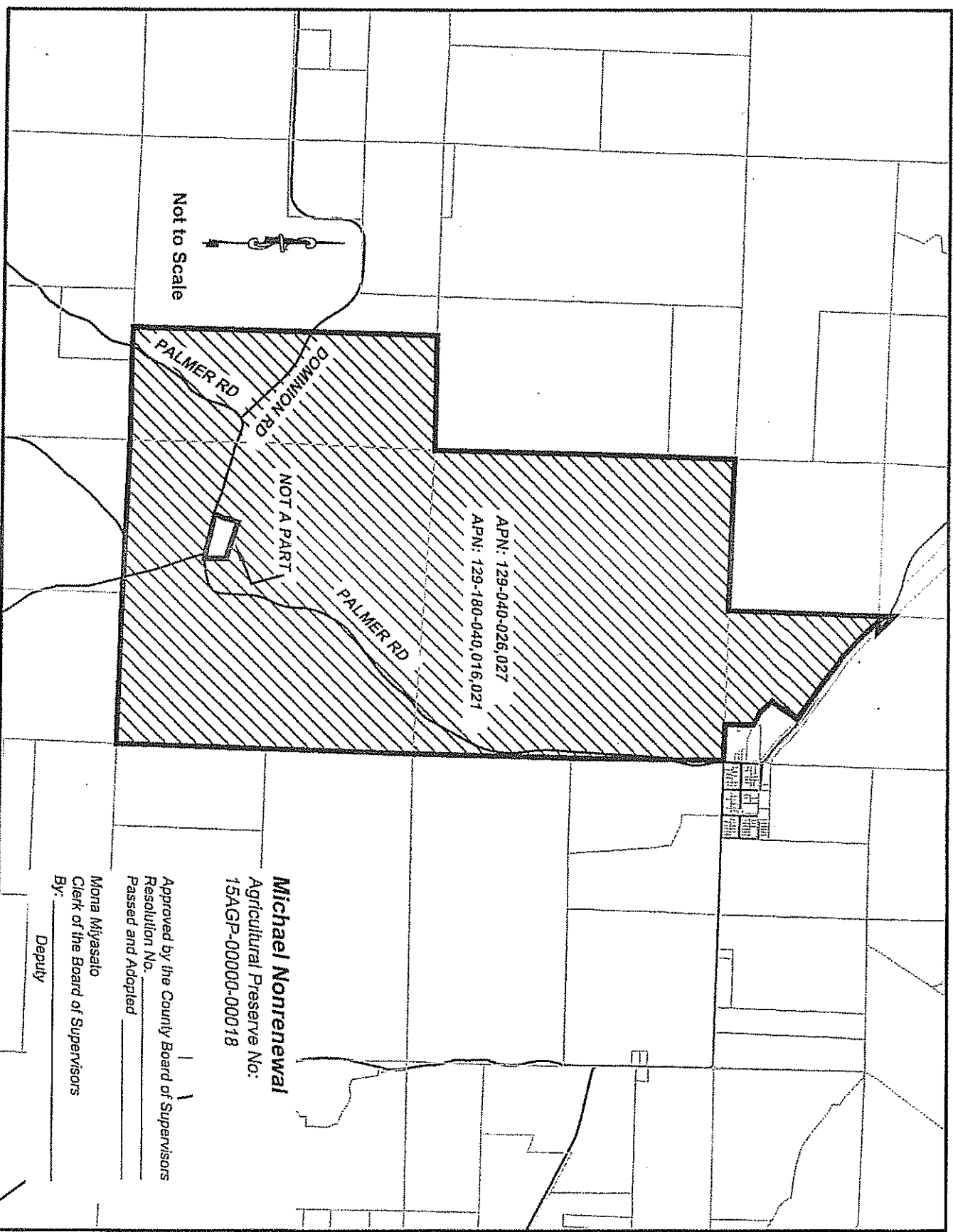

Michael Nonrenewal
Agricultural Preserve No:
15AGP-00000-00018

Approved by the County Board of Supervisors
Resolution No. _____
Passed and Adopted _____

Mona Miyasato
Clerk of the Board of Supervisors
By: _____
Deputy