

EXHIBIT A

Legal Description

for

15AGP-00000-00020

THAT PORTION OF TRACT 9 OF RANCHO TINAQUAIC, IN THE COUNTY OF SANTA BARBARA, STATE OF CALIFORNIA, AS SAID TRACT IS SHOWN ON THE PLAT OF PARTITION SURVEY OF SAID RANCHO, ANNEXED TO AND MADE A PART OF THE FINAL DECREE OF PARTITION IN THE MATTER OF THE ESTATE OF WILLIAM DOMINGO FOXEN, DECEASED, MADE AND ENTERED IN PROBATE COURT OF SAID COUNTY OF SANTA BARBARA, ON MARCH 20, 1875, A CERTIFIED COPY OF WHICH DECREE WAS RECORDED IN BOOK "O" OF DEEDS, PAGES 209 TO 213 INCLUSIVE, IN THE OFFICE OF THE COUNTY RECORDER OF SAID COUNTY, WHICH LIES NORTHEASTERLY OF A LINE DRAWN FROM A POINT ON THE NORTHWESTERLY LINE OF SAID TRACT 9, DISTANT THEREON 105.65 CHAINS SOUTHWESTERLY FROM THE MOST NORTHERLY CORNER OF SAID TRACT, SOUTHEASTERLY TO INTERSECT THE SOUTHEASTERLY BOUNDARY LINE OF SAID TRACT 9 AT A POINT DISTANT THEREON SOUTHWESTERLY 105.65 CHAINS FROM THE NORTHEAST CORNER OF SAID TRACT 9.

APPROVED AS TO FORM
AND SURVEY CONTENT

A. J. Jaramon

COUNTY SURVEYOR
LICENSE EXP. 12/31/2015

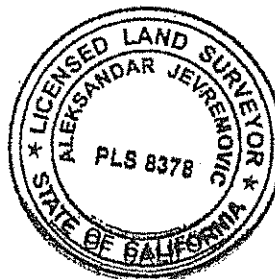

10/28/2015

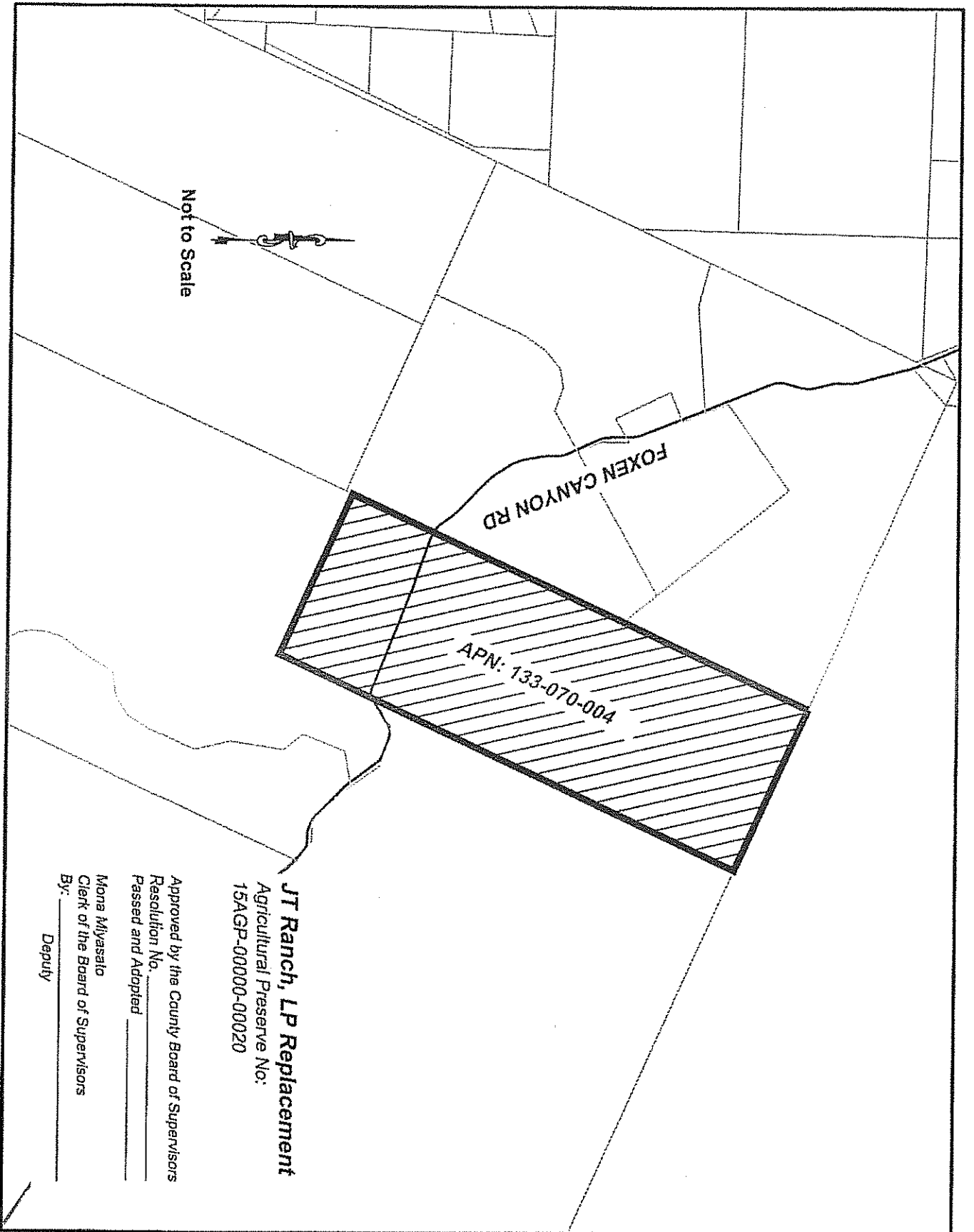

JT Ranch, LP Replacement

Agricultural Preserve No:

15AGP-00000-00020

Approved by the County Board of Supervisors

Resolution No. _____

Passed and Adopted _____

Mona Miyasato

Clerk of the Board of Supervisors

By: _____

Deputy