

Exhibit A

16AGP-00000-000 25

Agricultural Preserve Legal Description

Parcel B and C of Parcel Map No, 13,528, in the County of Santa Barbara, State of California, as per the map of the same filed in Book 35, Pages 71 through 74 of Parcel Maps in the office of the County Recorder of said County and State.

End of Description

This Description was prepared by me or under my direction in conformance with the requirements of the Professional Land Surveyor's Act this 9th day of September, 2016

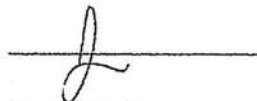

Jon McKellar
PLS 7578

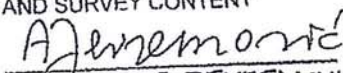

APPROVED AS TO FORM
AND SURVEY CONTENT

ALEKSANDAR JEVREMOVIC
COUNTY SURVEYOR
LICENSE EXP. 12/31/2017

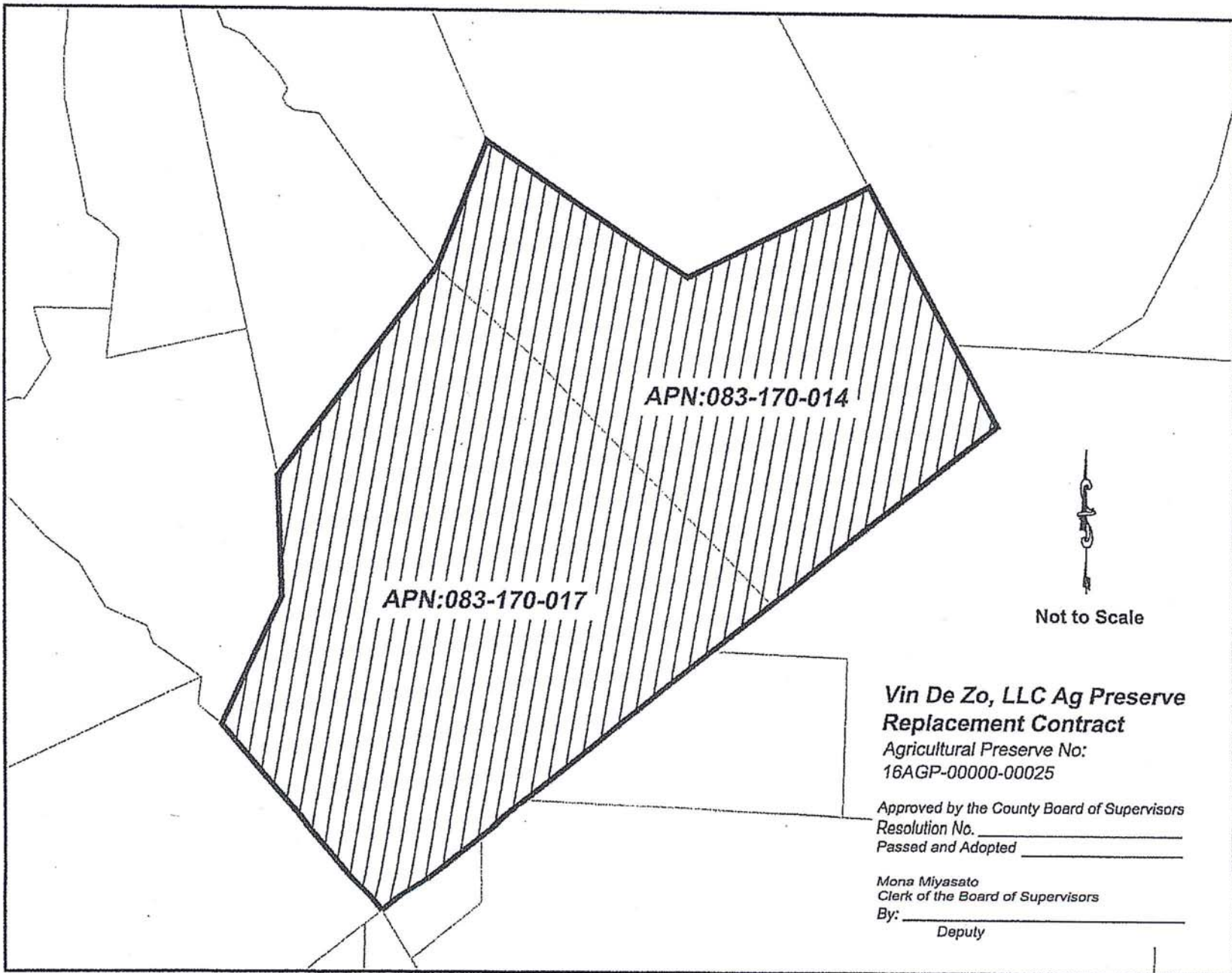
11/10/2016



**Vin De Zo, LLC Ag Preserve
Replacement Contract**

Agricultural Preserve No:
16AGP-00000-00025

Approved by the County Board of Supervisors
Resolution No. _____
Passed and Adopted _____

Mona Miyasato
Clerk of the Board of Supervisors

By: _____
Deputy