

COUNTY OF SANTA BARBARA
STATE OF CALIFORNIA
DEPARTMENT OF PUBLIC WORKS

PLANS FOR THE CONSTRUCTION OF
**FLORADALE AVE BRIDGE No. 51C-0370
OVER SANTA YNEZ RIVER**

REPLACING EXISTING BRIDGE No. 51C-0006
APPROXIMATELY 0.75 MI. NORTH OF CENTRAL AVENUE NEAR THE CITY OF LOMPOC
FEDERAL PROJECT NO. BRLSZD-5951(060)
COUNTY PROJECT NO. 862032

TO BE SUPPLEMENTED BY THE STATE OF CALIFORNIA
DEPARTMENT OF TRANSPORTATION STANDARD PLANS
AND SPECIFICATIONS DATED 2018 (UNLESS
INDICATED OTHERWISE)

APPROVED - CHAIR, BOARD OF SUPERVISORS _____ DATE

Scott H. [Signature] 12/7/2020
APPROVED - DIRECTOR OF PUBLIC WORKS _____ DATE

Walter Ribolava 12/4/2020
APPROVAL RECOMMENDED - ENGINEERING SECTION MANAGER _____ DATE

INDEX TO ROADWAY PLANS

| SHEET NO. | SHEET ID | DESCRIPTION |
|-----------|----------|-------------------------------------|
| 1 | T | TITLE SHEET |
| 2 | T | ROADWAY CONSTRUCTION NOTES & LEGEND |
| 3-4 | X | TYPICAL SECTIONS |
| 5-7 | DM | DEMOLITION PLAN |
| 8-13 | HC | HORIZONTAL CONTROL |
| 14-17 | PP | PLAN AND PROFILE |
| 18 | SE | SUPERELEVATION DIAGRAM |
| 19-23 | CD | CONSTRUCTION DETAILS |
| 24-26 | GR | GRADING PLAN |
| 27-28 | CG | CONTOUR GRADING PLAN |
| 29-31 | PD | PAVEMENT DELINEATION |
| 32-37 | SC | STAGE CONSTRUCTION |
| 38-40 | U | COMPOSITE UTILITY PLAN |
| 41-43 | EC | EROSION CONTROL |

INDEX TO STRUCTURE PLANS

| SHEET NO. | DESCRIPTION |
|-----------|--|
| 44-45 | GENERAL PLAN |
| 46 | DECK CONTOURS |
| 47 | FOUNDATION PLAN |
| 48 | ABUTMENT LAYOUT |
| 49-50 | ABUTMENT DETAILS |
| 51 | BEARING ASSEMBLY DETAILS |
| 52 | PIER LAYOUT |
| 53-54 | PIER DETAILS |
| 55 | TYPICAL SECTION |
| 56-57 | GIRDER LAYOUT |
| 58-59 | ADDITIONAL REINFORCEMENT |
| 60-61 | JOINT SEAL ASSEMBLY DETAILS |
| 62 | STRUCTURE APPROACH SLAB DETAILS |
| 63 | STRUCTURE APPROACH SLAB DRAINAGE DETAILS |
| 64 | ARCHITECTURAL DETAILS |
| 65 | TUBULAR BICYCLE RAILING DETAILS |
| 66 | BRIDGE DEMOLITION PLAN |
| 67-71 | LOG OF TEST BORINGS |

BASIS OF BEARING
Bearings shown on this map are referenced to the California Coordinate System Zone 5 Grid, NAD83(1998) Epoch 2000.35 defined locally by the City of Lompoc control network as shown on the record of survey filed in Book 172, pages 4-7, of the Santa Barbara County Surveyor. This survey tied to stations vndp, ores, 46, and 50 of the network.

All distances and coordinates are referenced to California Coordinate System Zone 5 Grid NAD83(1998) Epoch 2000.35, and are expressed in US survey foot units.

The site combination factor is 0.99992511 and the site mapping angle is -1°25'15.34", both calculated at found monument "201". To obtain ground level distances, multiply grid distances by 1.000074896, which is the inverse of the site combination factor. To obtain true north azimuths, subtract the mapping angle from the grid azimuths.

VERTICAL DATUM
Elevations have been determined using geoid modeling, are expressed in US survey feet and are referenced to the National Geodetic Vertical Datum of 1929 (NGVD29) defined locally by found point "210", also being Lompoc GIS control network station 50. The elevation at the ground reference mark is 67.21 feet.

Combined factors are the product of the elevation factor times the CCS83 scale factor. Elevation factors were computed using a value of 20,906,000 feet as the radius of curvature of the earth and the geoid model at the station. The geoid height was interpolated from the NGS geoid12b geoid model.



**Know what's below.
Call before you dig.**
Contractor must call Underground Service Alert at 811 two working days prior to excavation

UNDERGROUND FACILITIES SHOWN WERE LOCATED BASED ON INFORMATION PROVIDED BY UTILITY COMPANIES AND BY MEASURING SURFACE FEATURES. NO ATTEMPT WAS MADE TO LOCATE OTHER UNDERGROUND FACILITIES THAT WERE NOT READILY APPARENT FROM A VISUAL INSPECTION OF SURFACE FEATURES.

CONTRACTOR MUST VERIFY ACTUAL DEPTH AND LOCATION OF ALL EXISTING UTILITIES PRIOR TO CONSTRUCTION...CALL "UNDERGROUND SERVICE ALERT" (U.S.A.) PRIOR TO TRENCHING, GRADING, EXCAVATION, DRILLING, PIPE PUSHING, PLANTING TREES, DIGGING POST HOLES FOR FENCES, ETC. U.S.A. WILL SUPPLY INFORMATION OR LOCATE AND MARK ANY UNDERGROUND FACILITIES.

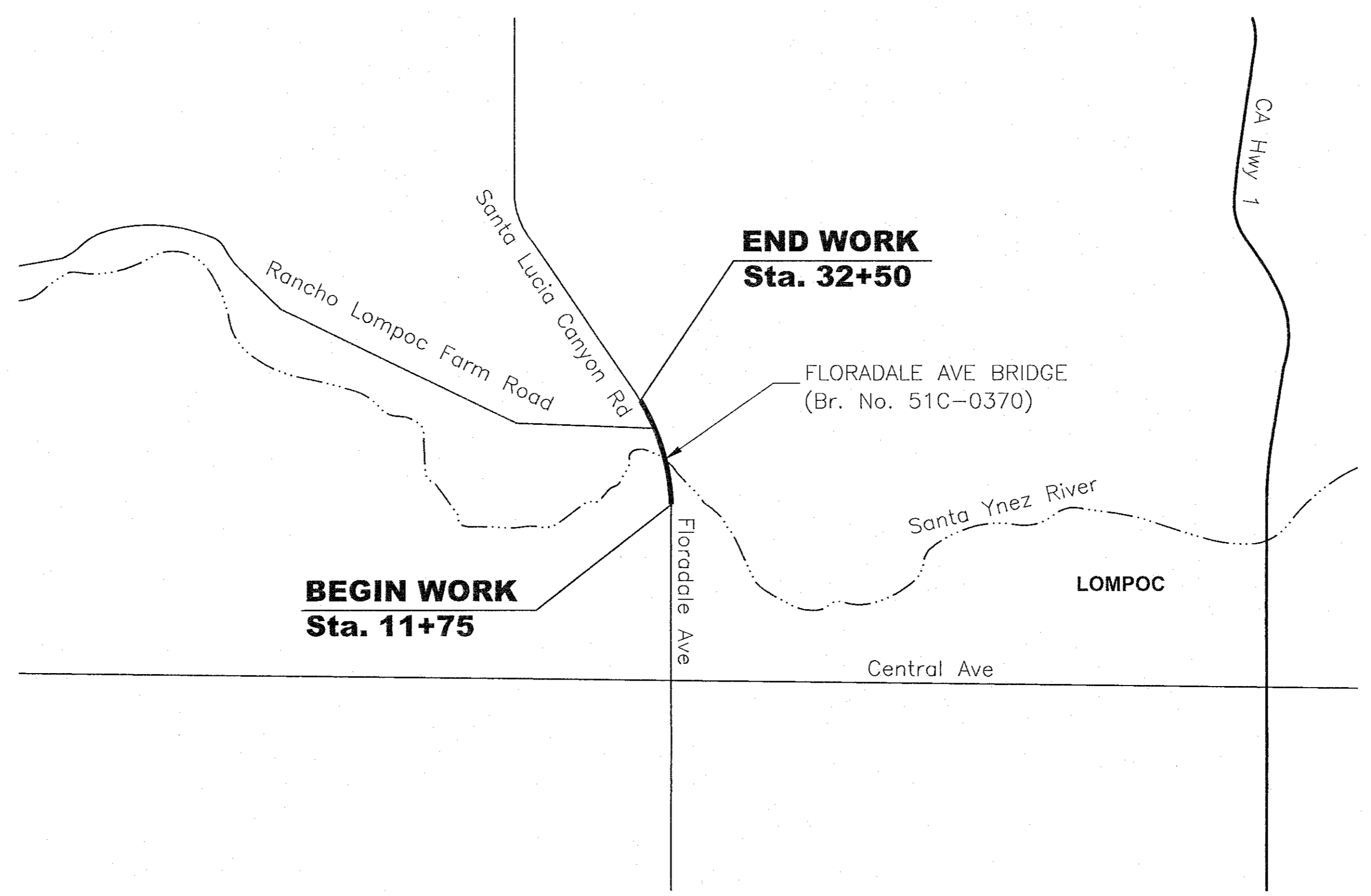

VICINITY MAP

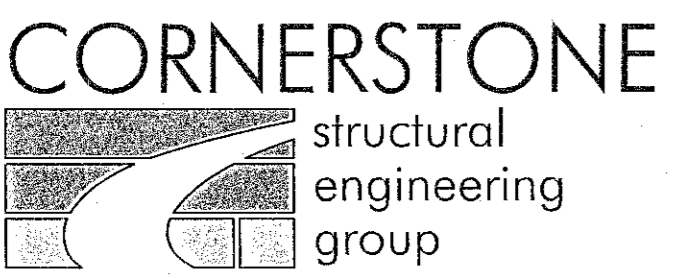

986 W Alluvial Ave - Suite 201
Fresno, California 93711
559.320.3200
fax 559.320.3201



COUNTY OF SANTA BARBARA
DEPARTMENT OF PUBLIC WORKS
TRANSPORTATION DIVISION

DESIGN BY: M. Weaver
CHECKED BY: J. Jensen
DRAWN BY: T. Eaton
CONSTRUCTABILITY REVIEW BY: P. Gaston

SCALE: NTS
PROJECT NO.: 862032

FLORADALE AVENUE
BRIDGE NO. 51C-0370
SANTA YNEZ RIVER

SHEET NO. 1 OF 71
FILE NO. 2017040T1

DISREGARD PRINTS BEARING EARLIER REVISION DATES

FOR REDUCED PLANS ORIGINAL SCALE IN INCHES 0 1 2 3

TITLE SHEET
T-1

COUNTY OF SANTA BARBARA
 DEPARTMENT OF PUBLIC WORKS
 TRANSPORTATION DIVISION
 FLORADALE AVENUE BRIDGE NO. 51C-0370 OVER SANTA YNEZ RIVER
 FEDERAL PROJECT NO. BRLSZD-5951(060)
 COUNTY PROJECT NO. 862032